

Dimensions in mm

Discontinued ●

Discontinued when stock = 0 +



- **A Screw**
- For fixing top section **B** through cabinet base
- Black plastic

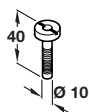

A Screw

Cat. No.	637.65.990
----------	------------

Packing: 1 pc



- **B Top section, screw through mounting**
- For screw fixing through cabinet base
- Black plastic
- Order screw **A** separately

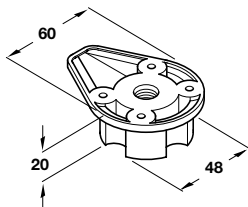

B Top section, screw through mounting

Cat. No.	637.65.300
----------	------------

Packing: 1 pc



- **C Top section, screw mounting**
- For screw fixing to underside of cabinet base
- Black plastic

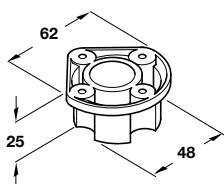

C Top section, screw mounting

Cat. No.	637.65.301
----------	------------

Packing: 1 pc



- **D Top section, screw mounting**
- With extended plate for corner fixing
- For screw fixing to underside of cabinet base
- Black plastic

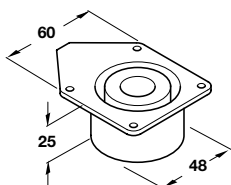

D Top section, screw mounting

Cat. No.	637.65.302
----------	------------

Packing: 1 pc



- **E Top section, dowel mounting**
- With Ø 10 mm dowel for fixing to underside of cabinet base
- Black plastic

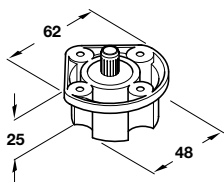

E Top section, dowel mounting

Cat. No.	● 637.65.303
----------	-------------------------

Packing: 1 pc



- **F Top section, dowel mounting**
- With extended plate for corner fixing
- With Ø 10 mm dowel for fixing to underside of cabinet base
- Black plastic

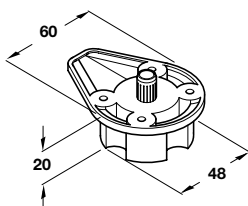

F Top section, dowel mounting

Cat. No.	● 637.65.304
----------	-------------------------

Packing: 1 pc



- **G Top section, dowel mounting**
- With Ø 10 mm spreading dowel for fixing to underside of cabinet base
- Black plastic

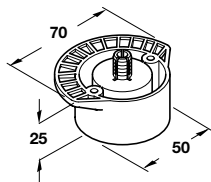

G Top section, dowel mounting

Cat. No.	637.65.305
----------	------------

Packing: 1 pc



- **H Top section, dowel mounting**
- With Ø 15 mm spreading dowel for fixing to underside of cabinet base
- Black plastic

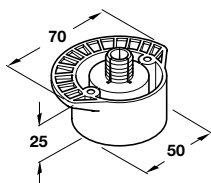

H Top section, dowel mounting

Cat. No.	637.65.306
----------	------------

Packing: 1 pc

We reserve the right to alter specifications without notice.

07.07.06/1