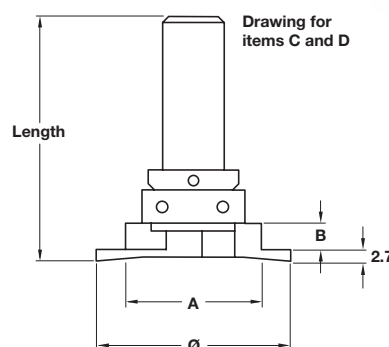



Photo shows door gripper being used in conjunction with the DBB morticer shown on page 227



C Router cutter

- Designed for cutting kerfs for Aquamac 21, shown on page 130 of this section
- Double rebate recess
- 1/2" shank
- Tungsten carbide tip

Length	Ø	A	B	Cat. No.
90 mm	54.5 mm	34.3 mm	10.3 mm	002.19.262

Order qty: 1 pc

D Router cutter

- Designed for cutting kerfs for Aquamac 63, shown on page 130 of this section
- Double rebate recess
- 1/2" shank
- Tungsten carbide tip

Length	Ø	A	B	Cat. No.
58 mm	36 mm	25 mm	4.8 mm	002.19.260
67 mm	41.3 mm	28.3 mm	4.8 mm	002.19.261

Order qty: 1 pc

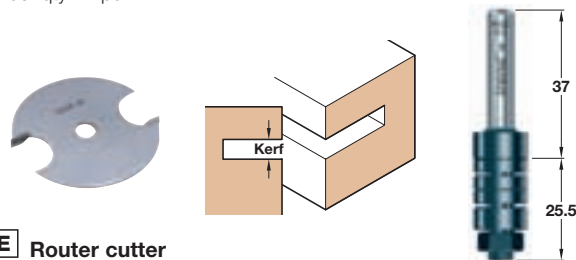

E Router cutter

- Designed for cutting kerfs for Aquamac 89, shown on page 130 of this section
- TCT slotter with 1/4" bore
- To be used with arbour 002.19.220, **must be ordered separately**
- Solid tungsten carbide
- Arbour, standard duty arbour with 1/4" spindle and spacers

Router cutter	Cat. No.
Kerf 2.5 mm, Ø 40 mm	002.19.233
Arbour	002.19.220

Order qty: 1 pc

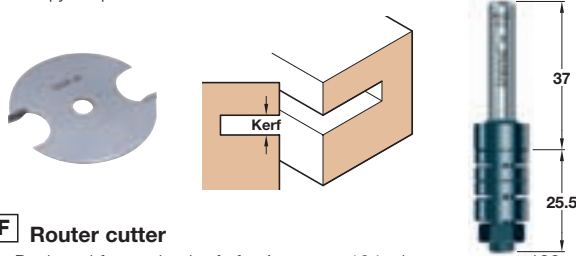

F Router cutter

- Designed for cutting kerfs for Aquamac 124, shown on page 130 of this section
- TCT slotter with 1/4" bore
- To be used with arbour 002.19.220, **must be ordered separately**
- Solid tungsten carbide
- Arbour, standard duty arbour with 1/4" spindle and spacers

Router cutter	Cat. No.
Kerf 3.0 mm, Ø 36 mm	002.19.234
Arbour	002.19.220

Order qty: 1 pc

4



Adjustable 20 - 44 mm

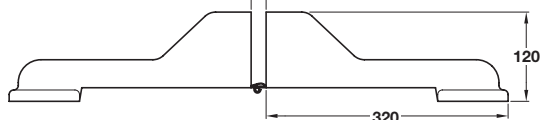

A Adjustable door gripper

- Adjustable grippers/steel straps
- Adjustable to 20 - 44 mm
- Steel straps, simple adjustment
- Clamps door securely, versatile use
- Can be used in conjunction with DBB morticer (001.67.700)
- Gives excellent support for easy door preparation
- Automatic release for ease of use
- Locates easily to achieve best results
- Black composite material

Cat. No.	008.07.290
----------	------------

Order qty: 1 pc

Square hole drilling sets allow the fast and easy drilling of square holes in a variety of materials. Especially useful when installing electrical socket and switch boxes in masonry



B Electrician's square hole drilling set

- Solid casting gives added power transmission to cutting edges
- Added power transmission improves speed and tool life, electrical box can now be in place in under 2 minutes in standard material
- Square hole cutter should not be used on hard materials. To produce the square in hard materials, use the box sinker chisel
- Capable of drilling hard and soft materials
- Sets consist of:
 - 1 x square cutter
 - 1 x round cutter (now with dust collection)
 - 1 x SDS+ box sinker chisel
 - 1 x SDS+ pilot drill
 - 1 x plastic carry case

Cat. No.	001.67.160
----------	------------

Order qty: 1 set