

**Discontinued** ●

**Discontinued when stock = 0** +

### **H** Sash handle

- One size only
- Available in 4 finishes
- Brass

Finish	Cat. No.
White epoxy powder coated	970.30.857
Polished brass	+ <del>970.30.858</del>
Polished chrome	970.30.852
Gold	970.30.855

Order qty: 1 pc (2 pcs required per window)

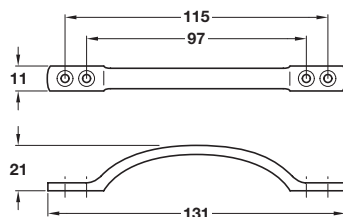

Gold finish



### **I** Ring pull

- Face fixing
- Available in 5 finishes
- Brass

Finish	Cat. No.
White epoxy powder coated	970.30.867
Polished brass	970.30.868
Polished chrome	970.30.862
Brushed stainless steel	970.30.860
Gold	970.30.865

Order qty: 1 pc

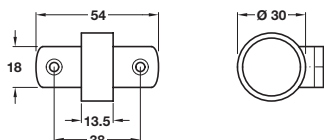

Polished chrome finish



### **J** Sash lift

- One size only, 51 mm
- Available in 5 finishes
- Steel

Finish	Cat. No.
White epoxy powder coated	970.30.877
Polished brass	● <del>970.30.878</del>
Polished chrome	970.30.872
Brushed stainless steel	970.30.870
Gold	970.30.875

Order qty: 1 pc (2 pcs required per window)

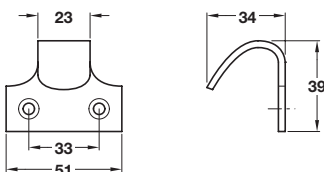

White epoxy powder coated finish



### **K** Tilt latch knob (bottom sash)

- To suit item **C**, page 15
- Available in 5 finishes
- Diecast zinc alloy

Finish	Cat. No.
White epoxy powder coated	971.00.567
Polished brass	● <del>971.00.568</del>
Polished chrome	971.00.562
Brushed stainless steel	971.00.560
Gold	971.00.565

Order qty: 1 pc (2 pcs required per window)

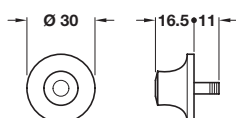

Polished brass finish



### **L** Concealed tilt latch knob (top sash)

- To suit item **C**, page 15
- Aluminium, silver anodised

Cat. No.	971.00.579
----------	------------

Order qty: 1 pc (2 pcs required per window)

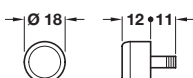

Silver anodised aluminium finish



### **M** Jamb channel

- For use with tilt system
- Available in 4 lengths and 2 finishes
- Extruded aluminium

Length	White	Brown
1372 mm (4'6")	971.00.760	971.00.770
1676 mm (5'6")	971.00.761	971.00.771
1981 mm (6'6")	+ <del>971.00.762</del>	971.00.772
2590 mm (8'6")	+ <del>971.00.763</del>	971.00.773

Order qty: 1 pc

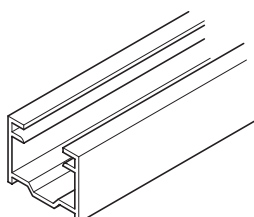
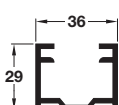

Brown finish

