

Glass shelves and shelf supports for cabinets

Clear glass shelves for mounting in cabinets, with a variety of shelf supports to suit any kitchen or cabinet. Order glass shelf length depending on shelf support used.



Illuminated glass shelves

Profiles and LED lights to illuminate glass shelves are shown in **Section 4** on page 30.



Glass shelves, for cabinets

- For use with shelf supports shown below
- 6 mm thick glass
- Clear toughened glass with polished edges

Depth:	250 mm	287.5 mm
463 +/- 1 mm width	564.98.043	564.98.243
563 +/- 1 mm width	564.98.044	564.98.244
763 +/- 1 mm width	564.98.045	564.98.245
963 +/- 1 mm width	564.98.046	564.98.246

Order qty: 1 pc

**Catalogue shows 462, 562, 762, 962 mm
Correct dimensions are 463, 563, 763 and 963 mm**

**Tolerance of +/- 1 mm added
to depth of all items**

Glass shelf support, plug in

- With twin grooves
- For Ø 5 mm hole
- Zinc alloy with transparent plastic Ø 8 mm glass support

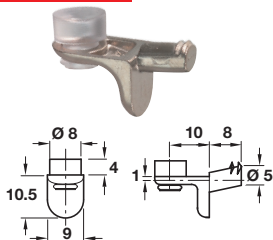

Finish	Cat. No.
Nickel-plated	282.24.730

Order qty: Multiples of 100 pcs

Discontinued

Discontinued when stock = 0

**Catalogue shows... 'Zinc plated'
Correct Finish is 'Galvanized'**

Glass shelf support, plug in

- With transparent plastic cap
- For Ø 5 mm hole
- Steel

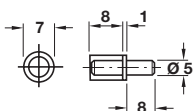

Finish	Cat. No.
Galvanized	+ 281.41.906
Galvanized	281.41.907

Order qty: Multiples of 100 pcs

**Item added
Discontinued when stock = 0
For 281.41.906 Offer alt. 281.41.907**

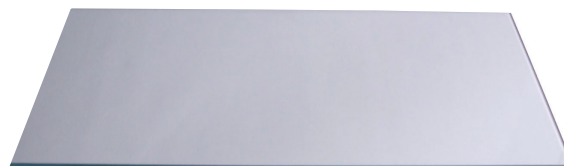

Glass shelves, for cabinets

- For use with shelf supports shown below
- 6 mm thick glass
- Clear toughened glass with polished edges

Depth:	250 mm
454 mm width	564.98.143
554 mm width	564.98.144
754 mm width	564.98.145
954 mm width	564.98.146

Order qty: 1 pc

Glass shelf support, plug in

- With safety catch to prevent unintentional lifting or tilting of shelf
- For Ø 5 mm hole
- For max. 6 mm glass thickness
- Plastic

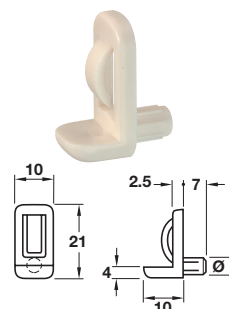

Finish	Cat. No.
Transparent	281.42.403

Order qty: Multiples of 100 pcs

Glass clamp shelf support, plug in

- Secures glass in position to prevent domestic injuries
- Conceived for rigid furniture, the carcass can be safely moved even upside down with the glass already installed
- For Ø 5 mm hole
- For 4-6 mm glass thickness
- Zinc alloy and nylon screw

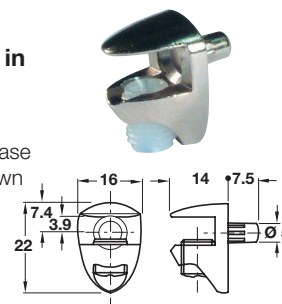

Finish	Cat. No.
Nickel-plated	284.04.601

Order qty: Multiples of 10 pcs

TCH-FF 2010, HUK. Dimensional data not binding. We reserve the right to alter specifications without notice.