

A Concealed hinges 110°

- Opening angle 110°
- Automatic closing spring
- Screw fixing
- Slide on arms
- Nickel-plated steel

Drilling dimensions for cup fixing
Drilling pattern 45/9.5

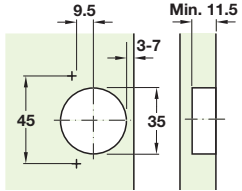

Drilling dimensions for cup fixing
Drilling pattern 48/6

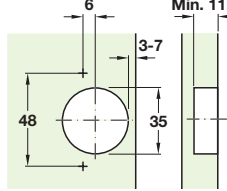

Full overlay mounting

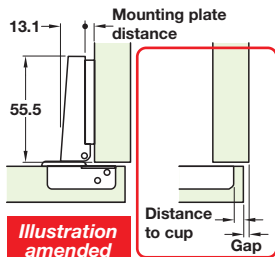

Illustration amended

Door overlay mm

12	13	14	15	16	17	18	19	20	
				3	4	5	6	7	0
		3	4	5	6	7			2
3	4	5	6	7					4
Distance to cup mm					Mounting plate distance mm				

Item & text added

Straight hinge arm

45/9.5	48/6
Nickel plated	311.90.520 311.90.500

Order qty: Multiples of 50 pcs

Half overlay/twin mounting

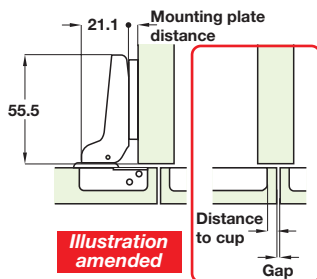

Illustration amended

Door overlay mm

4	5	6	7	8	9	10	11	12	
				3	4	5	6	7	0
		3	4	5	6	7			2
3	4	5	6	7					4
Distance to cup mm					Mounting plate distance mm				

Cranked hinge arm, 8 mm crank

Nickel-plated	Cat. No. 311.90.501
---------------	---------------------

Order qty: Multiples of 50 pcs

Inset mounting

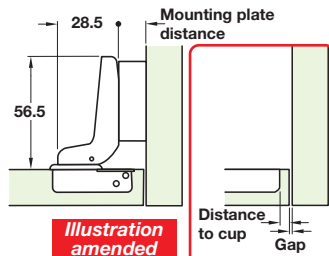

Illustration amended

Door overlay mm

3	2	1	0	-1	-2	-3	-4	-5	
				3	4	5	6	7	0
		3	4	5	6	7			2
3	4	5	6	7					4
Distance to cup mm					Mounting plate distance mm				

Cranked arm, 17 mm crank

45/9.5	48/6
Nickel-plated	311.90.522 311.90.502

Order qty: Multiples of 50 pcs

Item added

D Concealed hinges 170°

- Opening angle 170°
- Sprung
- Screw fixing
- Slide on arms
- Nickel-plated steel

Drilling dimensions for cup fixing
Drilling pattern 45/9.5

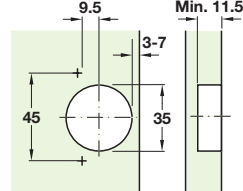

Drilling dimensions for cup fixing
Drilling pattern 48/6

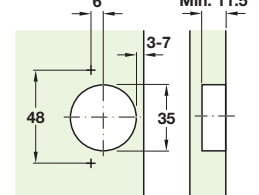

Full overlay

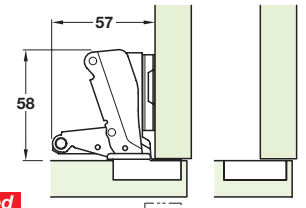

Mounting dimensions added

Door overlay mm

12	13	14	15	16	17	18	19	20	
				3	4	5	6	7	0
		3	4	5	6	7			2
3	4	5	6	7					4
Distance to cup mm					Mounting plate distance mm				

0 mm crank

45/9.5	48/6
Nickel-plated	311.93.510 311.93.500

Order qty: Multiples of 50 pcs

Item & text added



E Cruciform mounting plate

- For slide on systems on this page only
- Hospa screw fixing
- Height adjustment ±2 mm
- Nickel-plated steel

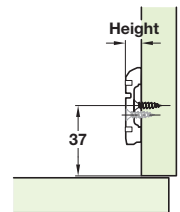

Height	Cat. No.
0 mm	311.98.500
2 mm	311.98.502
4 mm	311.98.504

Order qty: Multiples of 50 pcs



F Cruciform mounting plate

- For slide on systems on this page only
- With pre-mounted Euro screws
- Height adjustment ±2 mm
- Nickel-plated steel

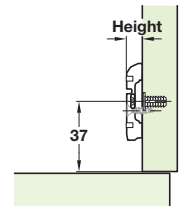

Height	Cat. No.
0 mm	311.98.510
2 mm	311.98.512
4 mm	311.98.514

Order qty: Multiples of 50 pcs