

Fittings for Sliding Folding Timber Partition Doors

Twin-Fold Two Door Folding Door Fittings

- **Application:** Inset folding door system for built in light-duty storage units where maximum access is required. Not suitable for rebated head or cill. For cupboards, wardrobes, recesses etc.
Hung in pairs, only 2, 4, 6 or 8 door leaves per opening

- **Range:** Max. door weight **15 kg**
Max. door height **2400 mm**
Max. door width **450 mm**
Door thickness **20-35 mm**

- **Fixing:** Top track soffit fixed.
All fittings concealed from outside
Lateral and vertical adjustment with pivots
- Twin-fold fitting set for 2 doors up to 900 mm overall opening width
- Twin-fold fitting set for 4 doors up to 1500 mm overall opening width
- The following combinations of door sets may be used:
2 x 2 door sets
1 x 2 door set and 1 x 4 door set
2 x 4 door sets

Twin-fold for use with 2 doors



Twin-fold for use with 4 doors

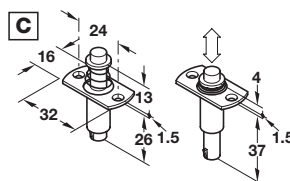
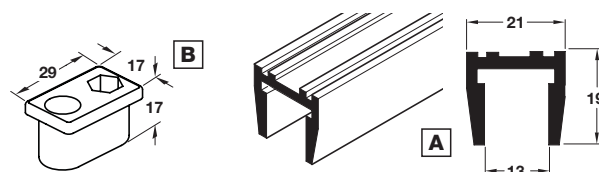
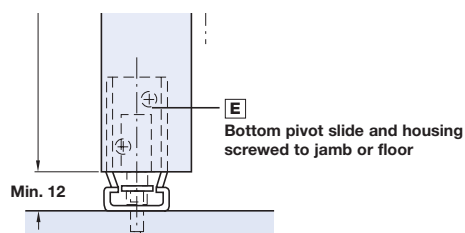
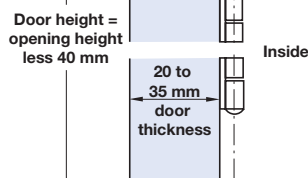
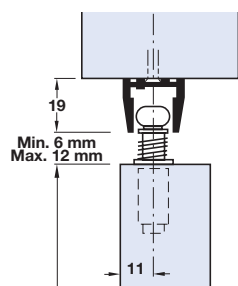
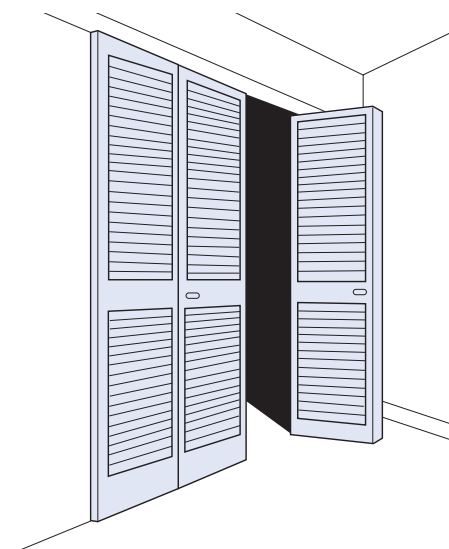

Open Depressed for track insertion

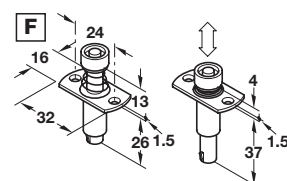
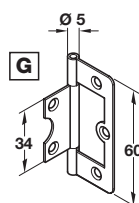

Open Depressed for track insertion

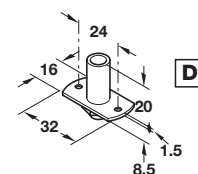
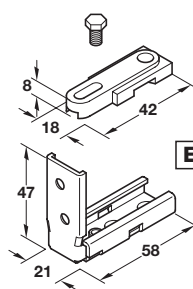

Twin-Fold fitting sets and additional tracks

Item	Description	Base material and finish	For 2 doors	For 4 doors
A Top track	decorative finish on one side	Bright aluminium	1x 930 mm length	2x 775 mm lengths
B Top pivot socket slide	adjustable	Nylon	1 pc	2 pcs
C Top pivot	spring loaded	Steel	1 pc	2 pcs
D Bottom pivot	vertically adjustable	Steel	1 pc	2 pcs
E Bottom pivot socket slide	laterally adjustable	Steel housing, nylon socket	1 pc	2 pcs
F Top roller guide	spring loaded	Steel with nylon roller	1 pc	2 pcs
G Butt hinges	other types i.e. brass available on request	Zinc-plated steel	3 pcs	6 pcs
H Accessories set	includes stop, pulls and alignment plates		1 pc	2 pcs
Cat. No.			409.10.012	409.10.021
Additional tracks			Order qty	Cat. No.
A Top track extension piece	decorative finish on one side	Bright aluminium	1x 775 mm length	409.11.019

Order 1 set per 2 or 4 door application