

BS EN 1935

4 7 6 1 1 4 0 13

Phoenix Stainless steel, fixed pin, 3 knuckle, shrouded bearing butt hinge

- Staggered hole pattern
- Grade 13 BS EN 1935
- Maximum adjusted door weight 120 kg
- Minimum door thickness 35 mm
- Square and radius corners
- Maintenance free
- 25 year performance guarantee
- Certifire approved; certificate no. CF351 mins
- Ø 5 x 30 mm wood screws included
- 3 knuckle hinge with shrouded bearings
- Grade 304 stainless steel



Length x width	102 x 76 mm	
Finish	Satin	Polished
Square corners	926.91.460	926.91.461
Radius corners	926.91.470	926.91.471

Order qty: 1 pc

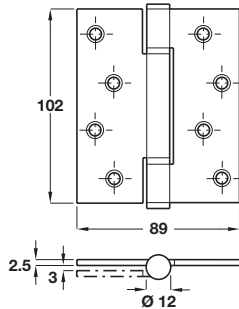

Stainless steel, fixed pin, 3 knuckle, shrouded bearing butt hinge

- Staggered hole pattern
- Maximum adjusted door weight 100 kg
- Minimum door thickness 44 mm
- Square and radius corners
- Maintenance free
- 25 year performance guarantee
- Ø 5 x 30 mm wood screws included
- 3 knuckle hinge with shrouded bearings
- Grade 304 stainless steel



Length x width	102 x 89 mm	
Finish	Satin	Polished
Square corners	926.91.480	926.91.481
Radius corners	926.91.490	-

Order qty: 1 pc

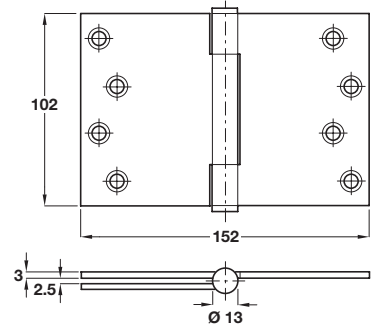

Phoenix Stainless steel, 3 knuckle, traditional bearing, projection hinge

- Staggered hole pattern
- Max. adjusted door weight 100 kg (in-house tested)
- Minimum door thickness 44 mm
- Maximum clearance 80 mm
- Square corners
- Maintenance free
- 25 year performance guarantee
- Ø 5.5 x 30 mm wood screws included
- 3 knuckle hinge with traditional bearings
- Grade 304 stainless steel



Length x width	102 x 152 mm
Finish	Satin
Square corners	926.91.640

Order qty: 1 pc



Butt hinges for cabinets are shown in Section 8 pages 86-90

TCH 2013. © Häfele U.K. Ltd 2013. Dimensional data not binding. We reserve the right to alter specifications without notice.