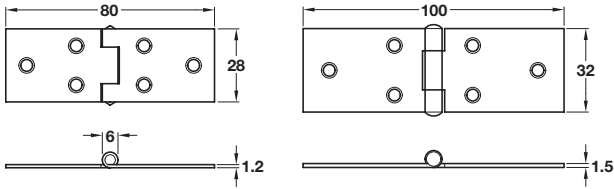
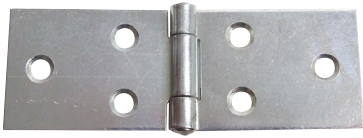

**Table hinge**



- > For table flaps or cabinet door front flaps
- > Galvanized steel
- > Order qty: 1 pc

Height x Width	Cat. No.
28 x 80 mm	354.31.931
32 x 100 mm	354.31.940

**Horizontal hinge**

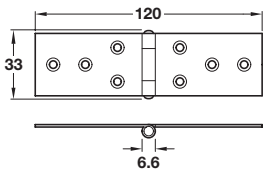
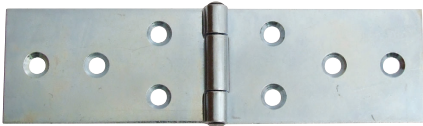

- > For inset doors
- > In compliance with DIN 7957
- > Steel
- > Order qty: Multiples of 100 pcs



Finish	Cat. No.
Galvanized	354.31.959

**Kirkpatrick Decorative hinge**

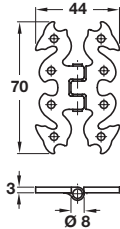

- > Due to the manufacturing process of Kirkpatrick products there is a ±5 mm tolerance on dimensions shown
- > Malleable iron
- > Order qty: 1 pair



Finish	Cat. No.
Black powder coated	119.72.300

**Kirkpatrick Cabinet strap hinge**

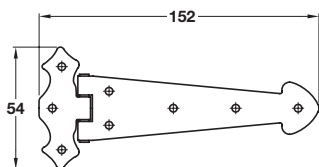

- > Due to the manufacturing process of Kirkpatrick products there is a ±5 mm tolerance on dimensions shown
- > Malleable iron
- > Order qty: 1 pair



Finish	Cat. No.
Black powder coated	119.53.310

PAGE AMENDED  
27.10.14/1