

Minilock 40 rim lock

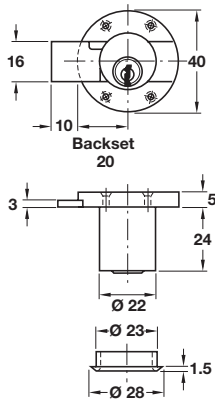

Right hand version



- > With Ø 22 mm cylinder
- > Backset: 20 mm
- > Screw fixing
- > Left handed, right handed or for drawer use
- > 5 pairs of pin tumblers = 20,000 possible key changes
- > Matt nickel-plated zinc alloy case
- > Matt nickel-plated brass cylinder
- > Accessories: 2x keys and 1x cylinder rosette
- > Order qty: 1 pc



Version	Left	Right	Drawer
Random key changes			
	230.19.614	230.19.605	230.19.623
Keyed alike: Key change			
H1	230.19.810	230.19.712	230.19.918
			Cat. No.
With master key system			230.19.698
With general master key system			230.19.699



> Spacer plates are available separately if required

Minilock 40 rim lock



Right hand version

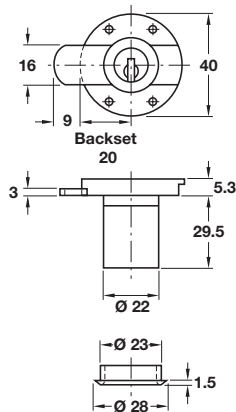

- > With Ø 22 mm Kaba® 8 cylinder
- > Backset: 20 mm
- > Screw fixing
- > Left handed, right handed or for drawer use
- > 8 pairs of pin tumblers = 100,000 possible key changes
- > Matt nickel-plated zinc alloy case
- > Matt nickel-plated brass cylinder
- > Accessories: 2x keys and 1x cylinder rosette
- > Order qty: 1 pc



Version	Left	Right	Drawer
Random key changes			
	230.13.612	230.13.603	230.13.621
Keyed alike: Key change			
K1	230.13.818	230.13.710	230.13.916
			Cat. No.
With master key system			230.13.698
With general master key system			230.13.699



> Spacer plates are available separately if required

Minilock 40 spacer plate

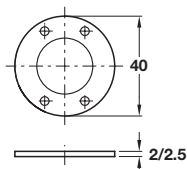
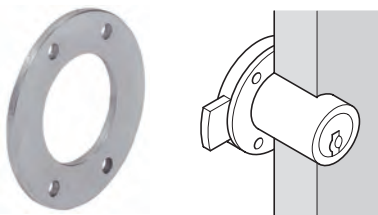

- > Two sizes for Ø 18 mm or Ø 22 mm cylinders
- > Steel or plastic
- > Order qty: Multiples of 10 pcs

For Ø 18 mm cylinder	Cat. No.
Light grey plastic, 2.5 mm thick	230.07.990
For Ø 22 mm cylinder	Cat. No.
Nickel-plated steel, 2.0 mm thick	230.13.998



> A guide to master key and general master key systems is shown on page 177
 > Strike plates are shown on pages 246-248
 > Hospa screws are shown on pages 388-393, 402