

INLAID CYLINDER FLAP LOCKS

Rondell inlaid cylinder flap lock

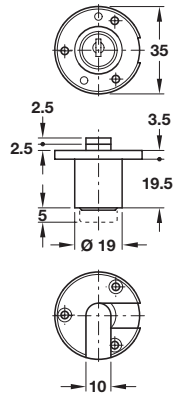

- > With \varnothing 19 mm cylinder
- > With key trap; key can only be removed in locked position
- > 5 plate levers = 200 possible key changes
- > Matt nickel-plated or gold coloured zinc alloy case and cylinder
- > Accessories: 2x keys
- > Order qty: 1 pc



Finish	Cat. No.
Random key changes	
Matt nickel-plated	219.27.051
Gold coloured	219.27.551
Keyed alike: Key change FH1	
Matt nickel-plated	219.27.006
Gold coloured	219.27.506



> Order cylinder rosette and angled strike plate separately, shown on pages **246-249**

Rondell inlaid cylinder flap lock

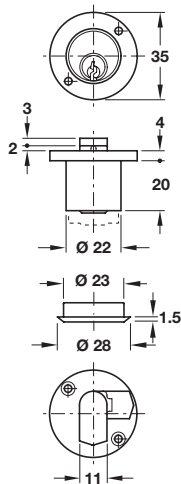

- > With \varnothing 22 mm cylinder
- > With key trap; key can only be removed in locked position
- > 5 pin tumblers = 20,000 possible key changes
- > Matt nickel-plated zinc alloy case
- > Matt nickel-plated brass cylinder
- > Accessories: 2x keys and 1x cylinder rosette
- > Order qty: 1 pc



Key type	Cat. No.
Random key changes	219.19.602
Keyed alike: Key change H1	219.19.611
With master key system	219.19.698
With general master key system	219.19.699



> Order angles strike plate separately, shown on pages **246-247**



> Master and general master key systems: Please discuss with our sales staff before ordering

COMPONENTS, FIXINGS AND CONSUMABLES 2014, © Hafele U.K. Ltd 2014. Dimensional data not binding. We reserve the right to alter specifications without notice.