

PLUG IN SHELF SUPPORTS FOR GLASS

Two-part shelf support with tightening element that holds the shelf in position and prevents tipping.



After the shelf support has been tightened in the side panel the glass shelf is put into place



...then the tightening element is inserted.

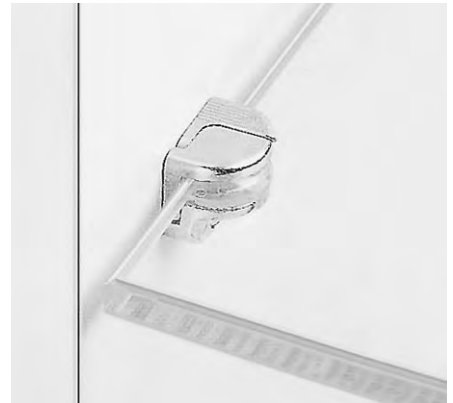

Pressing down on the tightening element fixes the glass shelf in position. The shelf support prevents it from tipping as well as being unintentionally lifted and removed.



> Screw fixing version also available, shown on page 15

Clamping shelf support, plug in, for glass shelves

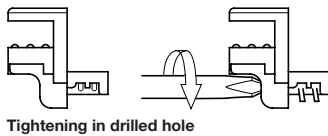
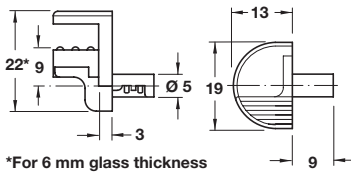

- > For Ø 5 mm hole
- > For 6/8/10 mm glass thickness
- > Zinc alloy with transparent plastic glass support
- > Order qty: Multiples of 10 pcs

Finish
Nickel-plated

Cat. No.
282.13.711

Clamping shelf support, plug in, for glass shelves

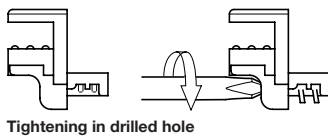
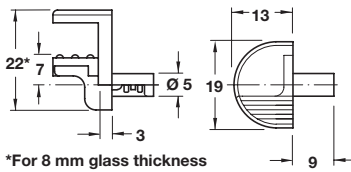

- > For Ø 5 mm hole
- > For 8/10/12 mm glass thickness
- > Zinc alloy with transparent plastic glass support
- > Order qty: Multiples of 10 pcs

Finish
Nickel-plated

Cat. No.
282.13.712