

ZIPBOLT WORKTOP CONNECTORS

Zipbolt worktop connector

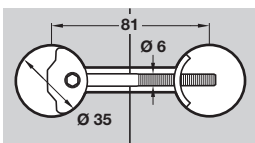

Shaft centre calculation

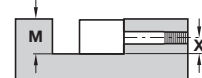

M = Minimum bore depth 20 mm
X = Shaft centre 10 mm

- > Suits standard jigs
- > Requires 5 mm Hex driver bit 006.37.030 for tensioning
- > Zinc plated steel
- > Order qty: 1 pc

Length	Cat. No.
81 mm	262.96.800

Zipbolt worktop connector

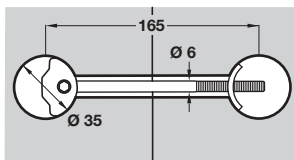

Shaft centre calculation

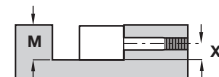

M = Minimum bore depth 20 mm
X = Shaft centre 10 mm

- > Suits standard jigs
- > Requires 5 mm Hex driver bit 006.37.030 for tensioning
- > Zinc plated steel
- > Order qty: 1 pc

Length	Cat. No.
165 mm	262.96.804

Zipbolt worktop connector

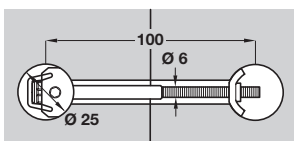

Shaft centre calculation

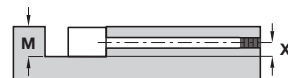

M = Minimum bore depth 12.5 mm
X = Shaft centre 10 mm

- > For 16-25 mm boards
- > Balances on driver
- > Requires 4 mm Hex driver bit 006.37.012 for tensioning
- > Zinc plated steel
- > Order qty: 1 pc

Length	Cat. No.
100 mm	262.96.802



- > Hex driver bits for tensioning Zipbolts are shown on page **382**
- > Jigs and cutting tools are shown on pages **381-382**