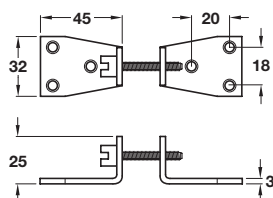
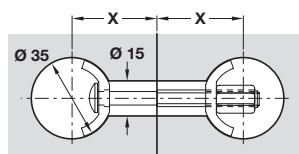
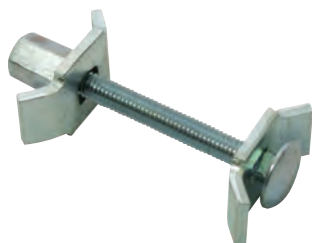

Worktop connecting bolt

- > Eliminate the need for surface mounted worktop joining strips
- > Comprises:
 - 1x bolt
 - 2x wings
- > Galvanized steel
- > Order qty: Multiples of 10 pcs

Finish	Cat. No.
Galvanized	262.96.990

Worktop connecting bolt

- > Eliminate the need for surface mounted worktop joining strips
- > Comprises:
 - 1x bolt for 65 or 150 mm installation
 - 2x curved caps
 - 1x tightening nut
- > Galvanized steel
- > Order qty: Multiples of 50 pcs

Length	Dim. X	Cat. No.
65 mm	32-41 mm	262.96.211
150 mm	75-84 mm	262.96.220

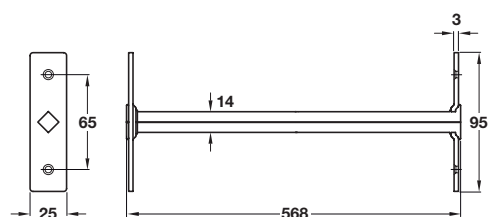
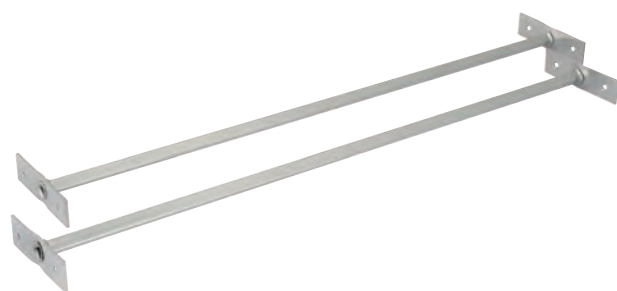
Appliance housing brace

- > Can be used to retain the structural stability of cabinets
- > Mild steel
- > Order qty: 1 pair

Finish	Cat. No.
Grey epoxy powder coated	260.91.500



> Hospa screws are shown on pages **388-393, 402**