

CLASSIC FLAT TRACK SLIDING DOOR SYSTEM

Top hung, side fixed, straight sliding doors for domestic or commercial applications such as loft apartments, restaurants, rustic kitchens, art galleries, museums, barn doors, etc.

- > Classic Flat Track
- > Range:
 - Maximum door weight **180 kg**
 - Max. door height **3.0 m**
 - Max. door thickness **44 mm**

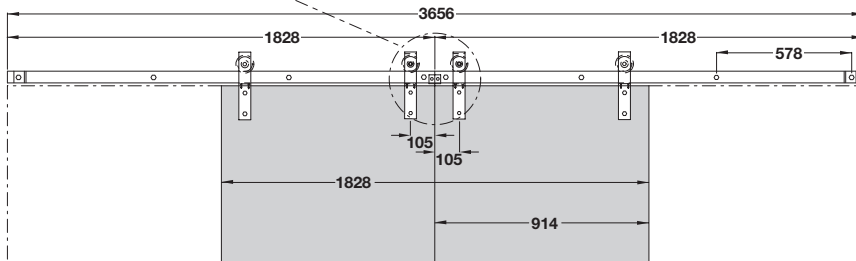
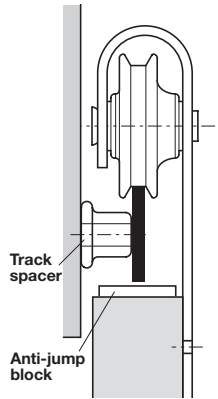
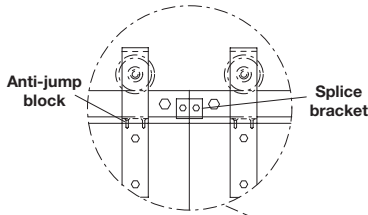

Flat top track

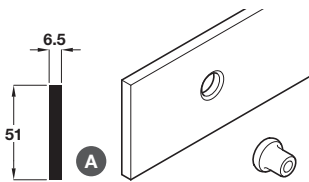

- > Side fixing
- > Black oxide coated steel
- > Flange track spacer included, 38 x 28.5 x 25 mm, black oxide coated steel
- > Order qty: 1 pc

Length	1828 mm (6ft)	2438 mm (8ft)
Item A	941.80.518	941.80.524

Classic Flat Track fittings

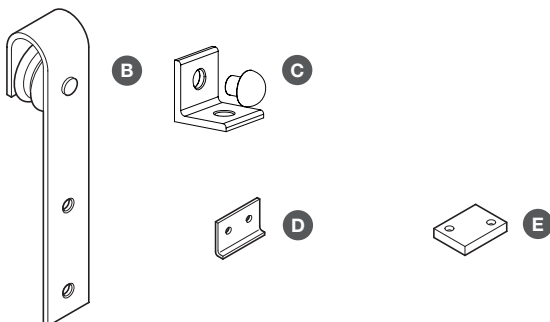

- > Order parts separately
- > B Trolley hanger, with curved plate for door fixing, 54 x 289 x 51 mm, with Ø 76 mm single roller, black oxide coated steel plate and roller
- > C Door stopper, 51 x 51 x 51 mm, black oxide coated steel
- > D Splice bracket, for connecting two top tracks, 35 x 51 x 9 mm, black oxide coated steel
- > E Anti-jump block, 38 x 51 x 9.5 mm
- > Order qty: 1 pc

Trolley hanger	Cat. No.
Item B	941.80.011
Door stopper	
Item C	941.80.042
Splice bracket	
Item D	941.80.061
Anti-jump block	
Item E	942.58.043

 > Optional bottom guides available, shown on page 95

PAGE AMENDED
22.09.15/1