

FREE FLAP PUSH TO OPEN DOOR CATCHES

For front panels without handles.

NEW



- > For front panels without handles, with Free Flap 1.7 and 3.15 flap fitting, up to a width of max. 1200 mm
- > Front gap ± 2 mm adjustment facility
- > Release distance ± 2 mm

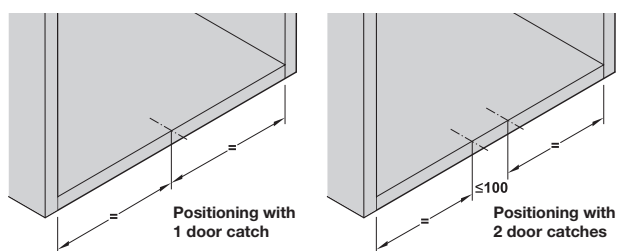

Door catches for mounting in drilled hole

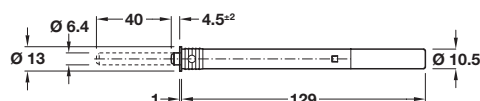

- > For mounting in drilled hole $\varnothing 11$ mm
- > Grey RAL 7004 plastic with rubber buffer
- > Order qty: 1 pc

Model	Shear force	Cat. No.
Type 1	17-23 N	372.91.480
Type 2	22-34 N	372.91.481
Type 3	26-48 N	372.91.482

Door catches for screw fixing into 32/37 mm series drilled holes

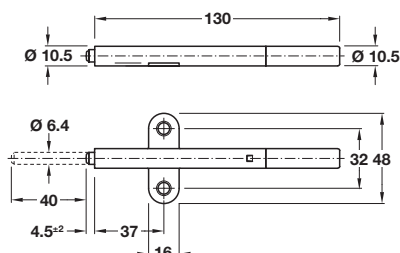

- > For screw fixing in 32/37 mm series drilled holes
- > Grey RAL 7004 plastic with rubber buffer
- > Order qty: 1 pc

Model	Shear force	Cat. No.
Type 1	17-23 N	372.91.483
Type 2	22-24 N	372.91.484
Type 3	26-48 N	372.91.485