

Flap hinge

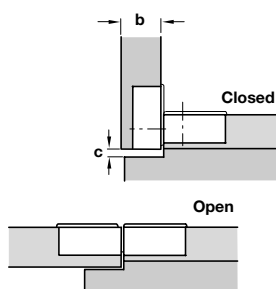

- > Opening angle 90°
- > Ø 35 mm cup
- > Screw fixing
- > For maximum flap thickness 20 mm
- > Adjustable in 3 directions
- > Zinc alloy cup and brass arm
- > Order fixing screws separately
- > Order qty: 1 pc

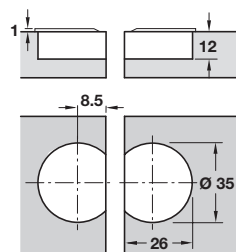
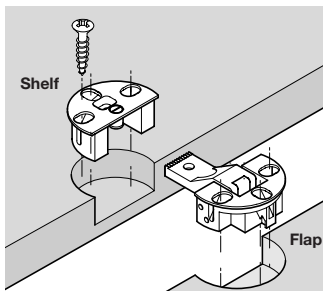
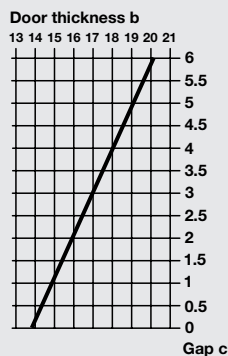

Finish
Nickel-plated

Cat. No.
342.66.718

Flap hinge

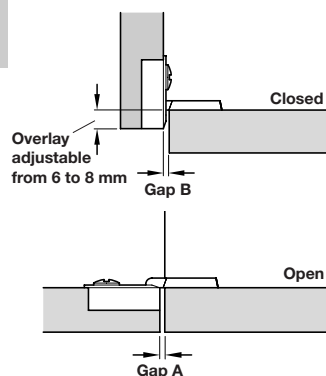
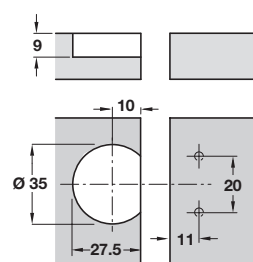
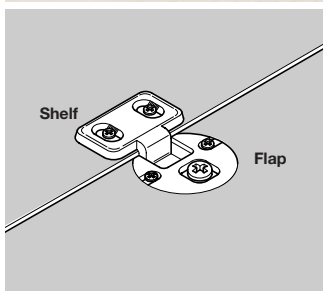

- > Opening angle 90°
- > Ø 35 mm cup
- > Screw fixing
- > Adjustable in 3 directions
- > Plastic cup and zinc alloy arm
- > Order fixing screws separately
- > Order qty: Multiples of 10 pcs

| | | | |
|---------|--------|--------|--------|
| Overlay | 6 mm | 7 mm | 8 mm |
| Gap A | 2.5 mm | 2.0 mm | 1.6 mm |
| Gap B | 0.5 mm | 1.0 mm | 1.6 mm |

PART NUMBERS REMOVED
342.76.303



Finish
Nickel-plated

Cat. No.
342.76.705