

# HÄFELE 110° INTEGRATED SOFT CLOSE HINGES

Available with either cam or standard depth adjustment.



- > For standard applications
- > Opening angle 110°, Ø 35 mm cup
- > With integrated soft close
- > Screw fixing cup with click on or slide on arm
- > Drilling pattern 45/9.5
- > For door thickness up to 22 mm see table below
- > Full overlay mounting steel cup and hinge arm, half overlay and inset mounting steel cup and zinc alloy arm
- > Available with cam or standard depth adjustment
- > Order fixing screws separately
- > Order qty: 1 pc

Drilling pattern for cup fixing

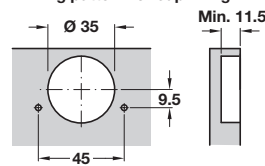

Häfele 110° Integrated soft close

Minimum gap for doors with chamfered edges (r = 1 mm) with factory setting

Door thickness mm	Distance to cup E mm		
	3.0	4.0	5.0
16	0.3	0.3	0.3
17	0.5	0.5	0.5
18	0.7	0.7	0.7
19	1.0	0.9	0.9
20	1.3	1.2	1.2
21	1.7	1.6	1.5
22	2.5	2.1	2.0

**Minimum gap F**

Screw fix hinge

Press down

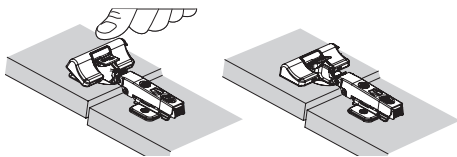

Adjustable damping force

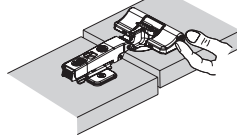

Turn towards '+' to increase and towards '-' to decrease the damping force

## Full overlay mounting, cam adjustment

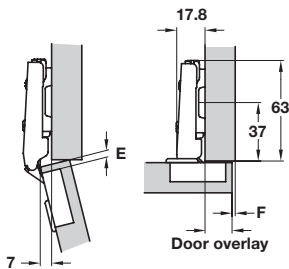

Door overlay mm							
	13	14	15	16	17	18	
				3	4	5	0
	3	4	5				3
Distance to cup E mm				Mounting plate height mm			



Type Click on  
 Cat. No. 312.24.550

## Half overlay mounting, cam adjustment

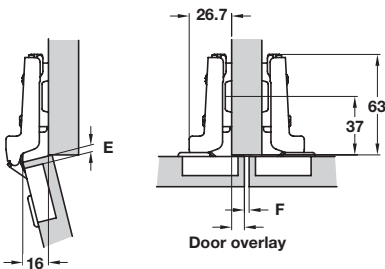

Door overlay mm							
	4	5	6	7	8	9	
				3	4	5	0
	3	4	5				3
Distance to cup E mm				Mounting plate height mm			



Type Click on  
 Cat. No. 312.24.551

## Full overlay mounting, standard adjustment

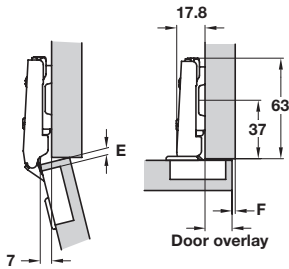

Door overlay mm							
13	14	15	16	17	18		
			3	4	5	0	
3	4	5					3
Distance to cup E mm				Mounting plate height mm			



Type	Click on	Slide on
Cat. No.	312.20.850	312.00.850

## Half overlay mounting, standard adjustment

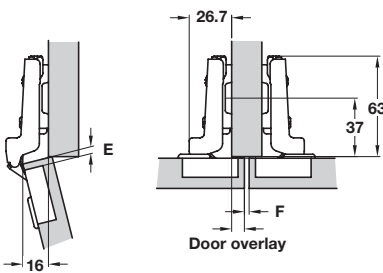

Door overlay mm							
4	5	6	7	8	9		
			3	4	5	0	
3	4	5					3
Distance to cup E mm				Mounting plate height mm			



Type	Click on	Slide on
Cat. No.	312.20.851	312.00.851

## Inset mounting, standard adjustment

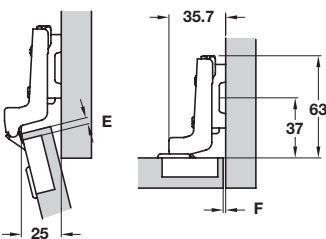

Door thickness mm							
16	17	18	19	20	21		
3	3	3					2
4/5	4	4	3	3	3	3	3
Distance to cup E mm				Gap F mm			

Dimensions given are using a 3 mm mounting plate



Type	Click on	Slide on
Cat. No.	312.20.852	312.00.852

YOU ALSO NEED:

**MOUNTING PLATES**  
Pages 326-329

**FIXING SCREWS**  
Page 468

**OPTIONAL ACCESSORIES**  
Pages 403-417

## Mounting plate for Häfele concealed hinges

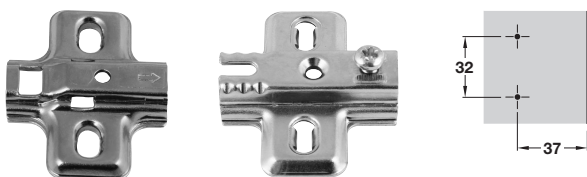

Click on

Slide on



A wider range of mounting plates are shown on pages **326-329**

- > Hospa screw fixing
- > One part plate with ± 2 mm height adjustment via slots
- > Nickel-plated steel
- > Order fixing screws separately
- > Order qty: 1 pc

**BEST SELLER**



Height	Click on	Slide on
0 mm	312.30.540	312.10.560

PAGE AMENDED  
06.01.16/1