

# HÄFELE INTEGRATED SOFT CLOSE POST HINGE

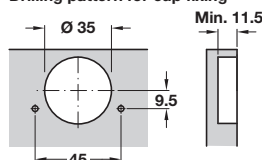

- > Post hinge
- > Opening angle 90°, Ø 35 mm cup
- > With integrated soft close
- > Screw fixing cup
- > Click on arm
- > For door thickness up to 22 mm see table below
- > Full overlay mounting steel cup and hinge arm

Drilling pattern for cup fixing



Häfele Post hinge integrated soft close

Minimum gap for doors with chamfered edges (r = 1 mm) with factory setting

Door thickness mm	Distance to cup E mm		
	3.0	4.0	5.0
16	0.3	0.3	0.3
17	0.5	0.5	0.5
18	0.7	0.7	0.7
19	1.0	0.9	0.9
20	1.3	1.2	1.2
21	1.7	1.6	1.5
22	2.5	2.1	2.0
Minimum gap F			

Screw fix hinge

Press down

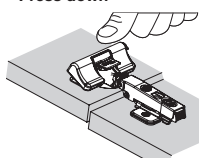

Adjustable damping force

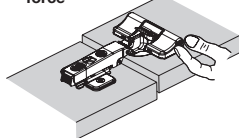

Turn towards '+' to increase and towards '-' to decrease the damping force

## Häfele integrated soft close post hinge

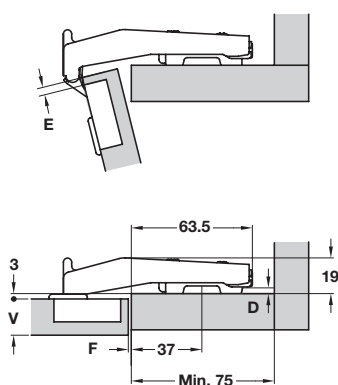

Drawings show application on D = 0 mm thick mounting plate

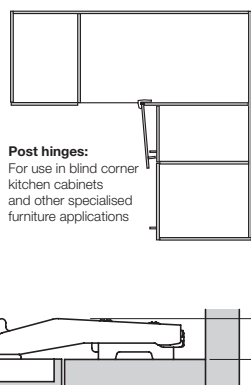

Drawings show application on D = 3 mm thick mounting plate

**Post hinges:**  
For use in blind corner kitchen cabinets and other specialised furniture applications

- > Order fixing screws separately
- > Order qty: 1 pc



Fixing

Screw fixing



Click on

312.28.510

## YOU ALSO NEED:



**MOUNTING PLATES**  
Pages 326-329



**FIXING SCREWS**  
Page 468

**OPTIONAL ACCESSORIES**  
Pages 403-417

## Mounting plate for Häfele concealed hinges



Click on



Slide on

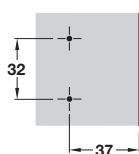

- > Hospa screw fixing
- > One part plate with ± 2 mm height adjustment via slots
- > Nickel-plated steel
- > Order fixing screws separately
- > Order qty: 1 pc

**BEST  
SELLER**



Height

0 mm

Click on

312.30.540

Slide on

312.10.560



A wider range of mounting plates are shown on pages **326-329**

PAGE AMENDED  
06.01.16/1