

NEXIS 270° HINGES, Ø 30 MM CUP, WITH EXPOSED AXLE

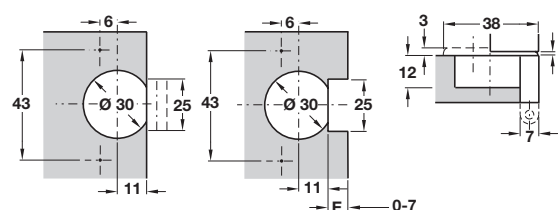

- > Opening angle 270°
- > Full overlay, with catch
- > Ø 30 mm cup
- > Screw fixing cup
- > Slide on arm
- > Semi concealed, specially designed for fold back doors
- > Nickel-plated zinc alloy cup and arm
- > Order fixing screws separately
- > Order qty: Multiples of 10 pcs



270° hinge, Ø 30 mm cup with exposed axle

For door thickness 15-21 mm

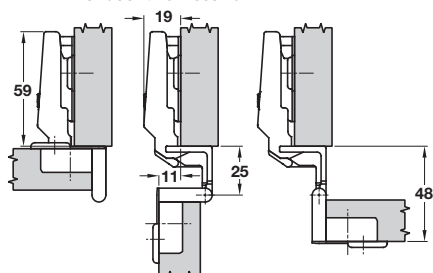

Mounting plate height = 0 mm

For door thickness 15-18 mm

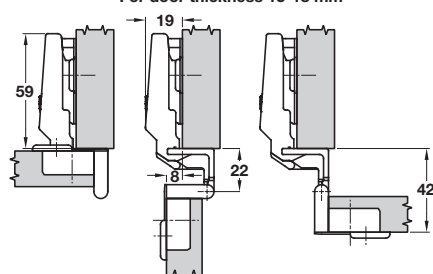

Mounting plate height = 0 mm

Door overlay mm											
6	7	8	9	10	11	12	13	14	15	16	
									7		0
		0						7			2
0						7					4
Distance to cup E mm								Mounting plate height mm			



For door thickness	15-21 mm	15-18 mm
Screw fixing	323.23.612	323.23.603

YOU ALSO NEED:

MOUNTING PLATES
Page 396

FIXING SCREWS
Page 468

OPTIONAL ACCESSORIES
Pages 397-399, 403-417

Super compact cruciform mounting plate

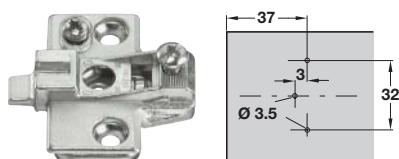

A wider range of mounting plates are shown
on pages **394-396**

- > For Hospa screw fixing
- > Two part plate with external height adjustment
- > Nickel-plated zinc alloy and pressed steel
- > Order fixing screws separately
- > Order qty: Multiples of 10 pcs

**BEST
SELLER**



Height	Hospa screw
0 mm	323.85.701

PAGE AMENDED
07.08.17/1