

ACCESSORIES FOR MX DRAWERS

Connectors and spacers for MX drawers.

MX spacer block

Installation to hinge side

Wooden panel

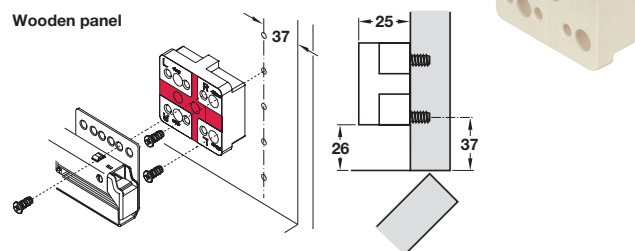

Aluminium panel

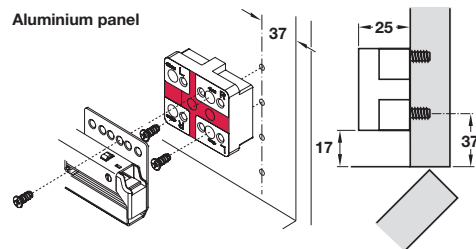

- > For internal drawer box, when used in hinged door cabinet, compensates for door offset
- > 2 spacer blocks are required per pair of runners
- > Plastic
- > Order qty: Multiples of 2 pcs

Colour	Cat. No.
White	553.62.700

Spacer

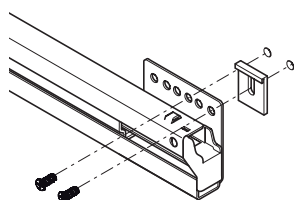
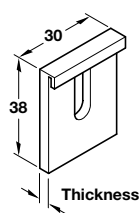

- > Spacers available for different side wall thicknesses
- > White plastic
- > Order qty: 1 pc (4 pcs required per drawer)

Thickness	1 mm	3 mm
Cat. No.	558.73.017	558.73.035

Minifix 15 housing without rim and connecting bolt

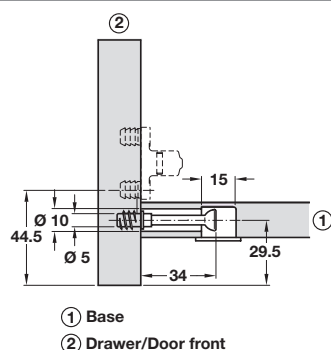
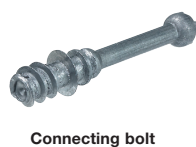

- > For wood thicknesses from 16 mm
- > For use with drawers over 800 mm wide
- > Drive: PZ2 cross slot, flat blade or SW4 hexagon socket
- > Zinc alloy
- > Order qty: Multiples of 100 pcs

Finish	Connector housing	Connecting bolt
Bright	262.26.033	262.28.611