

## INDAUX ATTRACTION TWIN WALLED STANDARD DRAWER SYSTEM

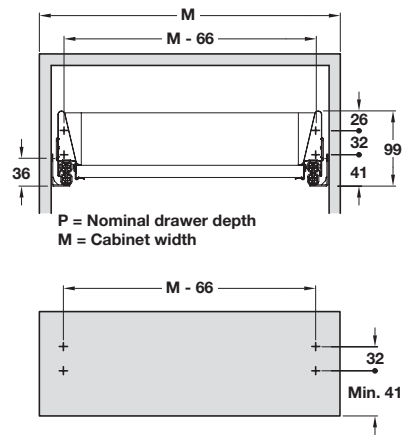

- > All parts supplied in one box
- > Quick to assemble and install
- > Standard drawer 87 mm high
- > Standard drawer suits 16 mm drawer base and rear panel
- > Runners are full extension with Indamatic gradual soft closing system incorporated
- > Drawer fronts are adjusted from on the side, neatly concealed by a plain trim cap



### Indaux Attraction twin walled standard drawer sets

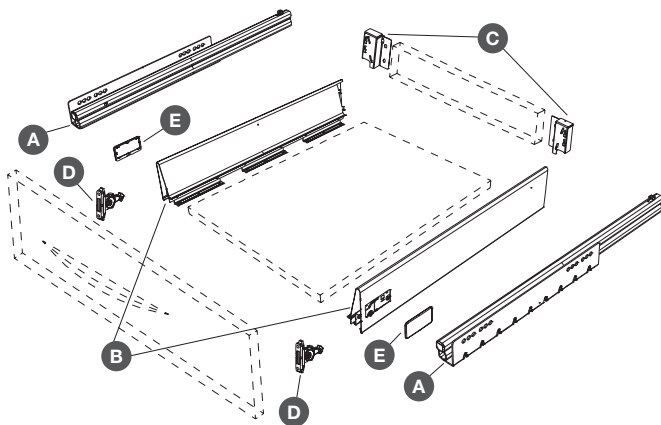

- > Set consists of:
  - A Pair of runners, 50 kg carrying capacity, full extension with Indamatic gradual soft closing system
  - B Drawer sides
  - C Wood adaptors for backs
  - D Front fixing brackets with mounting screws
  - E Covers
  - Fitting instructions
- > Galvanized steel runners with powder coated or stainless steel drawer sides
- > Order qty: 1 set



| For drawer length | Stainless steel | Silver     | Graphite   |
|-------------------|-----------------|------------|------------|
| 270 mm            | 554.35.010      | 554.35.910 | 554.35.310 |
| 480 mm            | 554.35.015      | 554.35.915 | 554.35.315 |

YOU ALSO NEED:

