

Inset handle

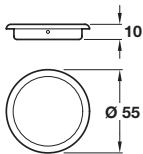

- > Suitable for timber cabinet/wardrobe doors
- > Order round-head metal pin, Ø 1.6 separately
- > Steel
- > Order qty: 1 pc



Finish	Cat. No.
Polished nickel plated, matt inside	153.20.733

Inset handle

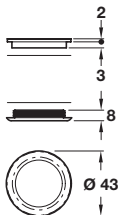

- > Suitable for sliding glass doors 4-6 mm thick
- > Requires Ø 37 mm hole
- > Brass
- > Order qty: 1 pc

Finish	Cat. No.
Polished nickel-plated	154.00.727

Inset handle

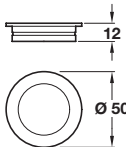

- > Suitable for timber cabinet/wardrobe doors
- > Press-in fixing
- > Zinc alloy
- > Order qty: 1 pc

Finish	Cat. No.
Matt nickel	153.20.630
Polished chrome	153.20.230

HANDY TIP

“ Remember, only ever use a dry cloth to clean a handle. ”



Micro fibre cloth 008.54.565