

Soft close flush inset handle

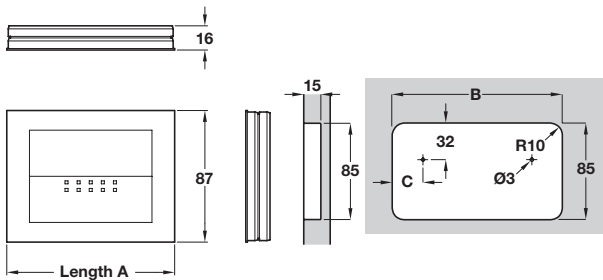

- > Order Hospa Ø 4.0 mm raised head screws separately
- > Zinc alloy, stainless steel look finish
- > Order qty: 1 pc



Length A	Dim. B	Dim. C	Cat. No.
112 mm	110 mm	22 mm	152.16.000

Inset handle

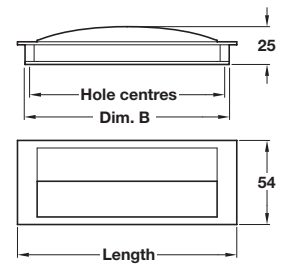

- > Order M4 handle screws separately
- > Zinc alloy, stainless steel effect
- > Order qty: 1 pc



Length	Hole centres	Dim. B	Cat. No.
145 mm	128 mm	134 mm	151.44.632
208 mm	192 mm	198 mm	151.44.634

Inset handle

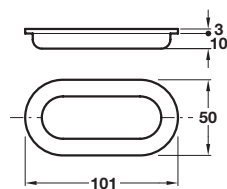

- > Stainless steel
- > Order qty: 1 pc



Finish	Cat.No.
Matt stainless steel	152.51.002

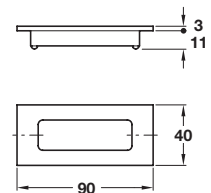

- > Concealed fixing
- > Brass
- > Order qty: 1 pc



Finish	Cat. No.
Satin nickel-plated	151.73.601