

FLAT GOLA fixing plate

E

NEW

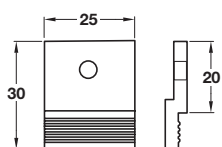
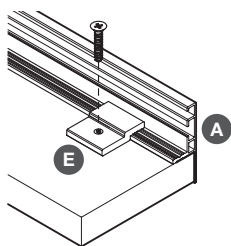
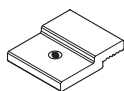

- > For fixing horizontal profile to cabinet
- > Order Hospa Ø 3.5 mm countersunk screw separately
- > Order qty: 1 pc

Finish	Cat. No.
Galvanized iron	126.36.061

FLAT GOLA connecting plate set

F

NEW

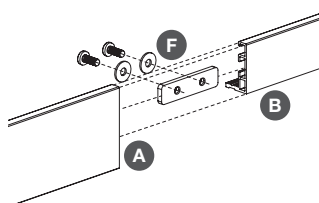
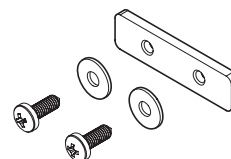

- > For connecting horizontal profiles together, e.g. 49 mm profile and 30 mm dishwasher profile
- > Set includes 2x connecting plates, 4x screws and 4x washers
- > Order qty: 1 set

Finish	Cat. No.
Galvanized iron	126.36.062

FLAT GOLA corner fixing set

G

NEW

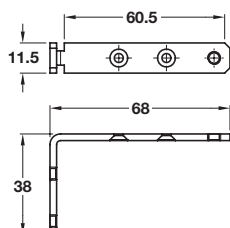
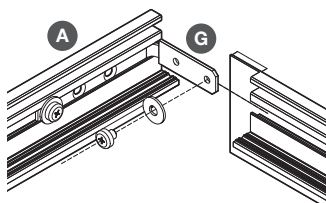

- > Installation: For connecting horizontal top profiles. Mitre cut at 45° for 90° corner or connecting drawer profiles to cabinet
- > Set includes 2x brackets, 8x screws and 4x washers
- > Order qty: 1 set

Finish	Cat. No.
Galvanized iron	126.36.063

FLAT GOLA drawer profile clips

H

NEW

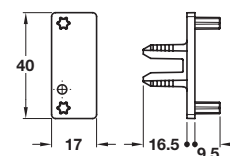
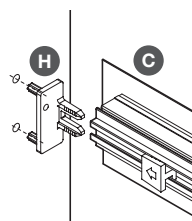
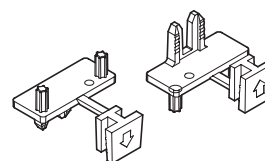

- > For dowel fixing of drawer profile
- > For installation in Ø 5 mm holes
- > Plastic
- > Order qty: 1 pair

Finish	Cat. No.
Grey	126.36.064