

# RAILING SYSTEMS

## GALLERY RAILING SYSTEM

Available in three finishes, to create railing surround for shelves.

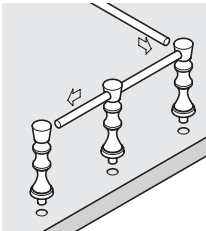

Posts press fit into  
Ø 6 mm, 12.5 mm  
deep holes

### Gallery rail, straight

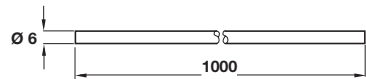

- > Ø 6 mm
- > 1000 mm long
- > Brass
- > Order qty: 1 pc

Finish	Polished brass	Polished chrome	Satin nickel
Cat. No.	522.38.800	522.38.200	522.38.600

### Gallery rail posts

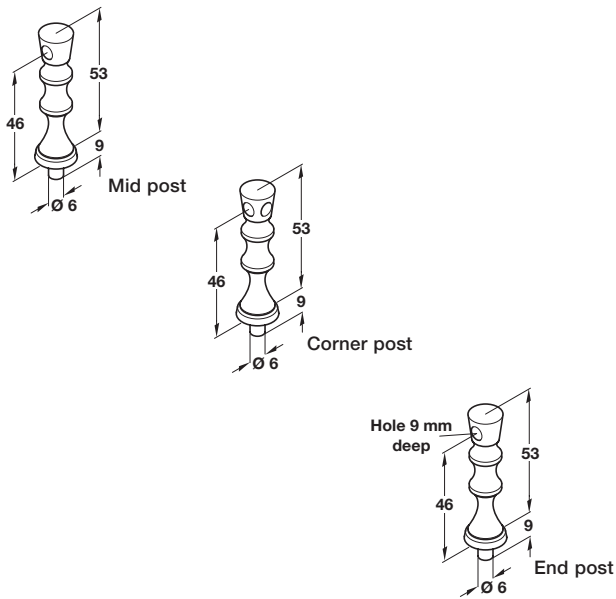

- > Steel
- > Order qty: 1 pc

Post	Polished brass	Polished chrome	Satin nickel
Mid	522.39.800	522.39.200	522.39.600
Corner	522.39.810	522.39.210	522.39.610
End	522.39.820	522.39.220	522.39.620