

LEVER HANDLE SETS FOR DISABLED TOILET DOORS

These sets are designed to be used on swing, pivot, straight, sliding and leaf and a half/folding door sets.
Lift lever to lock option.

- > With the door in the unlocked position the handle will be in the upright position with the indicator showing green.
- > When locked the handle is moved to the horizontal position and the indicator showing red.
- > It is recommended that the face fixed pull handle is mounted on the outer face

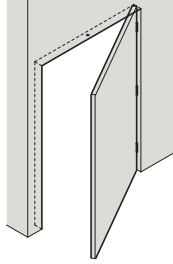

Swing door

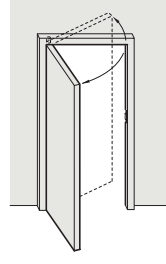

Pivot door

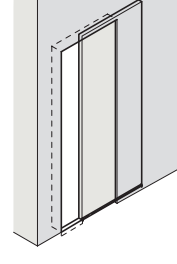

Straight sliding door

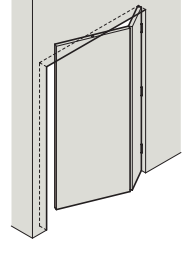

Sliding folding door

Lever handle, indicator and lock set

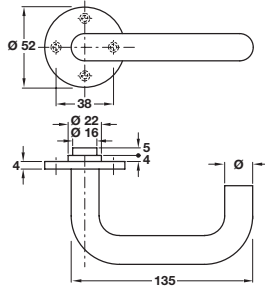

- > Unhanded
- > Set includes:
 - 1x Pair* Snowden Ø 19 mm round safety lever handle, grade 316 stainless steel, satin finish.
 - 1x Slotted spindle, zinc plated steel, 8 x 110 mm, to suit door 32-48 mm thick
 - 1x Sign: 'Lift Lever to Lock', self adhesive, white plastic
 - 1x M4 snap off bolt with sleeve, 78 mm length, to suit door 35-60 mm thick, nickel plated steel
 - 1x Bathroom claw bolt lock, with 8 mm follower, strike plate included, satin stainless steel
 - 1x WC emergency release and inside turn with 8 mm spindle included, satin stainless steel
- > *Only 1 handle from the pair is required
- > Pull handles for external use can be ordered separately - information on request
- > Order qty: 1 set

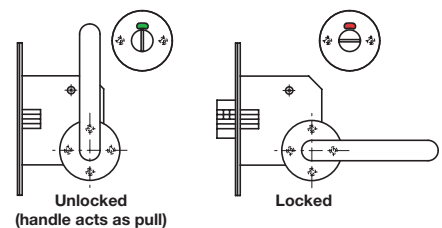
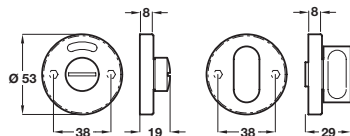
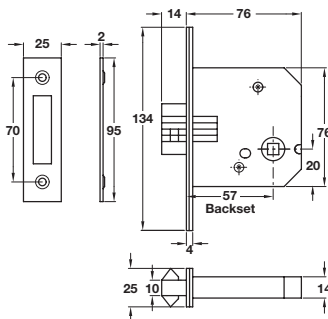
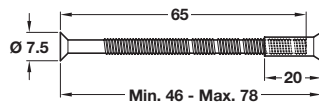

Finish	Cat. No.
Satin stainless steel	911.78.018