

HL08 Lever handle set, grade 304 stainless steel

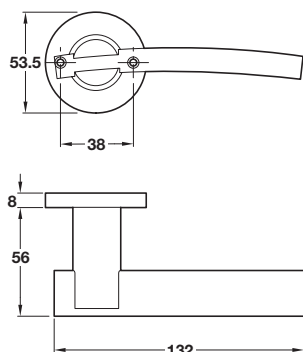

Standard keyway escutcheon



Euro profile cylinder escutcheon



WC release and inside turn

- > Pair of lever handles and roses with escutcheon or WC set included
- > 8 mm spindle included
- > Sprung, for use with standard duty followers
- > To suit doors 38-55 mm thick
- > WC/emergency release and inside turn with 8 mm spindle, suits doors 38-45 mm thick
- > Grade 304 stainless steel
- > Order qty: 1 set

BS EN 1906

2 6 - B 0 3 0 B



Lever handles	Satin	Polished
with standard keyway escutcheon		
Cat. No.	903.91.378	903.91.379
with Euro profile cylinder escutcheon		
Cat. No.	903.92.378	903.92.379
with WC/emergency release and inside turn		
Cat. No.	903.93.378	903.93.379

HL09 Lever handle set, grade 304 stainless steel

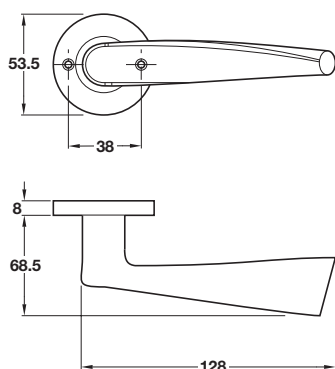

Standard keyway escutcheon



Euro profile cylinder escutcheon



WC release and inside turn

- > Pair of lever handles and roses with escutcheon or WC set included
- > 8 mm spindle included
- > Sprung, for use with standard duty followers
- > To suit doors 38-55 mm thick
- > WC/emergency release and inside turn with 8 mm spindle, suits doors 38-45 mm thick
- > Grade 304 stainless steel
- > Order qty: 1 set

BS EN 1906

2 6 - B 0 3 0 B



Lever handles	Satin	Polished
with standard keyway escutcheon		
Cat. No.	903.91.197	903.91.198
with Euro profile cylinder escutcheon		
Cat. No.	903.92.197	903.92.198
with WC/emergency release and inside turn		
Cat. No.	903.93.197	903.93.198