

1

WC/emergency release and inside turn, stainless steel

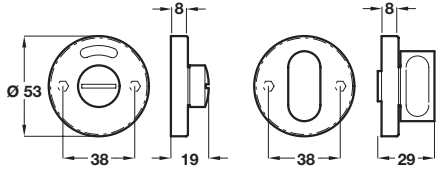

- > 8 mm spindle included
- > Suits doors up to 35 mm thick. If thicker doors are required please use spindle 909.19.900, shown below
- > Stainless steel
- > Order qty: 1 set



Finish	Cat. No.
Satin stainless steel	902.53.174
Polished stainless steel	902.53.175

Disabled WC/emergency release and inside turn, 304 stainless steel

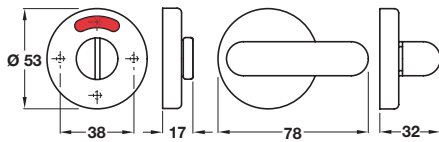
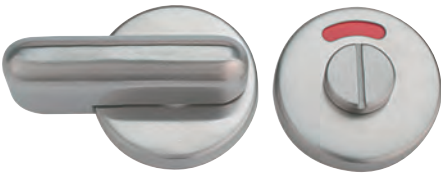

- > 5 mm spindle included (can be converted to 8 mm with spindle adaptor Cat. No. 909.40.600, shown on page 127)
- > To suit doors up to 44 mm thick
- > 304 stainless steel
- > Order qty: 1 set



Finish	Cat. No.
Satin stainless steel	902.54.890
Polished stainless steel	902.54.891

Spindle

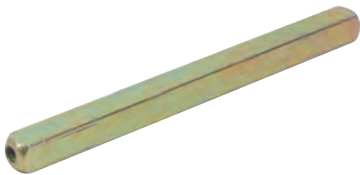

- > 8 mm square
- > Zinc-plated steel
- > Order qty: 1 pc



Length	Door thickness	Cat. No.
100 mm	Up to 44 mm	909.19.900



Co-ordinating escutcheons also available see page 27