

DRAYTON lever handles on rose, zinc alloyNote: ± 3 mm tolerance on dimensions

- > Pair of lever handles on rose
- > Designed for interior doors
- > Grub screw fixing on 8 mm square split spindle
- > Sprung, for use with standard duty followers
- > To suit doors up to 35 mm thick
- > Zinc alloy
- > Order qty: 1 pair

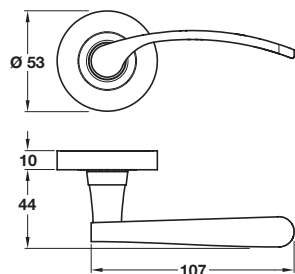
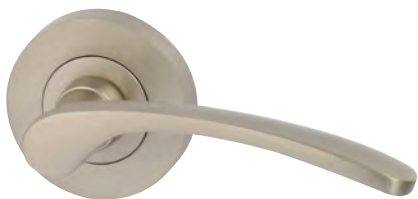
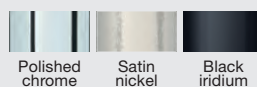
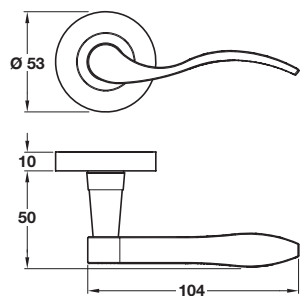

Finish	Cat. No.
Polished chrome	900.20.402
Satin nickel	900.20.406
Black iridium	900.20.403

SYWELL lever handles on rose, zinc alloyNote: ± 3 mm tolerance on dimensions

- > Pair of lever handles on rose
- > Designed for interior doors
- > Grub screw fixing on 8 mm square split spindle
- > Sprung, for use with standard duty followers
- > To suit doors up to 35 mm thick
- > Zinc alloy
- > Order qty: 1 pair

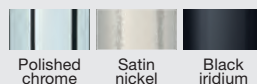

Finish	Cat. No.
Polished chrome	900.20.412
Satin nickel	900.20.416
Black iridium	900.20.413

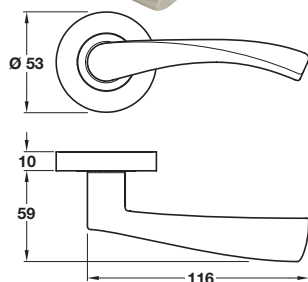
OLTON lever handles on rose, zinc alloyNote: ± 3 mm tolerance on dimensions

- > Pair of lever handles on rose
- > Designed for interior doors
- > Grub screw fixing on 8 mm square split spindle
- > Sprung, for use with standard duty followers
- > To suit doors up to 35 mm thick
- > Zinc alloy
- > Order qty: 1 pair

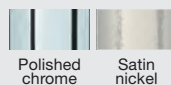

Finish	Cat. No.
Polished chrome	900.21.142
Satin nickel	900.21.146



- > Co-ordinating escutcheons and WC/emergency release also available see page 72
- > Co-ordinating levers on back plates are shown on pages 98-100