

## GRADE 316 STAINLESS STEEL

Lever handles on backplates for latches, lever locks and bathroom locks in high quality Grade 316 stainless steel.

### SNOWDON Ø 19 mm lever handles on plate, grade 316 stainless steel

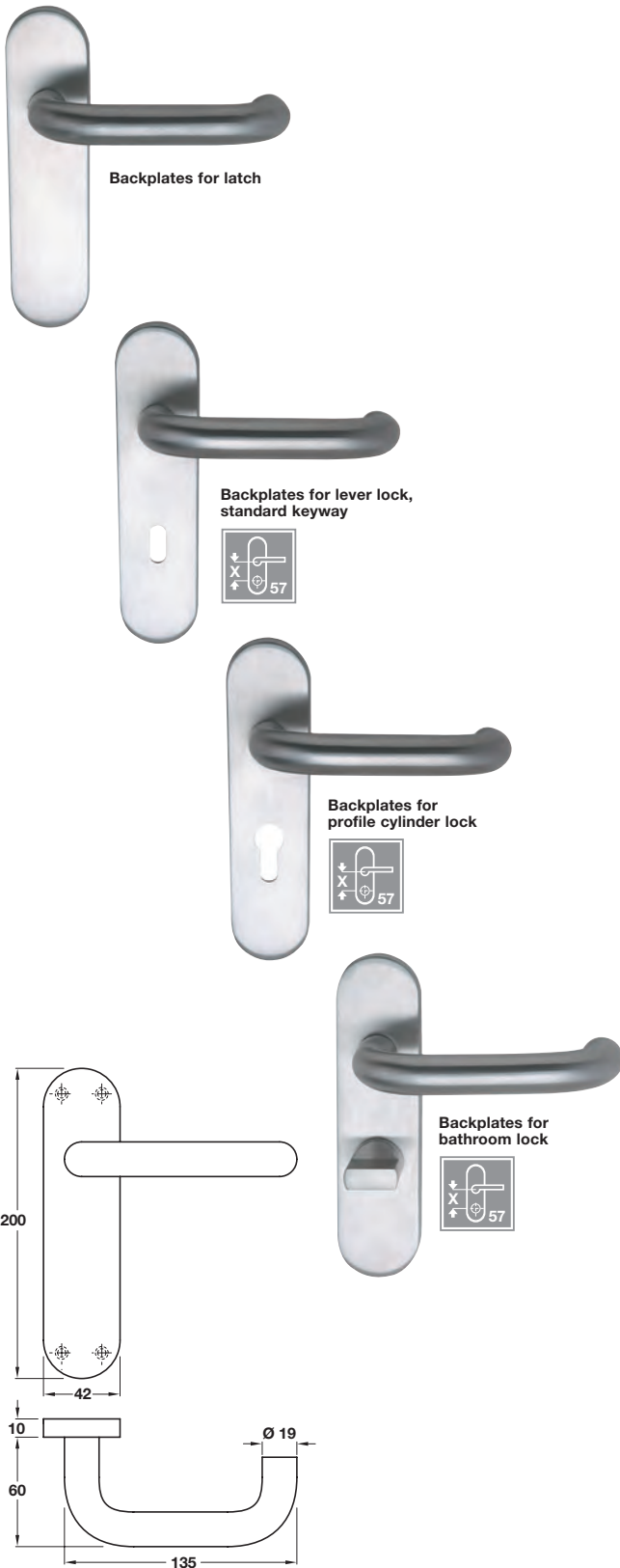

- > Pair of lever handles on backplates
- > Sprung, for use with standard duty followers
- > To suit doors 35-54 mm thick
- > Grub screw fixing on 8 mm spindle
- > 5 mm spindle also included with bathroom version
- > Grade 316 stainless steel
- > Order qty: 1 pair/1 set\*

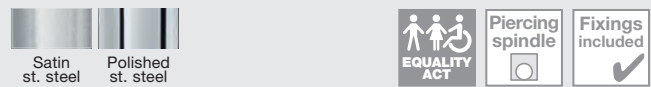

Version	Satin	Polished
<b>Backplates for latch</b>		
Cat. No.	902.90.800	902.90.801
<b>Backplates for lever lock, standard keyway</b>		
Cat. No.	902.91.800	902.91.801
<b>Backplates for profile cylinder lock</b>		
Cat. No.	902.92.800	902.92.801
<b>Backplates for bathroom lock</b>		
Cat. No.	902.94.800	902.94.801



- > Co-ordinating levers on round roses are shown on page 10
- > Co-ordinating pull handles are shown on page 143