

# FOLDASIDE 100 FOLDING CABINET DOOR SYSTEM

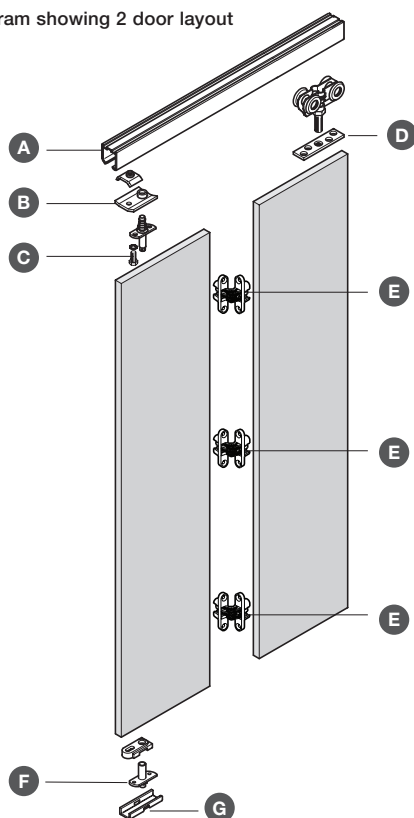
System for top hung, end folding, medium duty interior residential and commercial doors with concealed fixing for hangers and pivot. For interior medium duty folding doors using equal width door leaves. Two and four door suites only - inset doors.

- > Foldaside 100
- > Range:
  - Max. door panel weight **27 kg**
  - Max. door panel height **2500 mm\***
  - Max. door panel width **450 mm** (Up to 600 mm with continuous bottom guide channel - see items H and I shown on page 284)
  - Door thickness **20-40 mm**
- > Tracks and channels are not included in the fitting set and must be ordered separately
- > Ordering details are shown on page 120

- !** > \*If door height exceeds 2100 mm  
4x concealed hinges need to be used.  
Please contact our Technical Support for further information

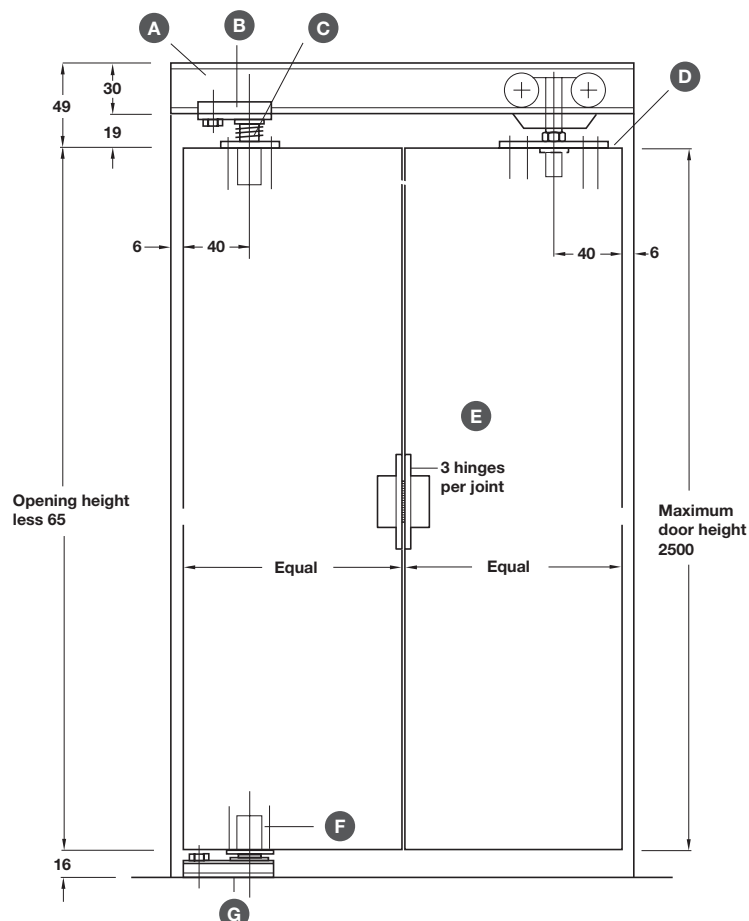
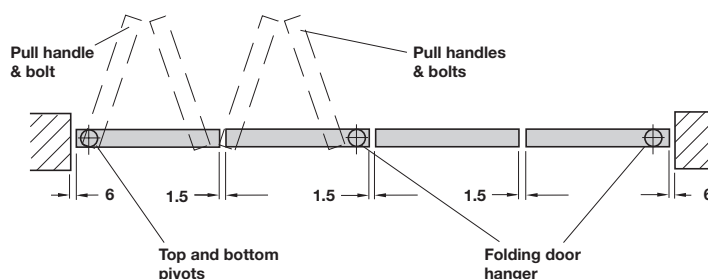


Diagram showing 2 door layout

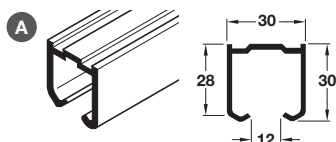


- > Door construction:
  - Leaf thickness should be a minimum of 20 mm, solid blockboard, louvred or flush panelled construction with adequate provision for fixing end pivots and hangers
- > Leaf thickness between **20-40 mm**
- > Swing leaves may not be used
- > Up to 4 leaves may be hinged together with end leaf pivoted adjacent to jamb
- > In situations where greater stability is required, bottom guiding with guide item H and floor channel item I should be used
- > For door leaves over 450 mm wide and/or over 15 kg in weight, bottom guiding with guide item H and floor channel item I **MUST** be used

Example of 4 door layout



## Foldaside 100 top track

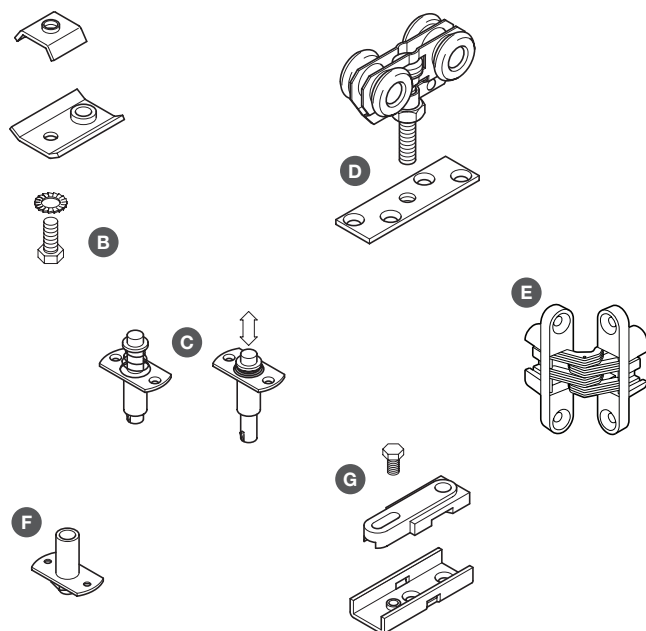


> Order tracks separately

A Top track, undrilled, anodised aluminium

Item	2.1 m	3.0 m
A Top track	941.06.821	941.06.830

## Foldaside 100 fitting sets



> Fitting set consists of:

B Top pivot housing, clamp fixing in track, pressed steel, consist of top plate 7 x 23 x 20 mm and bottom plate 5 x 30 x 40 mm

C Top pivot, spring loaded, fixed to top edge of door with plate 1.5 x 16 x 32 mm

D Trolley hanger, vertical adjustment, 4 wheels, ball bearings lubricated for life, with plate 3 x 21 x 66 mm, steel with nylon wheels

E Concealed hinge, 60 mm height, recess mounted, steel/zinc, silver finish

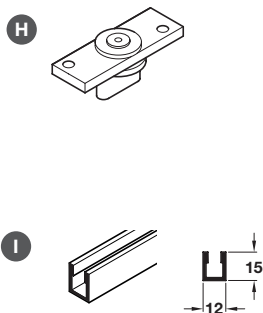
F Bottom pivot, fixed to bottom edge of door with plate 1.5 x 16 x 32 mm, steel

G Bottom pivot housing 9 x 21 x 54 mm with nylon socket slide 8 x 18 x 42 mm, pressed steel

> Order qty: 1 set

Item	For 2 doors	For 4 doors
B Top pivot housing	1 pc	1 pc
C Top pivot	1 pc	1 pc
D Trolley hanger	1 pc	2 pcs
E Hinge	3 pcs	9 pcs
F Bottom pivot	1 pc	1 pc
G Bottom pivot housing	1 pc	1 pc
Cat. No.	409.12.016	409.12.025

## Foldaside 100 alternative bottom guiding



> Alternative bottom guiding, for doors over 450 mm wide

> H Guide, light duty, 25 x 23.5 x 60 mm, steel plate with nylon blade

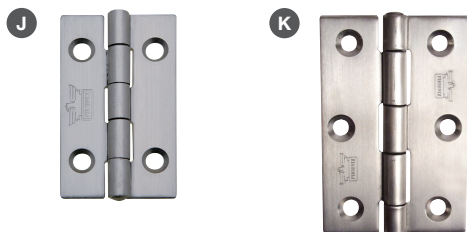
> Order qty: 1 pc (order 1 pc per pair of doors)

> I Bottom channel, pre-drilled for countersunk screws, bright aluminium

> Order qty: 1 pc (2.1 or 3.0 m length)

Additional fittings	Cat. No.
H Guide	409.12.990
I Bottom channel, length 2.1 m	409.14.010
I Bottom channel, length 3.0 m	409.14.029

## Butt hinges



> Order butt hinges separately according to requirement:

> J Butt hinge, 63 x 38 mm, pressed and rolled formed with double fold flaps for strength, for doors over 2100 mm high, max. 18 mm thick, max. 10 kg, satin or polished stainless steel

> Order qty: 1 pc

> K Butt hinge, 76 x 50 mm, unwashed, grade 4, with stainless steel fixed spun pin, for doors over 2100 mm high, max. 25 mm thick, max. 20 kg, satin or polished stainless steel

> Order qty: 1 pc

Butt hinge	Satin	Polished
J Butt hinge	921.08.100	926.91.031
K Butt hinge	921.08.104	926.91.061

! > For full information on these hinges or our full range please visit [www.hafele.co.uk](http://www.hafele.co.uk)