

HÄFELE SYSTEM 9 INFRONT SLIDING DOOR SYSTEM

Fittings for straight sliding top hung inset cupboard doors, for domestic or commercial furniture.

- > Häfele System 9
- > Range:
Max. door weight **50/80 kg**
Door thickness **19-32 mm**
- > Note: For double doors more than 19 mm thick use two single top tracks instead of double track

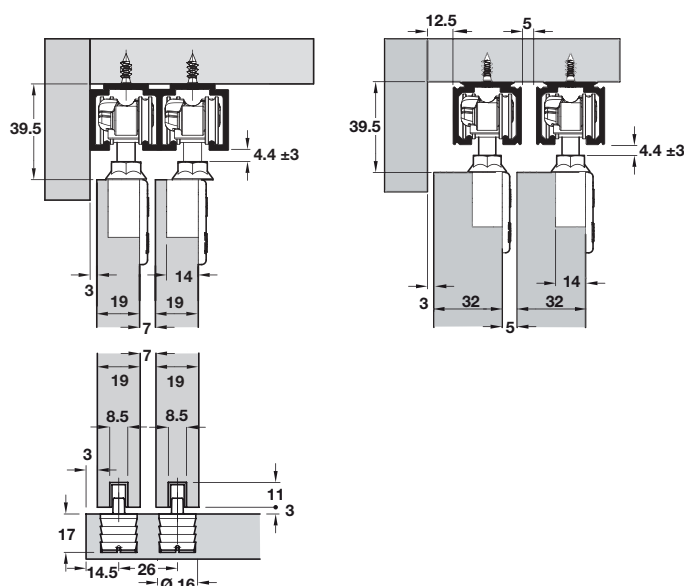
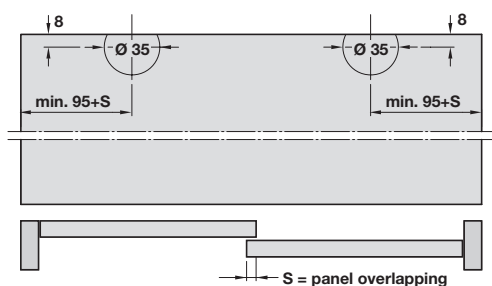

Häfele System 9 Infront tracks

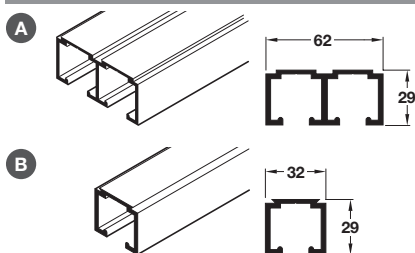

- > Order 2x single or double track

A Double top track, pre-drilled for screw mounting, silver anodised aluminium

B Single top track, pre-drilled for screw mounting, silver anodised aluminium

- > Order qty: 1 pc

Item	3.0 m
A Double top track	401.18.930
B Single top track	401.17.930

Häfele System 9 Infront fitting sets for 1 door

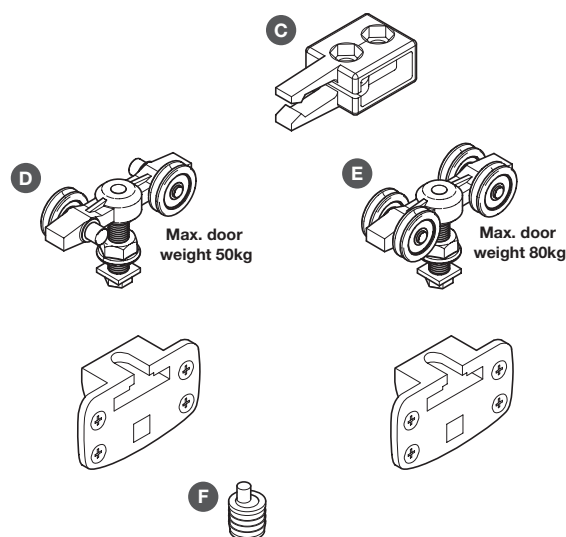

- > Fitting set includes:

C Track stopper, reversible buffer, adjustable retaining force, 19 x 56 x 26 mm, black plastic

D Trolley hanger, for inner or outer doors, with ball bearing mounted nylon rollers, screw fixing, nickel-plated zinc alloy

or E Trolley hanger, for inner or outer doors, with ball bearing mounted nylon rollers, screw fixing, nickel-plated zinc alloy

F Bottom guide, press-fit, nickel-plated zinc alloy

- > Order qty: 1 set per door

Item	Door weights up to 50 kg	Door weights up to 80 kg
C Trolley stopper	2 pcs	2 pcs
D Trolley hanger	2 pcs	-
or E Trolley hanger	-	2 pcs
F Bottom guide	1 pc	1 pc
Cat. No.	401.19.000	401.19.001
Additional item	Order qty.	Cat. No.
F Additional bottom guide	1 pc	401.20.010

Häfele System 9 bottom guide profile

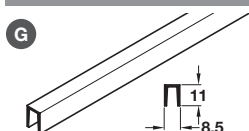

- > Off-white nylon

- > Order qty: 1 pc

Item	2.0 m
G Bottom guide profile	401.22.720