

SLIDO CLASSIC 20 VF C SLIDING DOOR SYSTEM

Good quality system for single overlaying cabinet doors, ideal for residential and commercial applications including high volume cabinet manufacturers.

- > Slido Classic 20 VF C
- > Range:
 - Max. door weight **20 kg**
 - Max. door height **1400 mm**
 - Max. door width **1250 mm**
 - For door thickness **16-19 mm**
- > ± 2 mm height adjustment on running gear using adjusting wheel
- > Mounting plate for screw fixing, running gear for sliding in and screw fixing, guide for screw fixing to door

Door installation

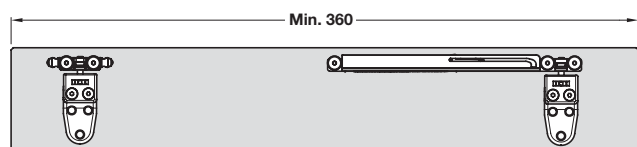
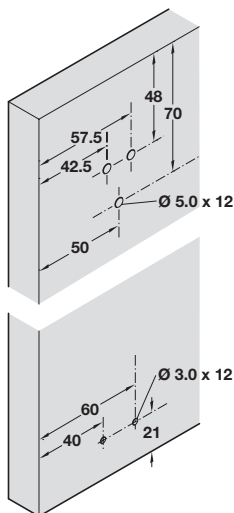
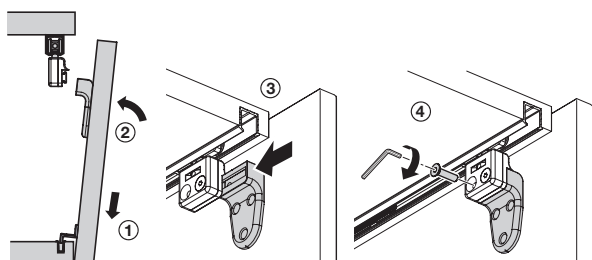

Minimum door width with one soft closing mechanism

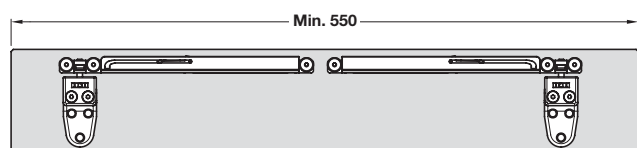

Minimum door width with two soft closing mechanism



- > Tracks and fitting sets must be ordered separately, shown on page 57

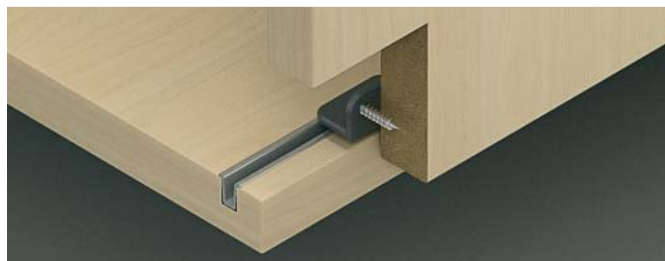

Installation dimensions

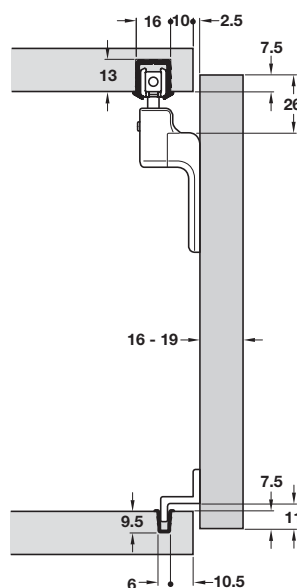

For groove mounting

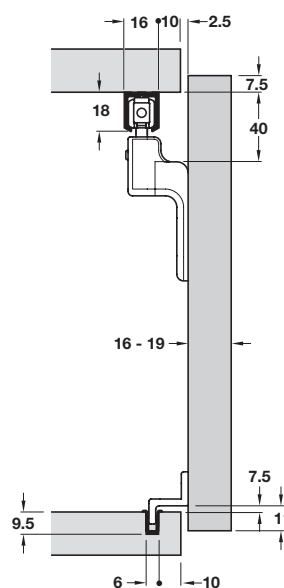

For screw fixing

Slido Classic top tracks

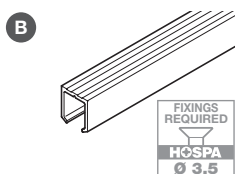
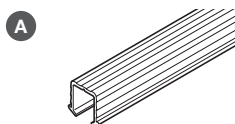

- > Order groove mounting or screw fixing track as required
- > For min 19 mm board thickness
- A Single top track, for 16 mm groove, bright aluminium
- B Single top track, for screw fixing, silver coloured anodized aluminium
- > Order qty: 1 pc



Length	2.5 m	3.5 m
A Single track, groove mounted	402.33.642	402.33.643
B Single top track, screw fixing	402.30.642	402.30.643

Slido Classic 20 VF C fitting set for 1 door

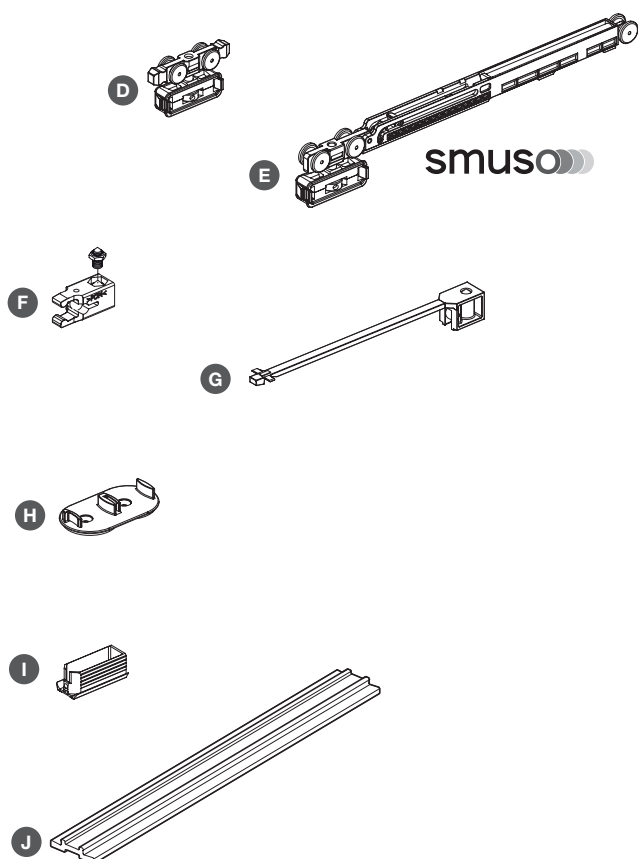

- > Fitting set includes:
- C Mounting plate, for screw fixing, zinc plated zinc alloy
- D Running gear, with friction bearing, for screw fixing, grey plastic
- E Running gear, with soft and self closing mechanism and friction bearing, for screw fixing, grey plastic
- F Clip-in door stopper, for top track, grey plastic
- G Door stopper, for soft and self closing mechanism, for top track, grey plastic
- H Bottom guide, screw fixing, grey plastic
- I Inspection support, grey plastic
- J Mounting aid, for track installation, red plastic
- > Order qty: 1 set

402.30.021 REPLACED BY **402.33.029**
 402.30.022 REPLACED BY **402.33.030**
 402.32.301 REPLACED BY **402.30.321**



Fitting set for 1 door	without soft close	with soft close
C Mounting plate	2 pcs	2 pcs
D Running gear	2 pcs	1 pc
E Running gear, soft close	-	1 pc
F Clip in door stopper	2 pcs	1 pc
G Door stopper, for soft close	-	1 pc
H Bottom guide	2 pcs	2 pcs
I Inspection support	1 pc	-
J Mounting aid	1 pc	1 pc
Cat. No.	402.33.029	402.33.030
Additional items		
G Door stopper, for soft close	-	402.30.321

Slido Classic bottom guide track

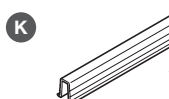

- > For press fitting and gluing into 6 mm groove
- > Ribbed, grey plastic
- > Order qty: 1 pc



Length	2.5 m	3.5 m
K Single bottom guide track	402.30.802	402.30.803