

# EKU-COMBINO 45 H FORSLIDE SLIDING DOOR SYSTEM

For 2 or 3 straight sliding interior doors. High quality sliding system for large wardrobe and cabinet doors, suitable for residential and commercial applications such as hotels, offices etc.

- > EKU-COMBINO 45 H Forslide
- > Range:
  - Max door weight **45 kg**
  - Max door height **2400 mm**
  - Max door width **1400 mm**
  - For door panel thickness **19 or 25 mm**
- > Height adjustment **+4/-2 mm**
- > EKU soft close system can be ordered separately, shown on pages **34-35**

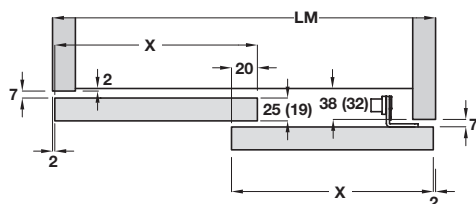

$$\text{Door width} = (LM + 16) / 2$$

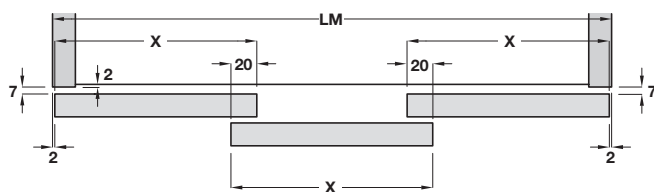

$$\text{Door width} = (LM + 36) / 3$$

X = Door width, LM = Total width

Drilling diagram

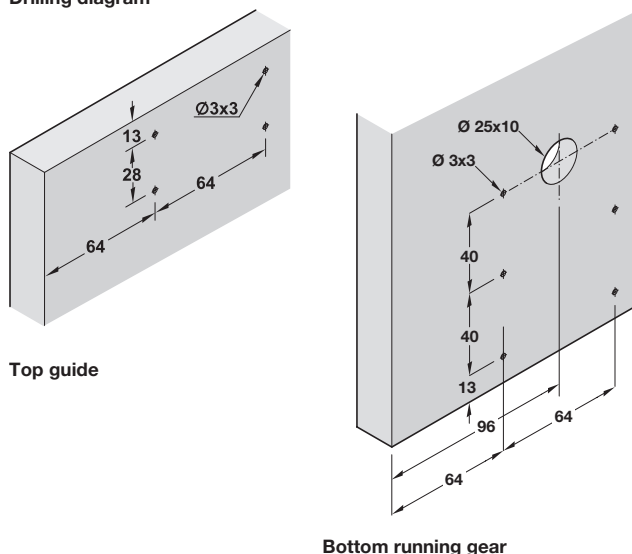

Top guide

Bottom running gear

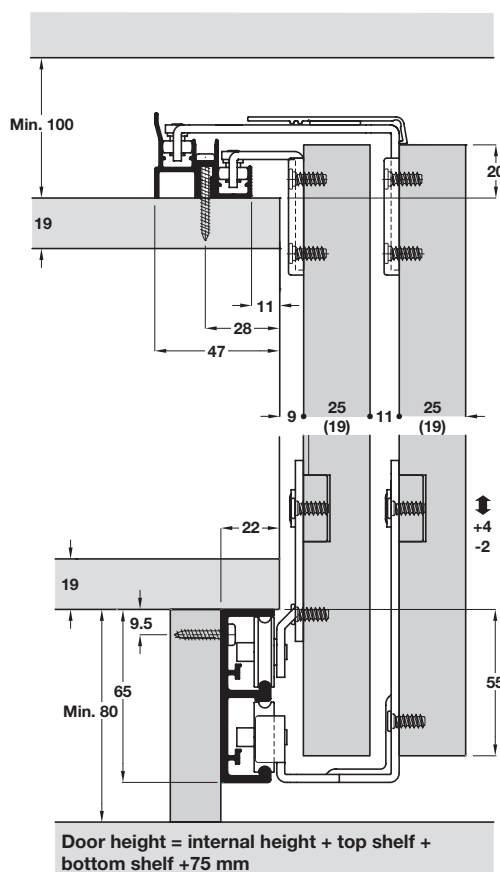
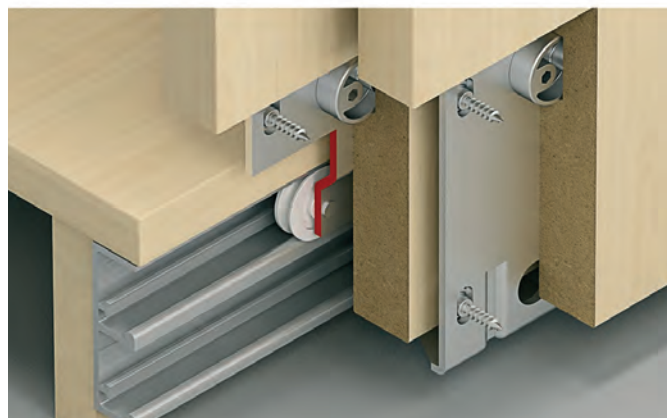
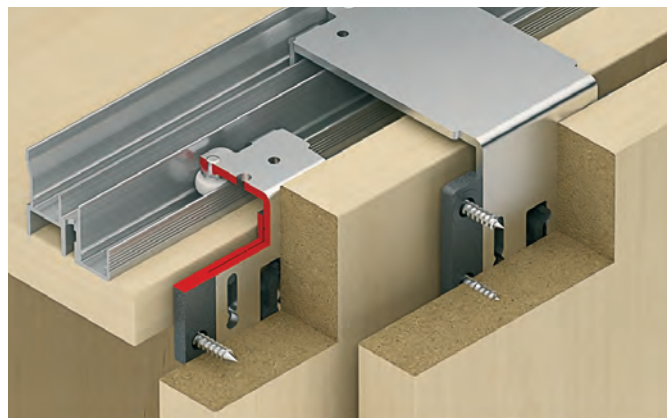

$$\text{Door height} = \text{internal height} + \text{top shelf} + \text{bottom shelf} + 75 \text{ mm}$$



> Tracks and fitting sets must be ordered separately, shown on page 7

## EKU-COMBINO 45 H Forslide top guide rail and cover profile

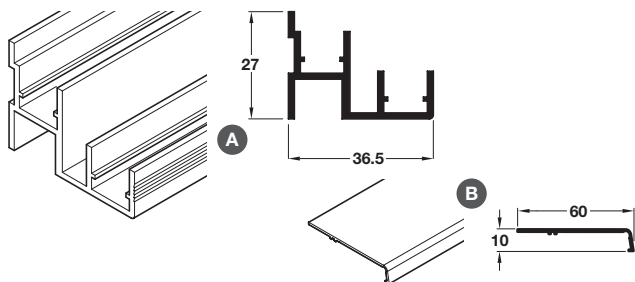

> Order double guide rail and cover profile separately

A Double guide rail, pre-drilled for screw mounting, bright aluminium

B Cover profile, clip-on, anodised aluminium

> Order qty: 1 pc

Item	2.5 m	3.5 m
A Double guide rail	405.52.025	405.52.035
B Cover profile	406.31.912	406.31.913

## EKU-COMBINO 45 H Forslide fitting sets for 2 or 3 doors

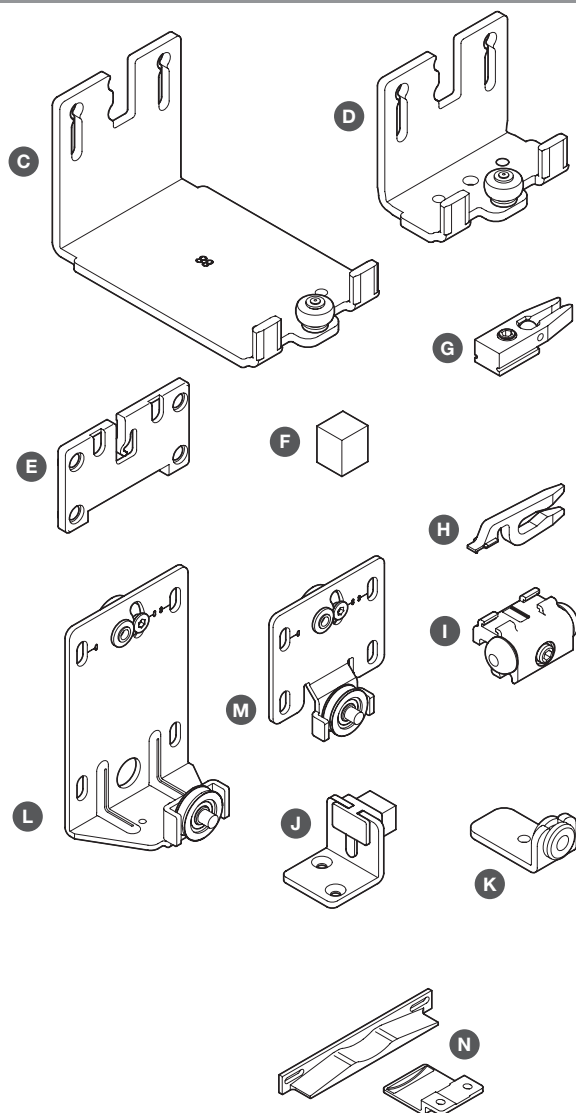

> Fitting sets for 2 or 3 doors

C Top guide for outer door, 54.5 x 54.5 x 88 mm, galvanized steel body with plastic tyred, ball bearing mounted roller

D Top guide for inner door, 54.5 x 44.5 x 31 mm, galvanized steel body with plastic tyred, ball bearing mounted roller

E Mounting fixing plate for inner and outer doors, 44 x 76 x 6 mm, anthracite grey plastic

F Buffer for centre door, 13 x 15 x 12 mm, grey foam

G Guide stopper for top track, 9 x 35 x 11 mm, grey plastic

H Track stop for bottom double running track, 16 x 50 mm, grey plastic

I Buffer for bottom double running track, 18 x 24 x 20 mm, self adhesive, grey plastic with grey rubber buffer

J Door buffer, screw fixing, for infront doors, 30 x 45 x 30 mm, galvanized steel, grey plastic with foam buffer

K Door buffer for third door, grey plastic with black rubber buffer

L Bottom roller for outer door, 122 x 82 x 55 mm, galvanized steel body with plastic tyred, ball bearing mounted roller

M Bottom roller for inner door, 68 x 82 x 19 mm, galvanized steel body with plastic tyred, ball bearing mounted roller

> Order qty: 1 set

N Intermediate stop screw fixing, grey plastic

> Order qty: 1 pc



Fitting sets	For 2 doors	For 3 doors
C Top guide, for outer door	2 pcs	2 pcs
D Top guide, for inner door	2 pcs	4 pcs
E Mounting fixing plate	4 pcs	6 pcs
F Buffer	-	3 pcs
G Guide stopper	4 pcs	4 pcs
H Track stopper	2 pcs	3 pcs
I Buffer	4 pcs	4 pcs
J Door buffer	1 pc	-
K Door buffer	-	2 pcs
L Bottom roller, for outer door	2 pcs	2 pcs
M Bottom roller, for inner door	2 pcs	4 pcs
For door thickness 19 mm only	405.91.242	405.91.243
For door thickness 25 mm only	405.91.252	405.91.253
Additional items	Cat. No.	
N Intermediate stop	405.93.020	



> EKU soft close system can be ordered separately, shown on pages 34-35

## EKU-COMBINO 45 H Forslide double bottom running track

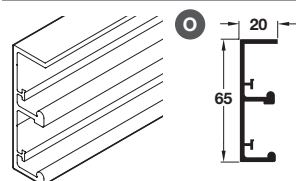

> Double bottom running track, pre-drilled for screw mounting, anodised aluminium

> Order qty: 1 pc

Item	2.5 m	3.5 m
O Double bottom running track	406.31.922	406.31.923