

EKU-COMBINO 45 H MIXSLIDE SLIDING DOOR SYSTEM

For 2 or 3 straight sliding interior doors. High quality sliding system for large wardrobe and cabinet doors, suitable for residential and commercial applications such as hotels, offices etc.

- > EKU-COMBINO 45 H Mixslide
- > Range:
 - Max door weight **45 kg**
 - Max door height **2400 mm**
 - Max door width **2400 mm**
 - For door panel thickness **19 or 25 mm**
- > Height adjustment +4/-2 mm
- > Single guide track and double running track must be ordered separately
- > Trolley hangers have a galvanized steel body with plastic tyred, ball bearing mounted roller
- > EKU soft close system can be ordered separately, shown on pages **34-35**

Door overlay

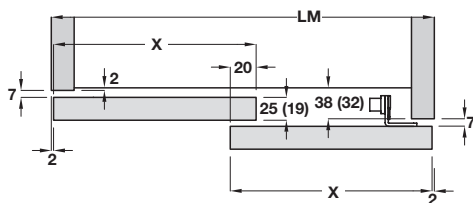

$$\text{Door width} = (LM + 16) / 2$$

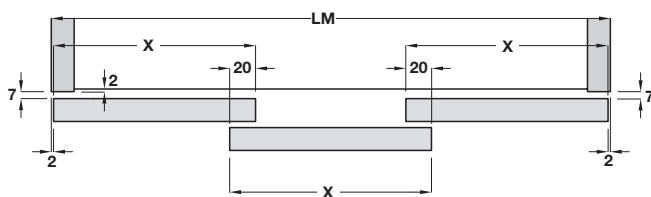

$$\text{Door width} = (LM + 36) / 3$$

X = Door width, LM = Total width

Drilling diagram

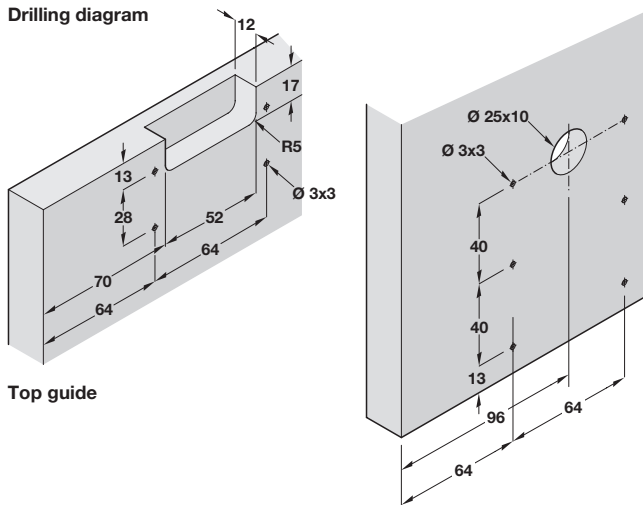

Top guide

Bottom running gear



> Tracks and fitting sets must be ordered separately, shown on page **9**

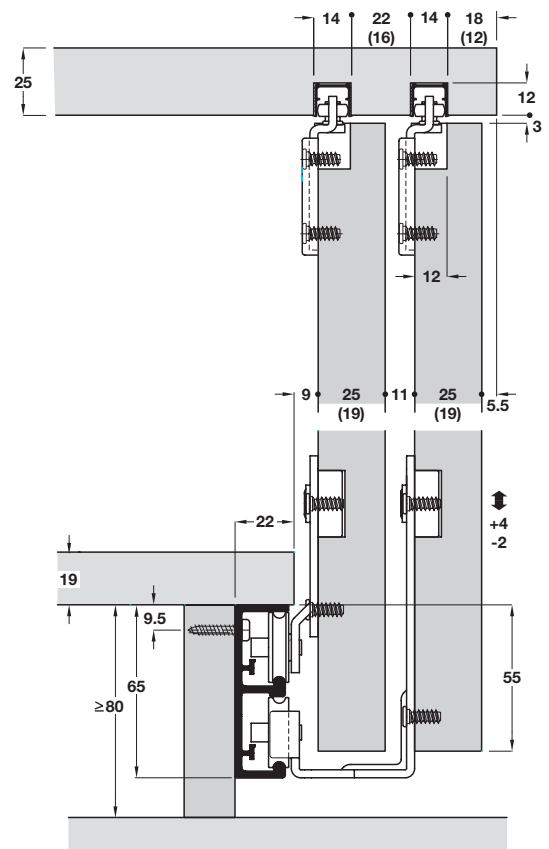
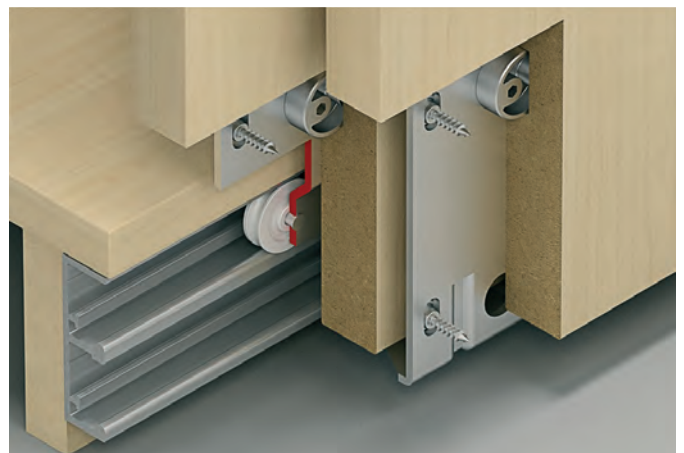
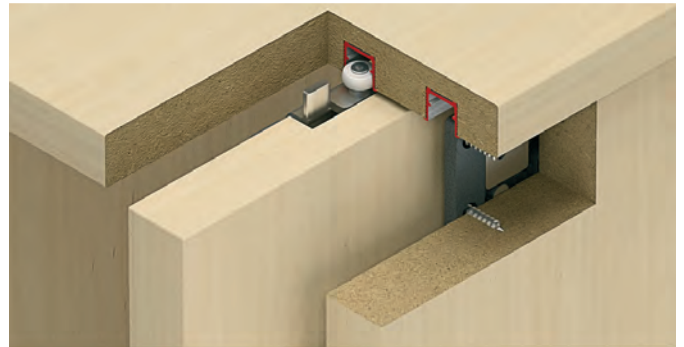

EKU-COMBINO 45 H Mixslide top track

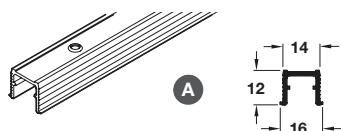

- > Single guide track, pre-drilled for screw mounting
- > Anodised aluminium
- > Order qty: 1 pc

Length	2.5 m	3.5 m
A Single guide track	405.30.025	405.30.035

EKU-COMBINO 45 H Mixslide fitting sets for 2 or 3 doors

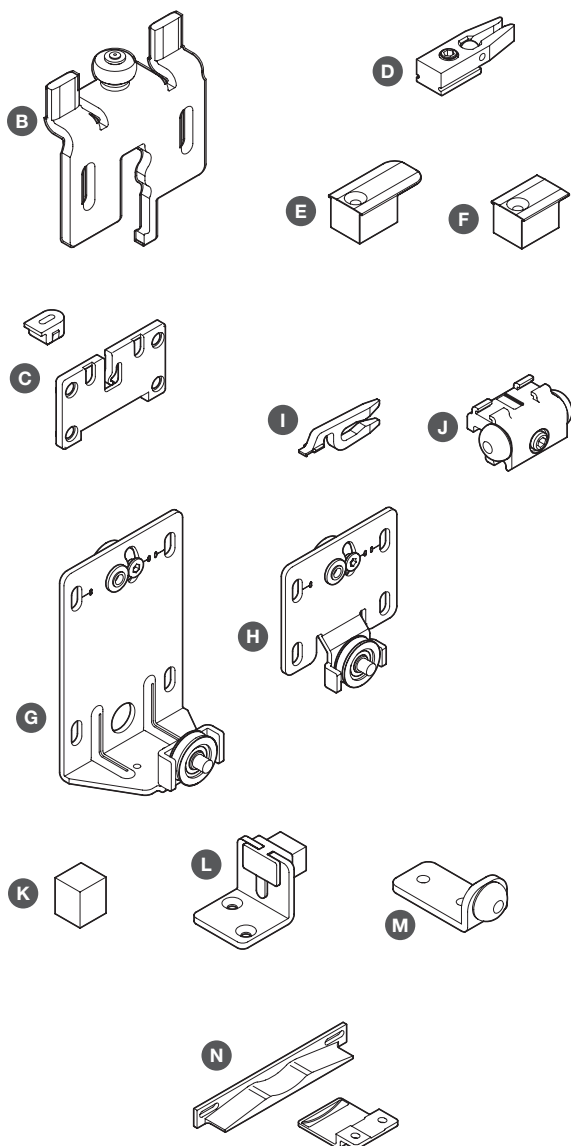

- > Fitting set consists of:
- B Top guide for inner and outer door, galvanized steel
- C Mounting fixing plate for inner and outer doors, 44 x 76 x 6 mm, anthracite grey plastic
- D Guide stopper for top track, 9 x 35 x 11 mm, grey plastic
- E Track end pieces for top track, grey plastic
- F Track end pieces for top track, grey plastic
- G Bottom roller for outer door, 22 x 82 x 55 mm, galvanized steel body with plastic tyre ball bearing mounted roller
- H Bottom roller for inner door, 68 x 82 x 19 mm, galvanized steel body with plastic tyre ball bearing mounted roller
- I Track stopper for bottom double running track, 16 x 50 mm, grey plastic
- J Buffer for bottom double running track, 18 x 24 x 20 mm, self adhesive, grey plastic with grey rubber buffer
- K Buffer for centre door, grey foam
- L Door buffer, screw fixing, for infront doors, 30 x 45 x 30 mm, galvanized steel, grey plastic with foam buffer
- M Door buffer for third door, grey plastic with black rubber buffer
- > Order qty: 1 set
- N Intermediate stop, screw fixing, grey plastic
- > Order qty: 1 pc



Item	For 2 doors	For 3 doors
B Top guide	4 pcs	6 pcs
C Mounting fixing plate	4 pcs	6 pcs
D Guide stopper	4 pcs	4 pcs
E Track end pieces	3 pcs	4 pcs
F Track end pieces	1 pc	-
G Bottom roller, for outer door	2 pcs	2 pcs
H Bottom roller, for inner door	2 pcs	4 pcs
I Track stopper	2 pcs	3 pcs
J Buffer	4 pcs	4 pcs
K Buffer	-	3 pcs
L Door buffer	1 pc	-
M Door buffer	-	2 pcs
For door thickness 19 mm only	405.91.442	405.91.443
For door thickness 25 mm only	405.91.452	405.91.453
Additional items	Cat. No.	
N Intermediate stop	405.93.020	

- > EKU soft close system can be ordered separately, shown on pages 34-35

EKU-COMBINO 45 H Mixslide double bottom running track

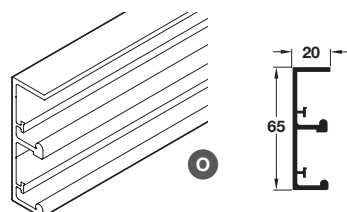

- > Double bottom running track, pre-drilled for screw mounting
- > Anodised aluminium
- > Order qty: 1 pc

Length	2.5 m	3.5 m
O Double bottom running track	406.31.922	406.31.923