

## 3D Adjustable hinge, 92 x 93 mm

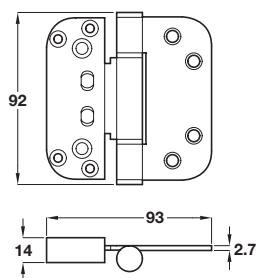

- > The 3D adjustable maintenance-free door hinge is developed for long-life performance under the most arduous conditions
- > Patented innovative design
- > Independent adjustment in all three axes by 4 mm key  
±2.5 mm height, ±2 mm side, ±2 mm depth (compression)
- > No shims - all adjustments can be carried out in situ
- > High resistance to corrosion
- > Easy 3D adjustment
- > Order fixing screws separately
- > Supercoat 500 Silver / Yellow zinc
- > Order qty: 1 pc

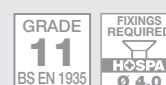
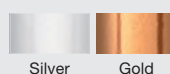

Finish	Cat. No.
Silver	926.90.409
Gold	926.90.408

## Sprung steel butt hinge, 100 x 76 mm

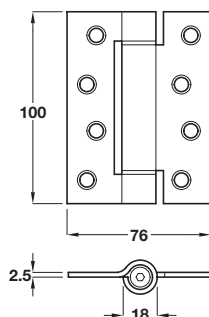

- > Single action, closes door automatically
- > UK Fire approved WF test report 161209 for FD30
- > Suitable for door weight up to 60 kg
- > For doors 914 x 2134 x 44 mm thick
- > Electro plated mild steel
- > Order qty: 1 set (1 set = 3 pcs)

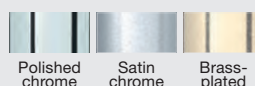

Finish	Cat. No.
Polished chrome	926.56.002
Satin chrome	926.56.004
Brass-plated	926.56.008

## Startec drill in hinge

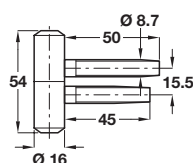

- > Maximum door weight 100 kg
- > Certified in compliance with EN 1935:2002
- > Galvanized steel
- > Order qty: 1 pc

Finish	Cat. No.
Galvanised white	922.24.190