

Captive key mortice budget lock and escutcheon

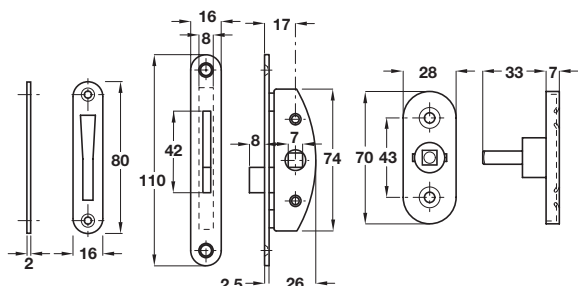

- > 90° turn to unlock. Key cannot be removed until relocked
- > Lock body: Steel
- > Forend: Radius, 1 piece. Steel
- > Strike plate: Radius, flat. 2 included. Steel
- > Escutcheon: Silver anodised aluminium
- > Order captive key separately; 970.15.920
- > Order fixing screws separately
- > Order qty: 1 pc



Cat. No.
Mortice budget lock 970.15.609

Captive key

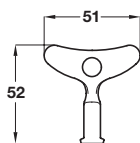

- > For use with mortice budget lock 970.15.609 above
- > Steel
- > Order qty: 1 pc

Finish	Cat. No.
Galvanized	970.15.920

Captive key rim budget lock

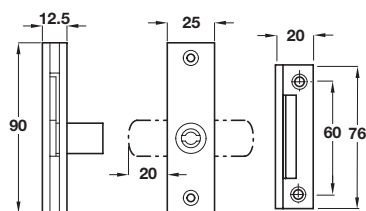

- > Captive tee key operated follower, cannot be removed until relocked
- > Lock body: Zinc plated steel
- > Strike plate: Zinc plated steel. Angled
- > Order lock and strike plate separately
- > Order captive key separately; 911.61.094
- > Order fixing screws separately
- > Order qty: 1 pc



Item	Cat. No.
Lock	911.61.093
Strike plate	230.16.940

Captive tee key

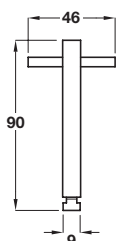

- > For use with rim budget lock 911.61.093 above
- > Steel
- > Order qty: 1 pc

Finish	Cat. No.
Zinc-plated	911.61.094