

Outside access device

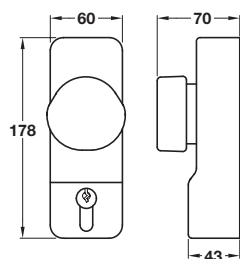

- > For use with panic exit devices (except with mortice latches)
- > Suitable for doors up to 70 mm thick
- > Suits either hand
- > Supplied complete with profile cylinder, to differ (can be supplied master keyed to order)
- > Diecast aluminium, epoxy powder coated
- > Other finishes available to order, subject to quantity
- > Order qty: 1 pc



Finish	Cat. No.
Silver	911.52.139

Outside access device

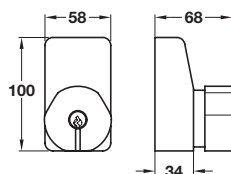

- > For use with panic exit devices (except with mortice latches)
- > Suitable for doors up to 70 mm thick
- > Suits either hand
- > Supplied complete with cylinder, to differ (cannot be supplied master keyed)
- > Diecast aluminium, epoxy powder coated
- > Other finishes available to order, subject to quantity
- > Order qty: 1 pc

Finish	Cat. No.
Silver	911.54.000

Box keeper

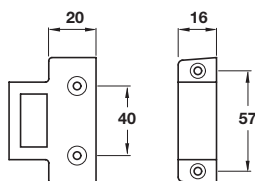

- > For flush fitting door/frame applications and double rebated doors
- > Steel, stainless steel or epoxy powder coated finish
- > Other finishes available to order as complete product, subject to quantity
- > Order qty: 1 pc



Finish	Cat. No.
Polished stainless steel	911.52.121
Silver powder coated	911.52.129



Compatible Startec panic latches and bolts are shown on pages **199-202**