

## STANDARD MORTICE CYLINDER LOCKS AND LATCHES

Adjustable spring tension - included with latch, bathroom lock and sash lock.

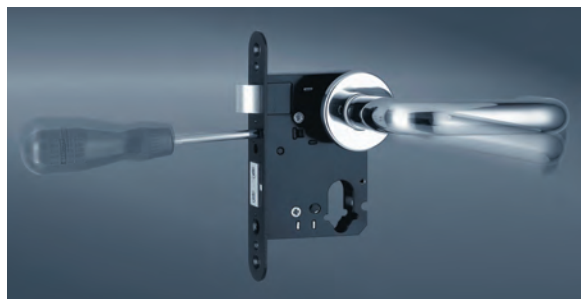

- > The adjustable spring tensioner enables the spring tension on the follower within the lock case to be adjusted to suit the weight of the lever furniture being fitted. Tension can be increased to support heavy levers, or reduced to suit light levers, especially useful for children, elderly or disabled people
- > The feature is particularly useful in heavy traffic areas, where the common problem of drooping levers due to high levels of use can be overcome with a simple turn of a screwdriver, extending the life of the lock
- > Only requires a lever depression of 35° to fully retract latch bolt

### Standard Mortice latch



- > Latch bolt operated by lever handles
- > Case: Black powder coated steel
- > Forend: Square, 2 piece, stainless steel
- > Strike plate: Square, flat, included
- > Latchbolt: Brass, reversible
- > Follower: Latch, 8 mm adjustable spring tension
- > Holed for bolt through furniture at 38 mm centres
- > Only requires a lever depression of approx. 35° to fully retract latch bolt
- > Order qty: 1 pc

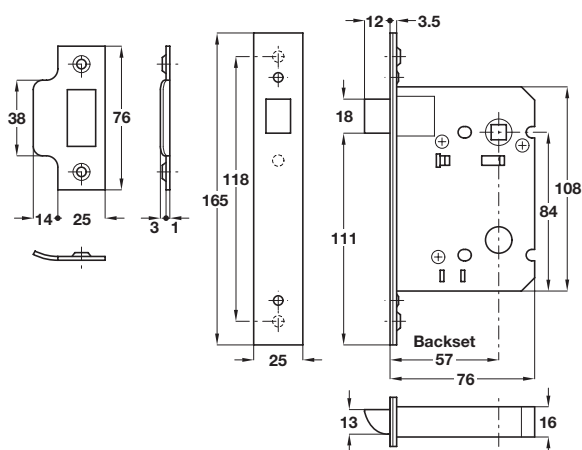

Backset 57 mm, case size 76 mm

Finish	Cat. No.
Satin stainless steel	911.03.346



Rebate sets are shown on page 26