

Plain ring handle gate latch

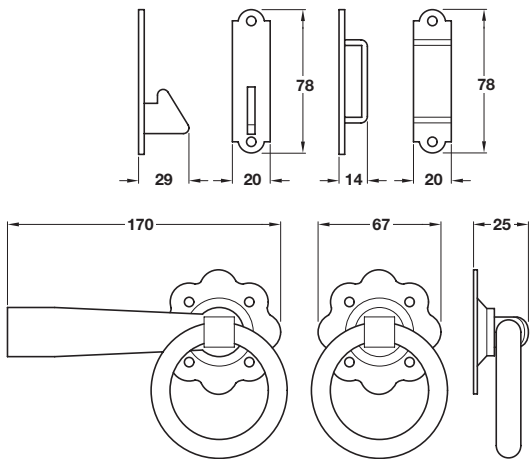

- > Face fixing
- > Steel
- > Order fixing screws separately
- > Order qty: 1 set



Note: ±5 mm tolerance on dimensions

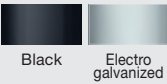

Finish	Cat. No.
Black	911.63.029
Electro galvanized	911.63.030



Plain ring handle

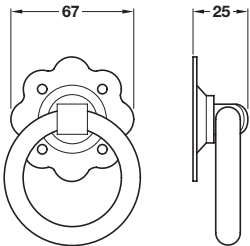

Note: ±5 mm tolerance on dimensions

- > Black steel
- > Order fixing screws separately
- > Order qty: 1 set

Finish	Cat. No.
Black	911.63.020



TCH AH 2016, © Hafele U.K. Ltd 2016. Dimensional data not binding. We reserve the right to alter specifications without notice.