

## Startec fanlight pivot patch fitting

E

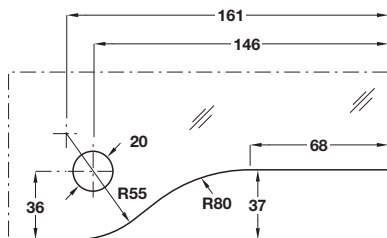

- > For glass thickness 10-12 mm
- > For left and right hand use
- > Counter bearing for top patch fitting\*
- > Screw-on plate at rear for wall mounting
- > Concealed clamp fixing with hexagon socket head screws
- > Bolt can be adjusted laterally by +/- 3 mm
- > Adapter plate for 10 mm thick glass and screw-on plate included
- > Stainless steel covers
- > Order qty: 1 pc

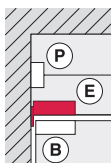
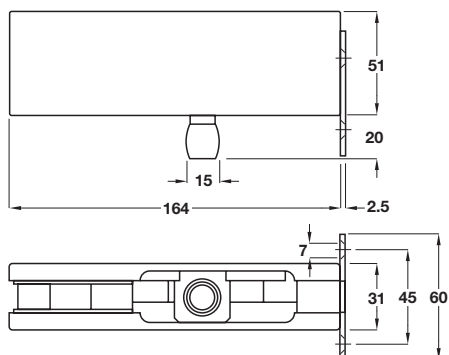

Finish

Matt stainless steel

Cat. No.

981.00.110

## RELATED PRODUCTS

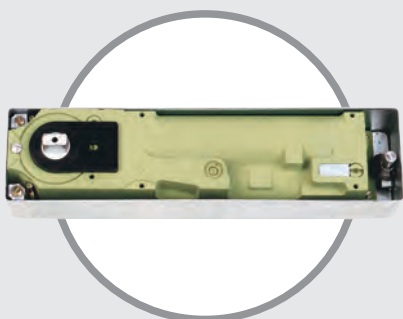

### Geze TS550 NV FP Floor spring mechanism and box, power size 3-6

German efficiency in door controls.

- > Product shown is **932.10.061**
- > For full details see **Section 4** page **49**

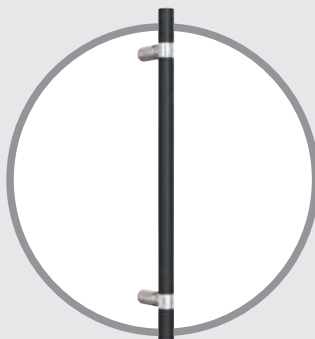

### Soft touch pull handle, bolt through fixing, grade 316 stainless steel

Manufactured in the UK, grade 316 stainless steel.

- > Product shown is **903.07.133**
- > For full details see **Section 1** page **135**



### Startec DIN Mortice latch

Häfele manufactured high quality DIN lock cases.

- > Product shown is **911.23.370**
- > For full details see **Section 5** page **9**