

HAWA-VARIOFOLD 80/H FOLDING DOOR SYSTEM

For top hung end folding wall systems, residential or commercial. A pivot bearing secures the first panel in the set; the others attach by means of stainless steel hinges that bring the panels closer together and minimise panel stacking requirements.

- > HAWA-Variofold 80/H
- > Range:
 - Minimum door thickness **35-45 mm**
 - Maximum door panel weight **80 kg**
 - Maximum panel width **900 mm**
 - Minimum panel width **500 mm**
 - Maximum panel height **3.5 m**
- > Vertical adjustment ± 3 mm
- > Left and right hand, inwards or outwards opening installations all use the same components
- > A communicating pivot door can be added to the panel stack, or the opposing end
- > Light and quite running
- > Panel stack stores compactly
- > Installation drawing reference 19586

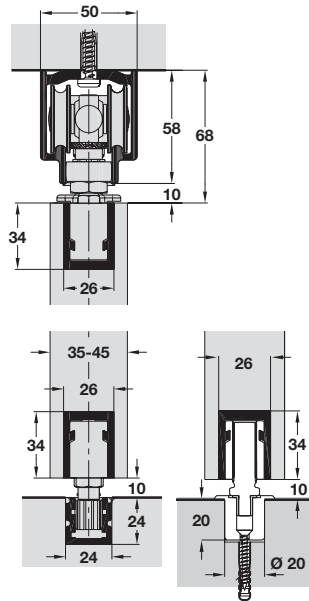

HAWA-Variofold 80/H - Guideline to specifying sets		
Configuration		Sets required
V	2 doors with bottom channel	943.29.010
V V	4 (2+2) doors with bottom channel	943.29.010 x 2 sets
V \	3 doors with bottom channel	943.29.010 + 943.29.013
V V	4 doors with bottom channel	943.29.010 + 943.29.012
V V V	5 doors with bottom channel	943.29.010 + 943.29.012 + 943.29.013
V /	3 (2+1) doors with bottom channel	943.29.010 + 943.29.014
V \ /	4 (3+1) doors with bottom channel	943.29.010 + 943.29.013 + 943.29.014
V	2 doors with no bottom channel	943.29.011
V /	3 (2+1) doors with no bottom channel	943.29.011 + 943.29.015

Top track and hinges not included



- > Tracks and fitting sets must be ordered separately, shown on page **153**
- > Hinges and seals are shown on page **155**

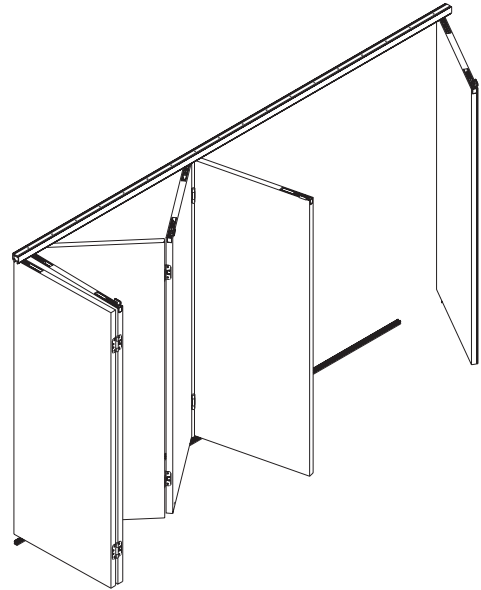

HAWA-Variofold and Centerfold 80/H tracks

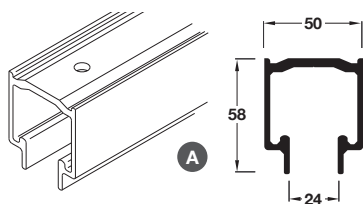

- > Pre drilled for countersunk screws
- > Anodised aluminium
- > Order qty: 1 pc

Length	2.5 m	3.5 m
Cat. No.	943.27.925	943.27.935

HAWA-Variofold 80/H fitting sets

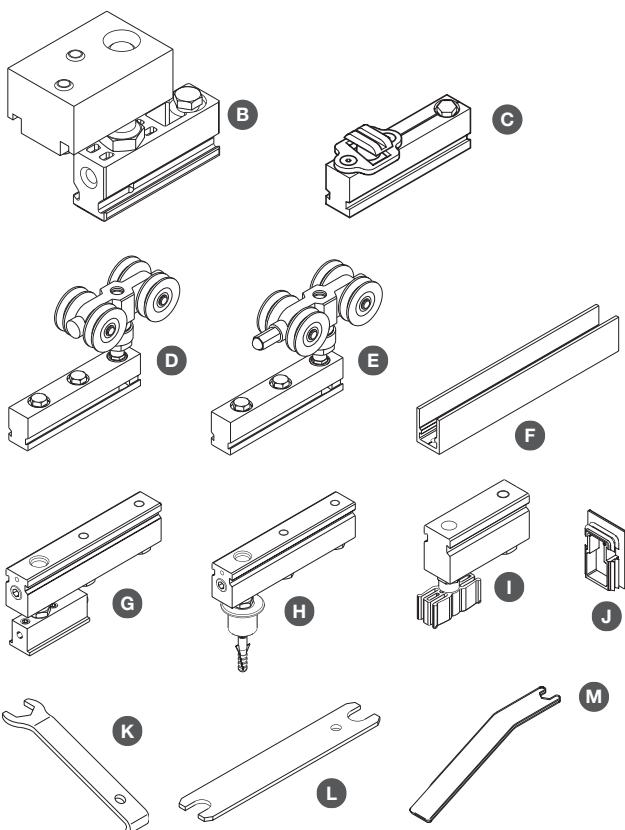

- > Fitting sets for HAWA-Variofold 80/H:
 - Set 1 - Basic set (2 doors) with pivot bearing and guide
 - Set 2 - Basic set (2 doors) with pivot bearing without guide
 - Set 3 - Additional set with guide
 - Set 4 - Pivot door set to folded stack, without trolley and top pivot bearing
 - Set 5 - Single pivot door set for installation with bottom guide channel
 - Set 6 - Single pivot door set for installation without bottom guide channel
- > Fitting sets consist of:
 - B Top pivot bearing
 - C Stop with adjustable retainer
 - D Trolley hanger. M10 plastic-tyred wheels and suspension plate
 - E Trolley hanger. M10 plastic-tyred wheels and suspension plate and spacer
 - F Suspension profile. Pre drilled for countersunk screws. Anodised aluminium
 - G Thrust bearing, for bottom guide channel, including driver
 - H Thrust bearing sleeve, Ø 20 mm, including driver
 - I Guide rattle proof, rattle proof, for bottom guide channel, plastic
 - J Cover cap. Anthracite grey plastic
 - K Vertical adjustment key
 - L Suspension assembly locking wrench
 - M Fork spanner
- > Order qty: 1 set



- > Ordering guide, shown on page **152**
- > Hinges need to be ordered separately, shown on page **155**

Set	Fittings included in HAWA-Variofold 80H fitting sets												Cat. No.
	B	C	D	E	F	G	H	I	J	K	L	M	
Set 1	1 pc	1 pc	1 pc	-	5 pcs	1 pc	-	1 pc	5 pcs	1 pc	1 pc	1 pc	943.29.010
Set 2	1 pc	1 pc	1 pc	-	4 pcs	-	1 pc	-	4 pcs	1 pc	1 pc	1 pc	943.29.011
Set 3	-	1 pc	-	1 pc	3 pcs	-	-	1 pc	3 pcs	-	-	-	943.29.012
Set 4	-	1 pc	-	-	1 pc	-	-	-	1 pc	-	-	-	943.29.013
Set 5	1 pc	1 pc	-	-	3 pcs	1 pc	-	-	3 pcs	-	-	-	943.29.014
Set 6	1 pc	1 pc	-	-	3 pcs	-	1 pc	-	3 pcs	-	-	-	943.29.015

HAWA-Variofold 80/H channels

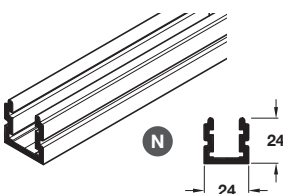

- > Anodised aluminium
- > Order qty: 1 pc

Length	2.5 m	3.5 m
Cat. No.	940.81.250	940.81.350