

HAWA-CENTERFOLD 80/H FOLDING DOOR SYSTEM

For heavy centre-fold walls for residential or commercial applications. A pivot bearing secures the first panel in the set; the others attach by means of stainless steel hinges that bring the panels closer together and minimise panel stacking requirements.

- > HAWA-Centerfold 80/H
- > Range:
 - Minimum door thickness **35-45 mm**
 - Maximum door panel weight **80 kg**
 - Maximum panel width **900 mm**
 - Minimum panel width **500 mm**
 - Maximum panel height **3.5 m**
- > Vertical adjustment ± 3 mm
- > Left and right hand, inwards or outwards opening installations all use the same components
- > A communicating pivot door can be added to the panel stack, or the opposing end
- > Light and quite running
- > Panel stack stores compactly
- > Installation drawing reference 19587

- > Tracks must be ordered separately, shown on page **153**
- > Hinges need to be ordered separately, shown on page **155**
- > Ordering guide shown on page **155**

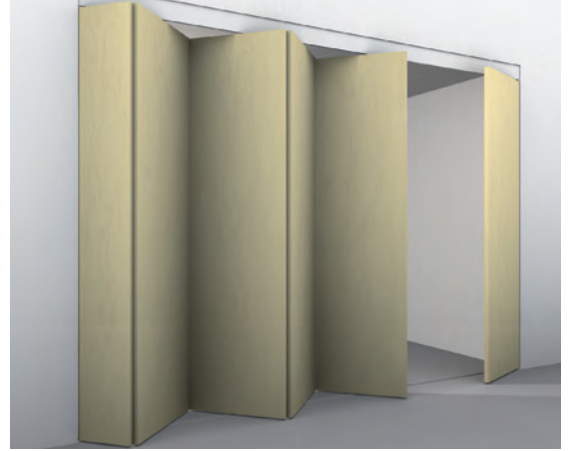
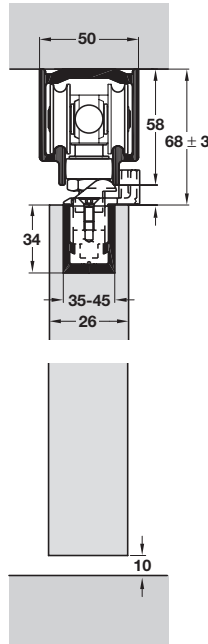

HAWA Centerfold 80H fitting sets

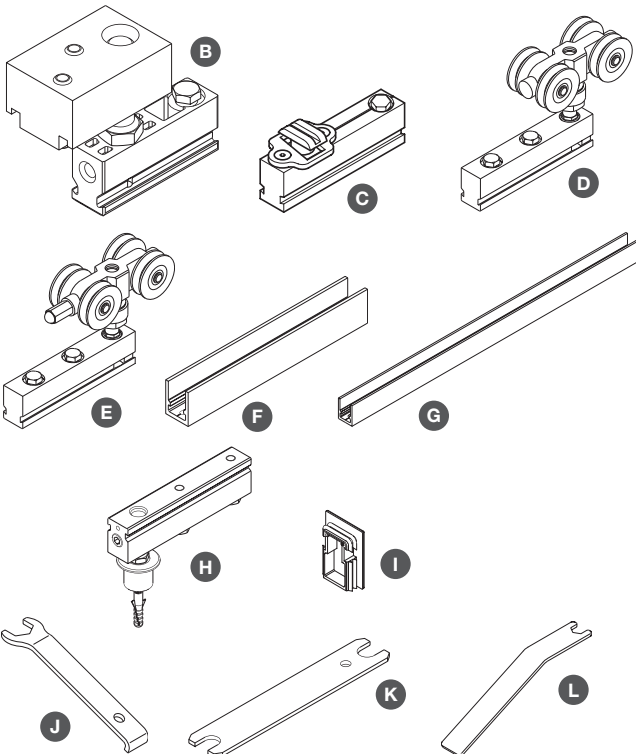

- > Fitting sets for HAWA-Centerfold 80/H:
 - Set 1 - Basic set with pivot bearing, without guide
 - Set 2 - Additional set without guide
 - Set 3 - Pivot door set to folded stack, without trolley and top pivot bearing
 - Set 4 - Single pivot door set for installation without bottom guide channel
- > Fitting sets consist of:
 - B Top pivot bearing
 - C Stop with adjustable retainer
 - D Trolley hanger. M10 plastic-tyred wheels and suspension plate
 - E Trolley hanger. M10 plastic-tyred wheels and suspension plate and spacer
 - F Suspension profile 208 mm. Pre drilled for countersunk screws. Anodised aluminium
 - G Suspension profile 550 mm. Pre drilled for countersunk screws. Anodised aluminium
 - H Thrust bearing sleeve, D=20 mm, including driver
 - I Cover cap. Anthracite grey plastic
 - J Vertical adjustment key
 - K Suspension assembly locking wrench
 - L Fork spanner
- > Order qty: 1 pc (2.5 or 3.5 m length)

Set	Fittings included in HAWA-Centerfold 80H fitting sets											Cat. No.
	B	C	D	E	F	G	H	I	J	K	L	
Set 1	1 pc	1 pc	1 pc	-	2 pcs	1 pc	1 pc	3 pcs	1 pc	1 pc	1 pc	943.27.100
Set 2	-	1 pc	-	1 pc	-	1 pc	-	1 pc	-	-	-	943.27.101
Set 3	-	1 pc	-	-	1 pc	-	-	1 pc	-	-	-	943.29.013
Set 4	1 pc	1 pc	-	-	3 pcs	-	1 pc	3 pcs	-	-	-	943.29.015

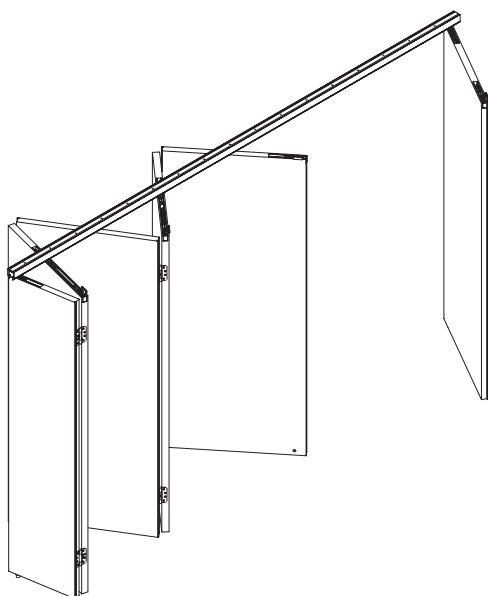

HAWA-Centerfold 80/H - Guideline to specifying sets		
Configuration		Sets required
✓	1 and a half doors	943.27.100
✓\	2 and a half doors	943.27.100 + 943.29.013
✓✓	3 and a half doors	943.27.100 + 943.27.101
✓✓\	4 and a half doors	943.27.100 + 943.27.101 + 943.29.013
✓✓	1 and a half + 1 and a half doors	943.27.100 x 2 sets
✓ /	1 and a half + 1 door	943.27.100 + 943.29.015

Top track and hinges not included

Seal

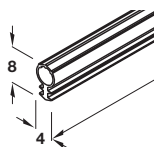

- > Hollow cross-section seal strip, eliminates the problem of light penetrating through gaps between panels
- > Black
- > Order qty: 1 roll

Length	10 m
Cat. No.	950.08.300

HI-LOAD Stainless steel 3 knuckle butt hinge



BS EN 1935

4 7 5 1 1 2 0 12

- > 100 x 86 mm, grade 12 BS EN 1935
- > Certifire CF209 approved for fire doors up to 1 hour
- > Max. adjusted door weight 100 kg, min. door thickness 40 mm
- > 25 year performance guarantee
- > Maintenance free carbon steel/bronze flanged bushes
- > Grade 304 stainless steel
- > Order qty: 1 pc



Finish	Cat. No.
Satin stainless steel	926.88.010

Phoenix Slimline, stainless steel butt hinge

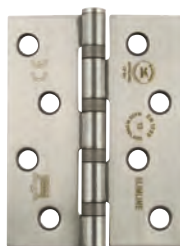

BS EN 1935

4 7 6 1 1 4 0 13

- > 102 x 76 mm, grade 13 BS EN 1935
- > Certifire approved; certificate no. CF351 30 mins
- > Max.adjusted door weight 120 kg, min. door thickness 35 mm
- > Five knuckle hinge with hardened steel thrust washers
- > Grade 304 stainless steel
- > Order qty: 1 pc



Finish	Cat. No.
Satin stainless steel	921.08.140
Polished brass	921.08.159