

# FOLDASIDE 340 ENDFOLD FOLDING DOOR SYSTEM

Top hung internal end folding partitions, timber or metal doors. For domestic, residential and commercial applications. For odd or even number suites

- > Foldaside 340 Endfold
- > Range
  - Max. weight per door leaf **50 kg**
  - Max. door height **3.3 m**
  - Max. opening width **14.4 m**
  - Max. door leaf width **900 mm** (when hinged to folding suites reduce door width to 800 mm)
  - For door thickness **40-55 mm**
- > Up to 8 leaves may be hinged together
- > No rebated head facility, swing leaves are best hinged to jambs
- > Track brackets usually soffit fixed, additional brackets required where doors stack

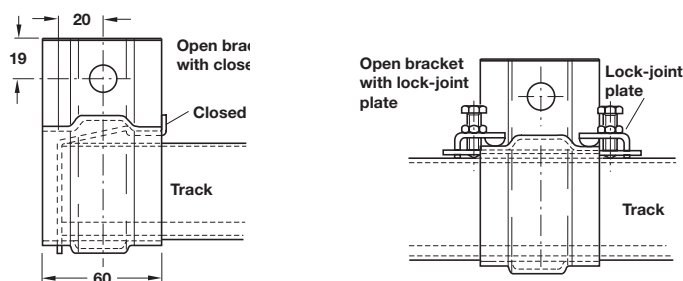

## Series 300 System top track brackets - Selection Guide

- 1 - Closed end brackets should be fitted at **both ends** of each track run
- 2 - Lock joint brackets should be fitted at each **track joint**
- 3 - An additional open bracket should be fitted at all points on the track where the doors stack open
- 4 - Brackets should be positioned at 600-900 mm centre intervals along the track

### Examples

2 m length of track - single stacking area

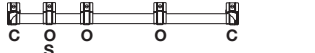

3 m length of track - single stacking area

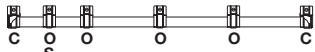

2 x 3 m lengths of track - single stacking area

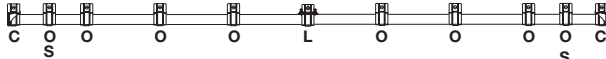

### Key

- O = Open bracket
- C = Closed end bracket
- L = Lock joint bracket



- > This is a guide only. If very heavy or large numbers of panels are proposed, additional brackets may be required - Please contact Technical Support for further assistance

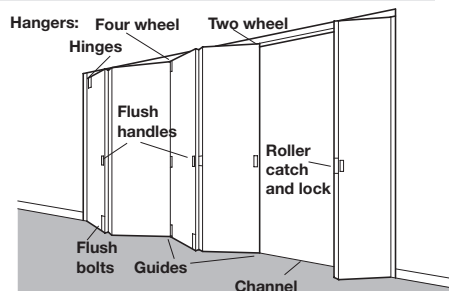

- > Hinges and accessories must be ordered separately, shown on pages **162-163**

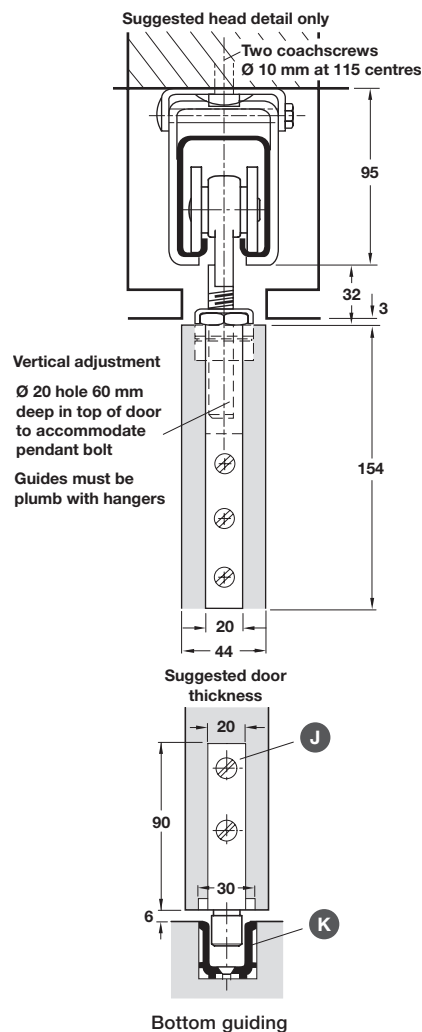

**Important:** Where the jamb to first leaf joint is hinged with butt hinges, the first leaf must be narrower in width than the other leaves in the suite. The dimension is **A** or **B** shown below

### 3, 5 or 7 leaves one way

- A** = 1/2 door thickness + 29 mm + offset of hinges
- B** = 1/2 door thickness + 29 mm + offset of hinges + X
- X** = Rebate depth

### Example:

To find **A** where door = **44 mm thick** and offset of hinge = **5 mm**  
**A** = 29 + 22 + 5 = **56 mm**

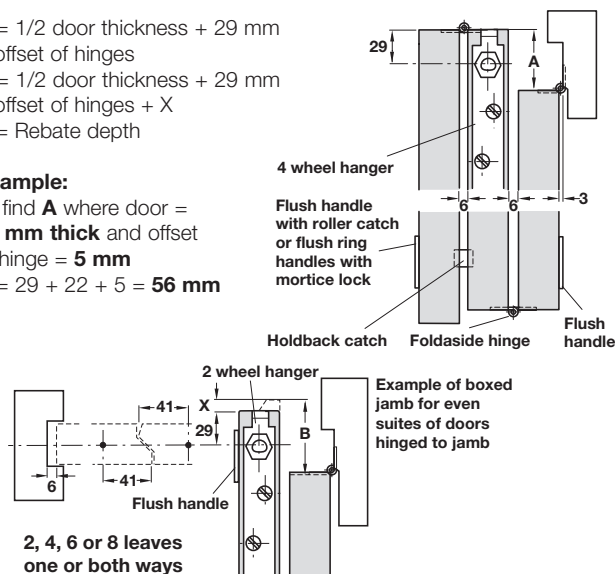

## Foldaside 340 Endfold tracks and fixing brackets

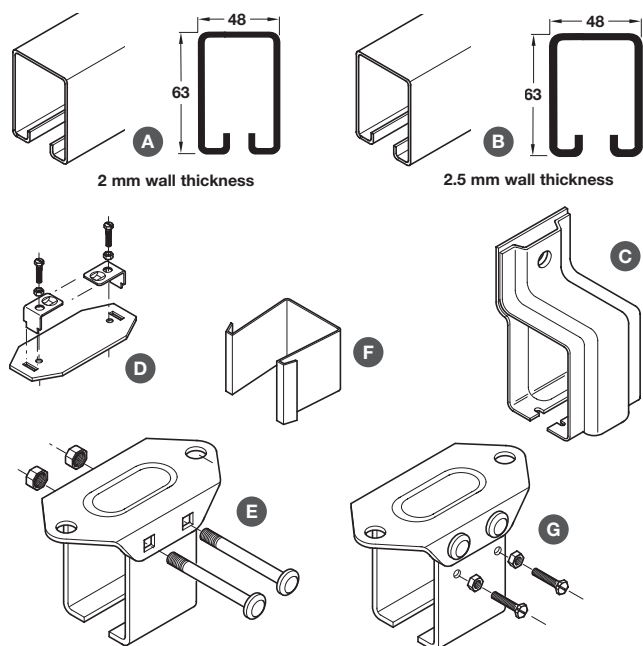

> Refer to top track brackets selection guide shown on page 160

- > A Top track, galvanized steel (2 mm gauge) to BS EN 10142
- > B Top track, galvanized steel (2.5 mm gauge) to BS 2989. Use of this track increases max. door weight to 55 kg provided adequate track support brackets are used
- > C Side fixing bracket, open, 121 x 67 mm, for closed end piece use item F, galvanized pressed steel
- > D Lock joint plate, 894 mm, to convert to lock joint bracket, can be used on all brackets if extreme rigidity required, galvanized pressed steel
- > E Soffit fixing bracket, open, 65.5 x 95 mm, for parallel and cross ear applications, galvanized pressed steel
- > F Closed end piece, unhandled, 51 x 48 x 50 mm, to convert or to closed end bracket, galvanized pressed steel
- > G Soffit bracket lock-joint type, 65.5 x 95 mm, do not over tighten set screws, galvanized pressed steel

Item	2.1 m	3.0 m	Order qty
A Top track, 2 mm	942.52.921	942.52.930	1 pc
B Top track, 2.5 mm	-	942.52.830	1 pc
Cat. No.			
C Side fixing bracket		942.52.080	1 pc
D Lock joint plate		942.52.082	1 pc
E Soffit fixing bracket		942.52.083	1 pc
F Closed end piece		942.52.084	1 pair
G Soffit bracket lock-joint type		942.52.085	1 pc

## Foldaside 340 Endfold trolley hangers

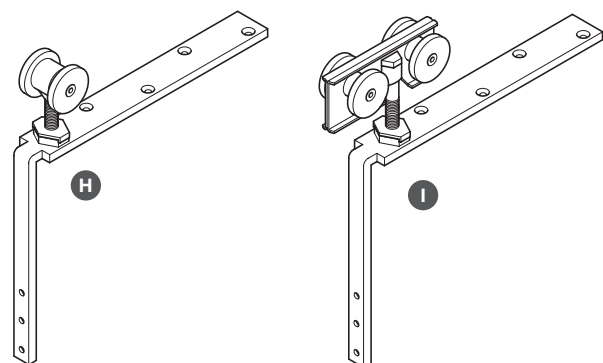

- > To prevent wheels clashing in track when open, position 2 and 4 wheel trolley hangers alternately
- > Use 4 wheel hanger next to access door
- > All steel, Ø 38 mm plastic wheels, ball bearing lubricated for life
- > With vertical adjustment
- > Order qty: 1 pc

Item	Cat. No
H Trolley hanger, 2 wheels	943.22.010
I Trolley hanger, 4 wheels	943.22.011

## Foldaside bottom guiding

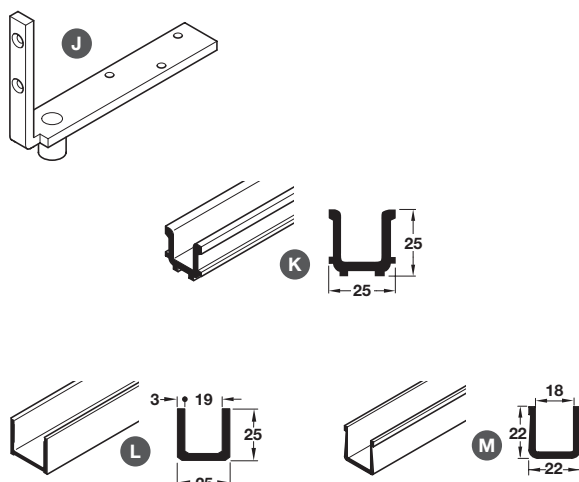

- > Order door guide and choice of channel separately
- > Floor channel unnecessary under swing leaves
- > J Door guide, 30 x 152 x 90 mm, steel angle plate fits rebate of doors, brass roller
- > K Channel, 25 x 25 mm, pre-drilled for countersunk screws, bright aluminium
- > L Channel, 25 x 25 mm, pre-drilled for countersunk screws, stainless steel, recommended for use where open threshold subject to heavy foot traffic i.e. school assembly halls
- > M Channel, 22 x 22 mm, pre-drilled for countersunk screws, brass
- > Order qty: 1 pc

Door guide	Cat. No.	
Item J	943.20.030	
Channel	2.1 m	3.0 m
K Channel, aluminium	942.51.721	942.51.730
L Channel, stainless steel	-	943.26.930
M Channel, brass	-	943.23.930