

HAWA-JUNIOR 80 AND 80/B SLIDING DOOR SYSTEM

Junior 80 is a vertically adjustable sliding door fitting for interior doors exceptionally light and silent action. All parts are corrosion resistant (ideal for cavity applications). Junior 80/B suitable for low headroom applications.

- > HAWA-Junior 80
- > Range:
 - Max. door weight **80 kg**
 - Min. door thickness **26 mm**
 - Max. door height normally **2.3 m**
- > Height adjustment ± 4 mm
- > Installation drawing reference 17689

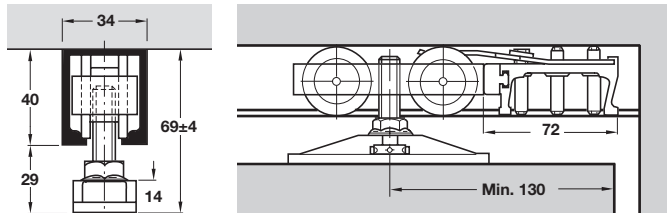
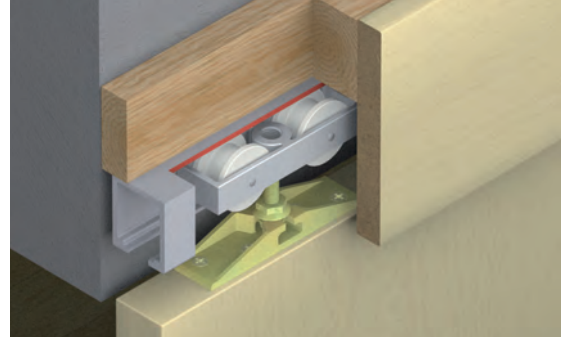

Easy to install

The two-way mounting plate allows the sliding door to be taken off or suspended in two different ways:

Fig. 1 - Side mounting

Fig. 2 - Front mounting

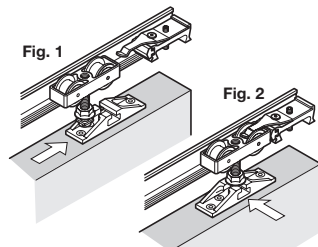

- > HAWA-Junior 80/B
- > For low and restricted headroom applications and when using side fixing profile
- > Range:
 - Max. door weight **80 kg**
 - Min. door thickness **35 mm**
 - Max. door height normally **2.3 m**
- > Height adjustment ± 4 mm
- > Installation drawing reference 17689

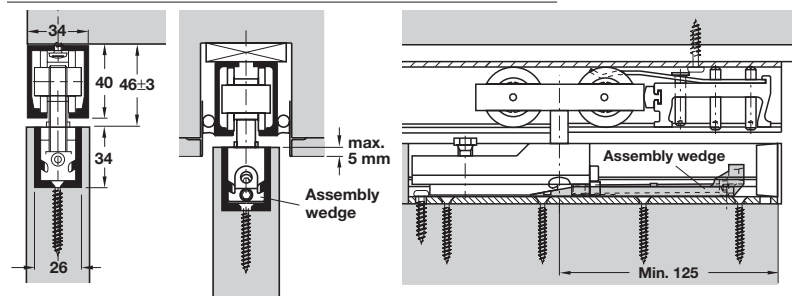
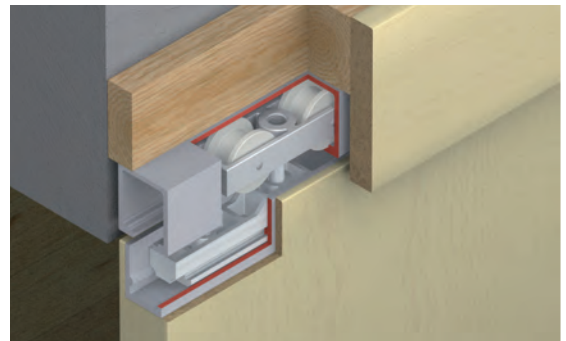

- > Complete sets for 1 door shown below or tracks and fitting sets available to order separately, shown on page 37

Hawa-Junior 80 and 80/B complete sets

- > Side fixing profiles are not included, can be ordered separately; refer to page 43 for details.

- > Hawa Junior 80 and 80/B sets include 1x 2.0 m length track and all fittings required for 1 door, including 1 additional track stopper
- > Order qty: 1 set

Set	Junior 80	Junior 80/B
Without SoftMove 80	940.80.113	940.80.115
With SoftMove 80*	940.80.114	940.80.116

TOH AH 2016, © Hafele U.K. Ltd 2016. Dimensional data not binding. We reserve the right to alter specifications without notice.

HAWA-Junior 80 tracks

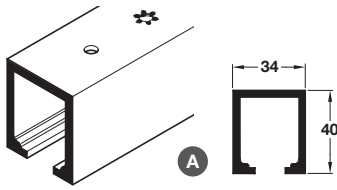

- > With screw holes for soffit fixing
- > Silver anodised aluminium
- > Order qty: 1 pc



> Top track side fixing profile is available, shown on page 43

Length	2.0 m	2.5 m	3.0 m
Cat. No.	940.80.200	940.80.250	940.80.300

HAWA-Junior 80 and 80/B fitting sets

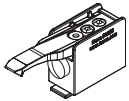

> If the sliding door is required to stop at both ends, we recommend installing an additional track stopper

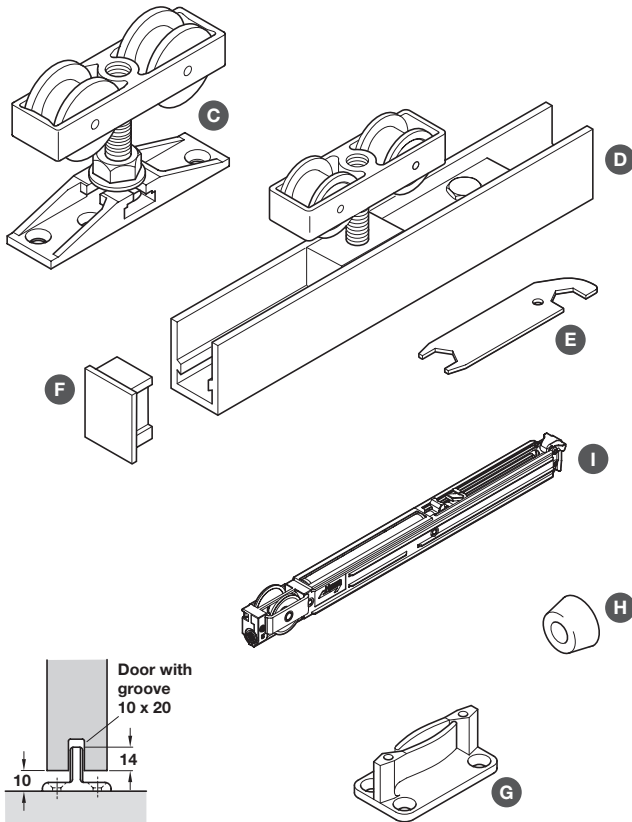

> Fitting sets, for one door

- B Track stopper, for adjustable mounting in top track, zinc alloy
 - C HAWA-Junior 80 trolley hanger, sleeve bearing mounted Ø 34 mm high-grade polyamide tandem rollers, aluminium carriage, fixings included
 - D HAWA-Junior 80B trolley hanger, sleeve bearing mounted Ø 34 mm high-grade polyamide tandem rollers, with 34 x 208 x 26 mm retainer profile and suspension plate, fixings included
 - E Locking wrench, for suspension profile
 - F Profile plugs, grey plastic
 - G Guide, rattle proof, for screw mounting to floor, black plastic, 24 x 60 x 34 mm
 - H Rubber buffer, Ø 19 x 10 mm, for screw fixing
 - I HAWA-SoftMove 80, 30 x 336 x 24 mm
- > Order qty: 1 set



Fitting set for 1 door	Junior 80	Junior 80/B
B Track stopper	1/2* pcs	1/2* pcs
C Junior 80 trolley hanger	2 pcs	-
D Junior 80/B trolley hanger	-	2 pcs
E Locking wrench	-	1 pc
F Profile plugs	-	2 pcs
G Guide, rattle proof	1 pc	1 pc
H Rubber buffer	1 pc	1 pc
I HAWA-SoftMove 80	1 pc*	1 pc*
Without SoftMove 80	940.80.001	940.80.002
With SoftMove 80*	940.80.111	940.80.112
Additional items		
Item B		940.80.040
Item G		940.40.031
Item I		940.80.046



> Alternative light duty guiding with continuous aluminium channel also available, shown on page 35

HAWA-Junior 80/B assembly wedge

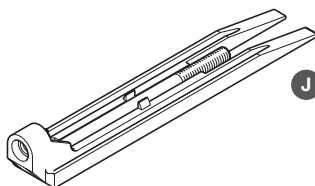

- > For insertion in trolley HAWA-Junior 80/B hanger retainer profile
- > Aluminium
- > Order qty: 1 set (1 set required per door)

Assembly wedge	
Item J	940.80.050



> Assembly wedge required if the door is to be installed above the ceiling after the ceiling is complete (max. 5 mm). Also makes installation/removal easier if the top of the door is tight to the ceiling

> Not required for side fixed applications