

HAWA-JUNIOR 80/B (MODIFIED) SLIDING DOOR SYSTEM

Junior 80/B modified is a vertically adjustable low headroom sliding door fitting, ideal for pocket door solutions. Easier installation due to a clever new suspension mechanism - click and clear.

- > HAWA-Junior 80/B (modified)
- > Range:
 - Max. door weight **80 kg**
 - Min. door thickness **24 mm**
 - Max. door height normally **2.3 m**
- > Height adjustment ± 7 mm (coarse adjustment ± 3 mm; fine adjustment ± 4 mm)
- > Installation drawing reference 24484

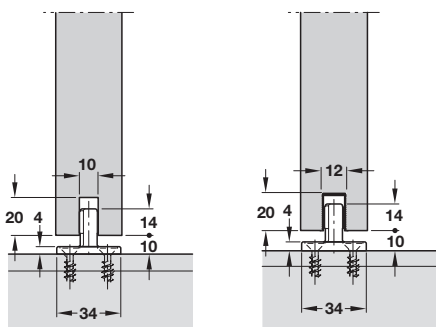
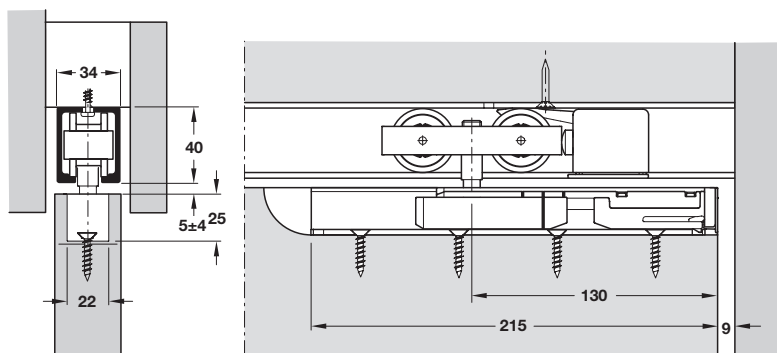
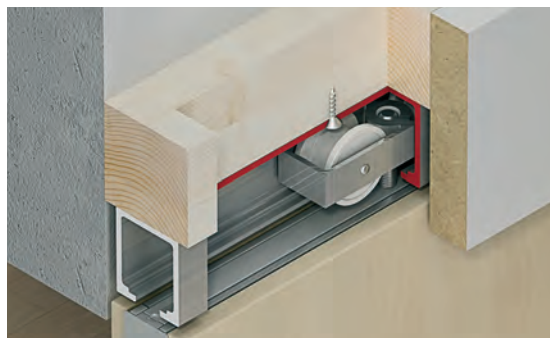

Without bottom channel

With bottom channel



This version of HAWA-Junior 80/B, compared to the standard HAWA-Junior 80/B has been modified with the following enhanced features:

- > Low headroom applications:
 - Around 1 mm gap between lower side of top track and top side of sliding door is now possible for a more pleasing appearance
- > Height can easily be adjusted from the leading edge without needing to remove the suspension unit
- > Very easy and efficient installation due to pre-fitted hanger bolt, integrated wedge mechanism and cover cap



- > Tracks and fitting sets must be ordered separately, shown on page 39

Hawa-Junior 40 to 250 sliding hardware systems

Measured tractive forces: Measurements shown are for maximum door weights

System	Required tractive force to set a door in motion, measure in Newton			Compared with Euronorm EN 1527 Class 3, 100,000 movements
	Test results 10,000 movements	50,000 movements	100,000 movements	
Hawa-Junior 40	4N	6N	6N	30N
Hawa-Junior 80	12N	14N	16N	40N
Hawa-Junior 120	18N	24N	29N	48N
Hawa-Junior 160	18N	23N	27N	64N
Hawa-Junior 250	43N	44N	50N	100N

HAWA-Junior 80 tracks

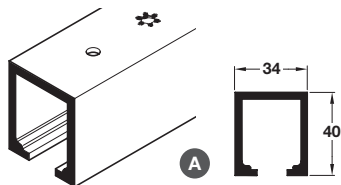

> Top track side fixing profile is available, shown on page 43

- > With screw holes for soffit fixing
- > Silver anodised aluminium
- > Order qty: 1 pc



Length	2.0 m	2.5 m	3.0 m
Cat. No.	940.80.200	940.80.250	940.80.300

HAWA-Junior 80/B (modified) fitting sets

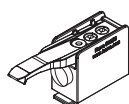

B

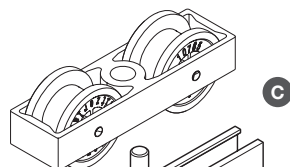

C

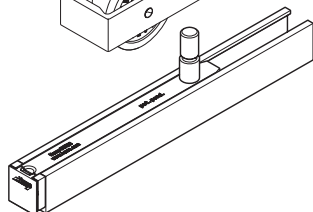

E

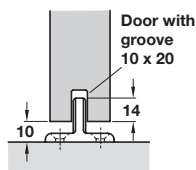

SoftMove for soft and self closing can be ordered separately, shown below and on page 42

- > Fitting sets, for one door

B Track stopper, for adjustable mounting in top track, zinc alloy

C HAWA-Junior 80/B modified trolley hanger, sleeve bearing mounted Ø 34 mm high-grade polyamide tandem rollers, with 25 x 215 x 22 mm retainer profile and suspension plate, fixings included

D Guide, rattle proof, for screw mounting to floor, black plastic, 24 x 60 x 34 mm

E Rubber buffer, Ø 19 x 10 mm, for screw fixing

- > Order qty: 1 set



Fitting set for 1 door	Junior 80/B
B Track stopper	2 pcs
C Junior 80/B mod. trolley hanger	2 pcs
D Guide, rattle proof	1 pc
E Rubber buffer	1 pc
Cat. No.	940.80.004
Additional items	
B Track stopper	940.80.040
D Guide	940.40.031
E Rubber buffer	940.40.051

HAWA-Junior 80/B bottom channel insert profile

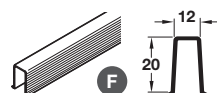
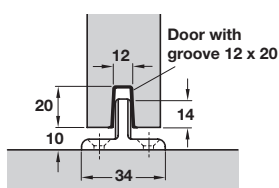

F

- > For press fitting and glue fixing into groove
- > 1.3 m length
- > Black plastic
- > Order qty: 1 pc

	Cat. No.
Bottom channel insert profile, 1.3 m	940.41.130

SoftMove 80 for HAWA-Junior 80



For further information please refer to page 42

- > SoftMove gently decelerates sliding doors and draws them into their final position, with no door spring-back
- > For installation in HAWA-Junior 80 top track, screw fixes to carriage of Junior 80 trolley hanger
- > Can be installed on both sides (min. door width for both sides: 1030 mm)
- > White plastic body with Ø 14 mm hydraulic metal damper
- > Order qty: 1 pc

	Cat. No.
SoftMove 80	940.80.046