

# HAWA/JUNIOR 250 AND 250/B SLIDING DOOR SYSTEM

Exceptionally light and silent action. All parts are corrosion resistant. Ideal for heavier duty cavity applications. Junior 250/B suitable for low headroom applications.

- > HAWA-Junior 250
- > Range:
  - Max. door weight **250 kg**
  - Min. door thickness **35 mm**
  - Max. door height normally **2.5 m**
- > Height adjustment  $\pm 5$  mm
- > Installation drawing reference 17689

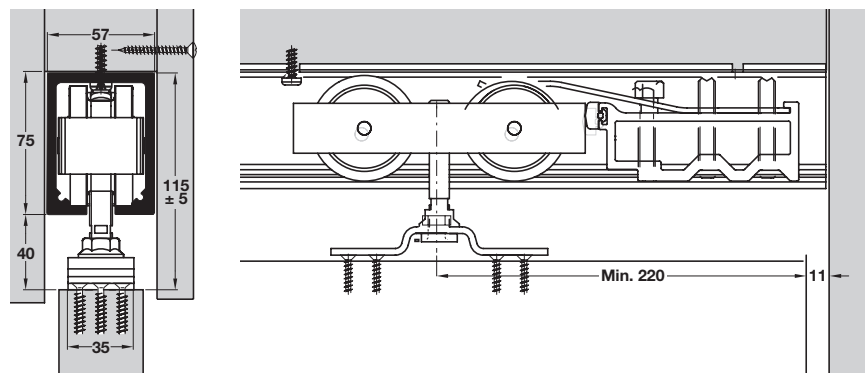
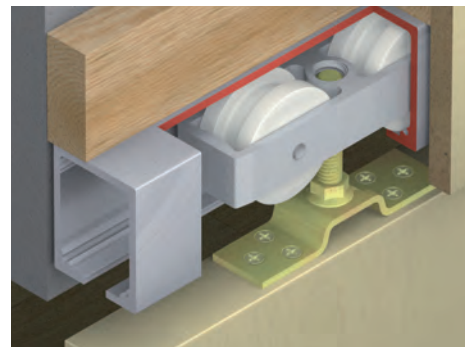

- > HAWA-Junior 250/B
- > For low and restricted headroom applications
- > Range:
  - Max. door weight **250 kg**
  - Min. door thickness **35 mm**
  - Max. door height normally **2.5 m**
- > Height adjustment  $\pm 5$  mm
- > Installation drawing reference 17689

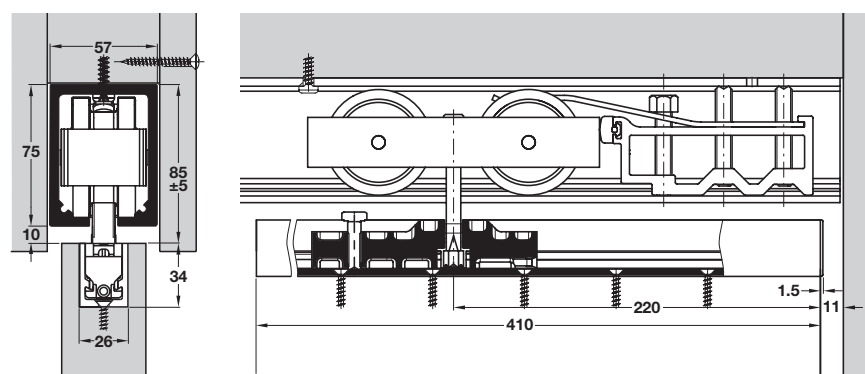
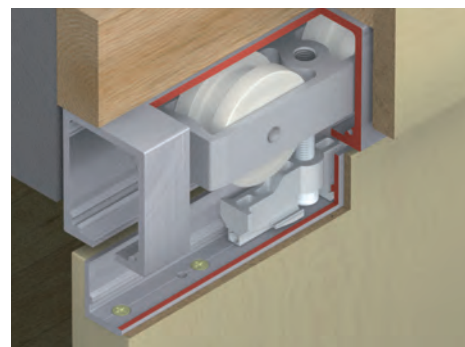

Track stopper positioned  
in top track

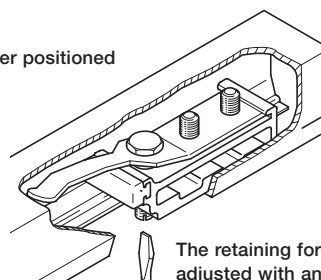

The retaining force can be  
adjusted with an allen key



> Tracks and fitting sets must be ordered  
separately, shown on page 49

## HAWA-Junior 250 top track

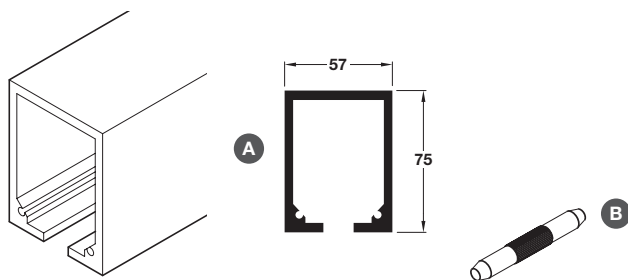

- > With screw holes for soffit fixing
- > Silver anodised aluminium
- > Order qty: 1 pc



Length	2.0 m	2.5 m	3.5 m
Cat. No.	942.56.920	942.56.925	942.56.935
Connecting bolt set for top track	1 set		
Item B	942.56.090		

## HAWA-Junior 250 fitting sets

- !** > If the sliding door is required to stop at both ends, we recommend installing an additional track stopper

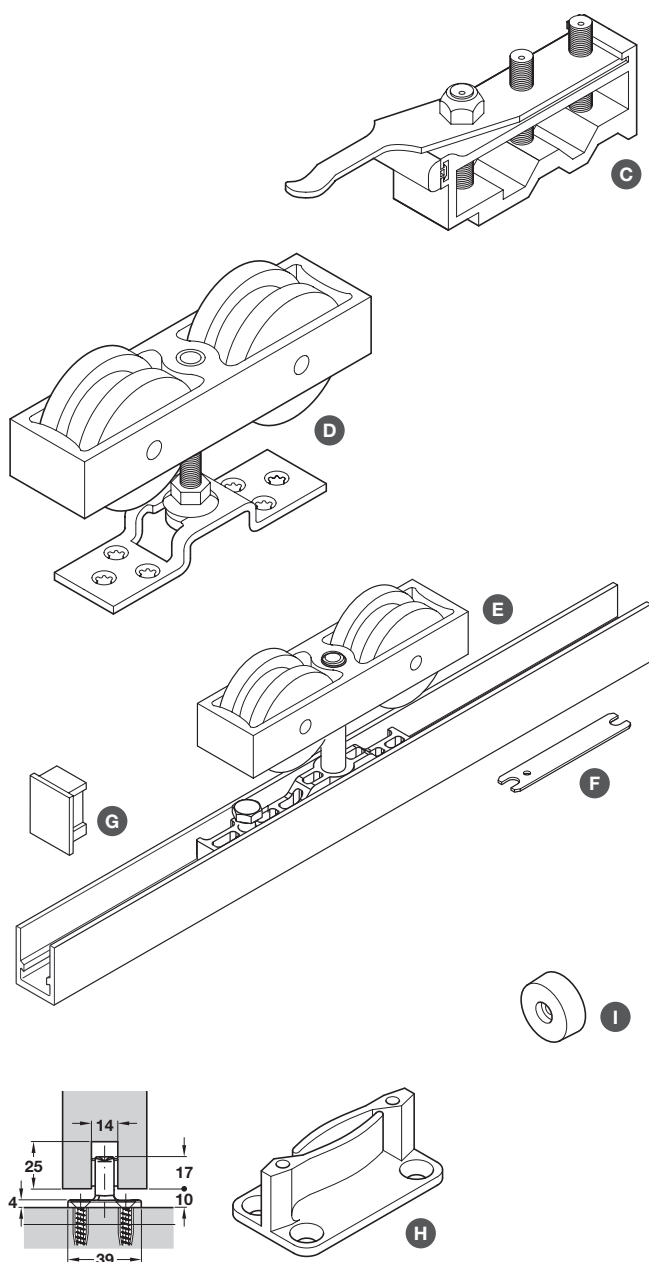

- > Fitting sets, for one door
- C Track stopper, 33.5 x 195 x 47.5 mm, for adjustable mounting in top track, zinc alloy housing, adjustable retaining force
- D HAWA-Junior 250 trolley hanger, sleeve bearing mounted Ø 63.5 mm high-grade polyamide tandem rollers, aluminium carriage with zinc-alloy mounting plate, fixings included
- E HAWA-Junior 250/B trolley hanger, sleeve bearing mounted Ø 63.5 mm high-grade polyamide tandem rollers, with 34 x 410 x 26 mm retainer profile and suspension plate, fixings included
- F Locking wrench
- G Profile plugs, grey plastic
- H Guide, for screw mounting to floor, black plastic, 27 x 80 x 39 mm
- I Rubber buffer, Ø 29 x 11 mm, for screw fixing
- > Order qty: 1 set



Fitting set for 1 door	Junior 250	Junior 250/B
C Track stopper	1 pc	1 pc
D Junior 120 trolley hanger	2 pcs	-
E Junior 120/B trolley hanger	-	2 pcs
F Locking wrench	-	1 pc
G Profile plugs	-	2 pcs
H Guide	1 pc	1 pc
I Rubber buffer	1 pc	1 pc
Cat. No.	942.56.001	942.56.002
<b>Additional items</b>		
Item C		942.56.041
Item H		941.60.031

- ➔** > Alternative light duty guiding with continuous aluminium channel also available, shown on page 47