

9

- > Slido Classic 80-S
- > Has an increased soundproofing level; the sound insulating value may be increased by using doors with solid chipboard core or soundproofing core
- > Noise reduction is approx. 28 to 32 dB but depends on the type of door used, the mounting situation as well as the wall construction - in tests a 38 dB rating was achieved
- > Range:
 - Max. door weight **80 kg** per door
 - Max. door width **825, 950, 1075 or 1200 mm**
 - Door thickness **39-43 mm**
- > For 1 leaf sliding doors
- > Door height adjustable ± 3 mm
- > For wall mounting, fitting width can be cut to size to max. 90 mm

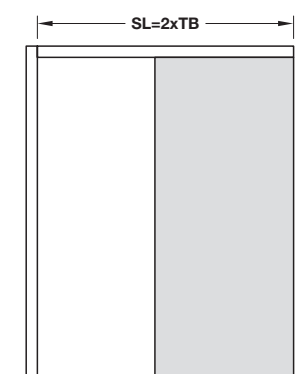

For wall mounting

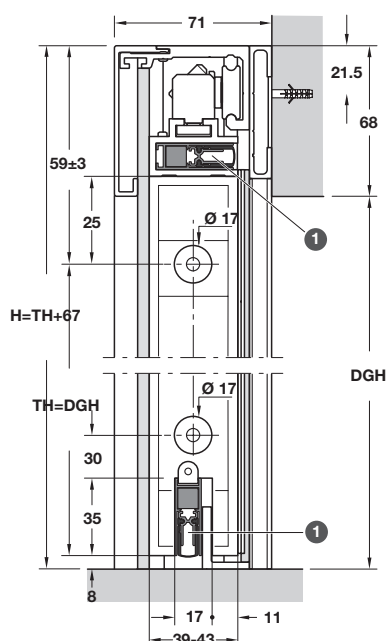

TH = Door height
TB = Door width
DGH = Opening height
DBG = Opening width
SL = Top track length

= Automatic door seal

= Vertical seal on hinge side and closing side

Final width (H x W)	Opening dim. (H x W)	Door dim. (H x W)
2130 x 750 mm	2130 x 760 mm	2125 x 825 mm
2130 x 875 mm	2130 x 885 mm	2125 x 950 mm
2130 x 1000 mm	2130 x 1010 mm	2125 x 1075 mm
2130 x 1125 mm	2130 x 1135 mm	2125 x 1200 mm

Door width = opening width +75 mm

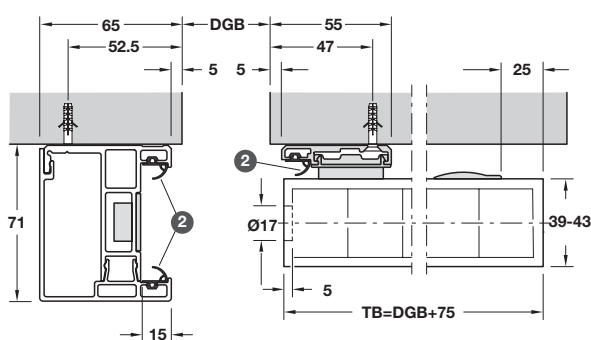

Slido Classic 80-S complete sets with tracks

Fitting set

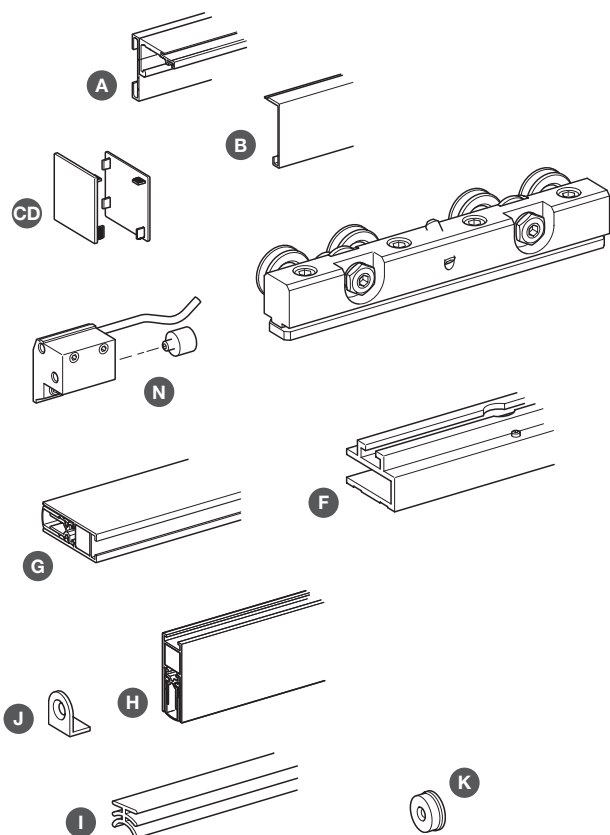

Door stop casing, vertical

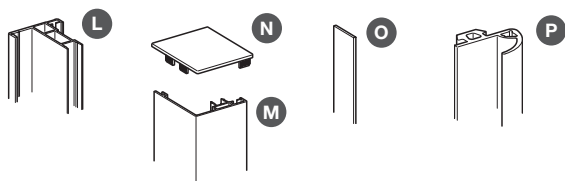

Verticle wall connection

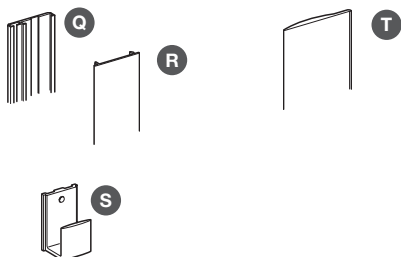

- > For wall mounting
- > Fitting width can be cut to size to max. 125 mm
- > Set includes:
 - A Top track
 - B Front panel for top track
 - C End caps for top track
 - D Track stopper
 - E Running gear
 - F Door support profile
 - G Automatic door seal, top, for inserting into door support profile
 - H Automatic door seal, bottom, for full mortice fitting in door leaf
 - I Horizontal seal, for automatic door seal at bottom
 - J Mounting bracket, for automatic door seal at bottom
 - K Drill in magnet, for holding door closed at top and bottom
 - L Stop profile, for door stop casing
 - M Panel, for door stop casing
 - N End cap, top, for door stop casing
 - O Counterplate, for drill in magnets, steel, self-adhesive
 - P Vertical rubber seal, for door stop casing and wall connection profile
 - Q Wall connection profile
 - R Panel, for wall connection profile
 - S Floor guide, for inserting into wall connection profile
 - T Contact threshold, self-adhesive, for glue fixing onto door leaf
- > Aluminium anodised, stainless steel coloured
- > Order qty: 1 set



Complete fitting set for 1 door	Classic 80-S
A Top track	2 pc
B Front panel	1 pc
C End caps	1 pair
D Track stopper	1 pair
E Running gear	2 pcs
F Door support profile	1 pc
G Automatic door seal, top	1 pc
H Automatic door seal, bottom	1 pc
I Horizontal seal	1 pc
J Mounting bracket	2 pcs
K Drill in magnet	2 pcs
L Stop profile	1 pc
M Panel	1 pc
N End cap	1 pc
O Counterplate	1 pc
P Vertical rubber seal	1 roll
Q Wall connection profile	1 pc
R Panel	1 pc
S Floor guide	1 pc
T Contact threshold	1 pc
Final width (height x width)	Cat. No.
2125 x 750 mm	941.31.000
2125 x 875 mm	941.31.001
2125 x 1000 mm	941.31.002
2125 x 1125 mm	941.31.003