

ELECTRIC FLAT SCREEN TV LIFT TS600B

Designed for installation in furniture, this TV lift is very slim and has no fixings or protruding parts at the back, making this TV lift ideal for TV beds and anywhere where it could be viewed from the rear. Includes an integrated auto-stop safety function for both directions.

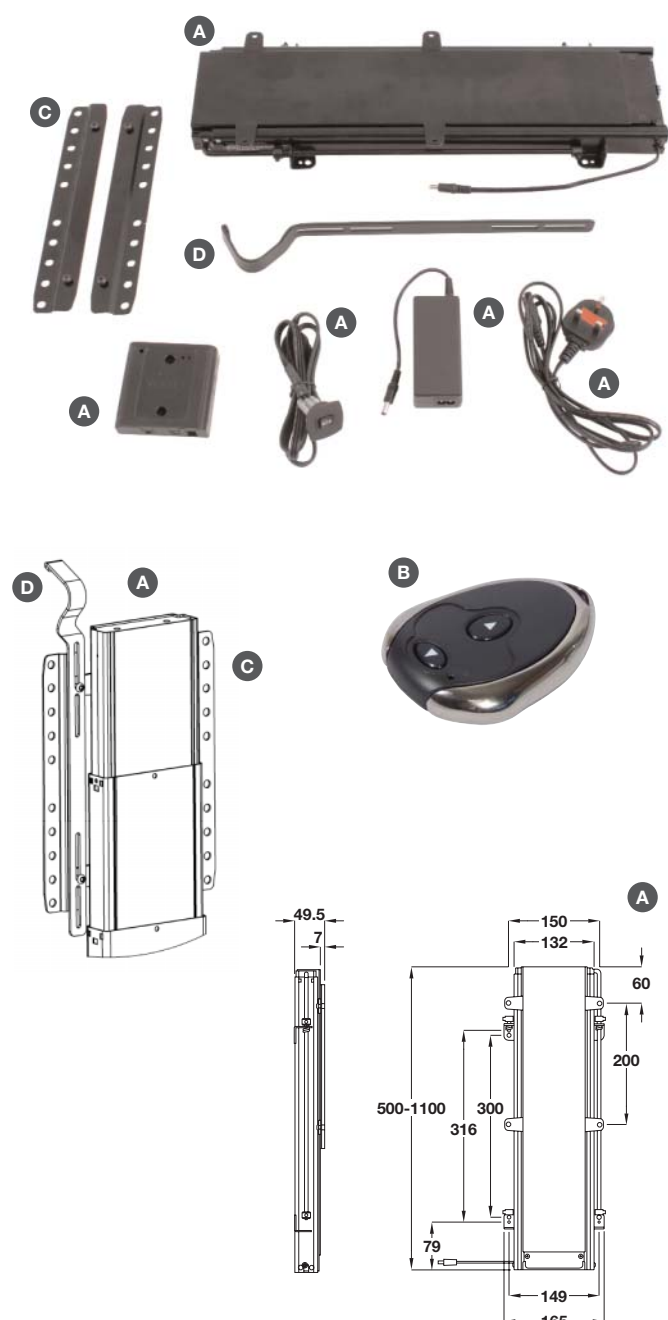

LED TV lift, with 600 mm travel



- > Can be used upside down, downside up and horizontally
- > Maximum thickness: 45 mm
- > Min. installation height: 500 mm (excludes adjustable lid lifter)
- > Travel: 500 - 1100 mm
- > Easy to adjust end stops to set the height range
- > Controlled with rocker switch, or by remote control
- > Automatic anti-squeeze auto-stop safety
- > Set includes

A TV lift TS600B:

Working load capacity: 0-12 kg maximum

Input power: 110-240 VAC/ 50-60 Hz

UK AC plug

B Remote control, 55 x 39 x 12.5 mm

Remote controlled with RF and manual switch

C TV monitor bracket MB600

VESA fixings: 200 x 200, 200 x 100, 100x 100

D Lid lifter

- > Black painted steel

- > Order qty: 1 set



Component parts	Cat. No.
TV lift TS600B	421.68.386
Remote control	421.68.389
TV monitor bracket MB600	421.68.387
Lid lifter	421.68.388
Set	Cat. No.
Includes 1 pc each of above	421.68.385