

Fleur de Lys lever handle on backplate for latch, malleable iron

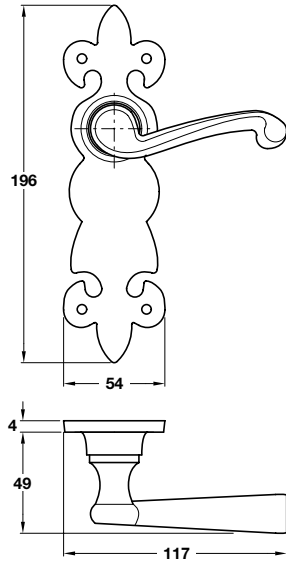

- > Pair of lever handles on backplates
- > Face fixing
- > Sprung, for use with standard duty followers
- > To suit doors 35-44 mm thick
- > 8 mm square spindle
- > Malleable iron
- > Order qty: 1 pc = 1 pair



Note: ±5 mm tolerance on dimensions



Finish	Cat. No.
Black antique	901.98.471

Fleur de Lys lever handle on backplate for lever lock, standard keyway, malleable iron



- > Pair of lever handles on backplates
- > Face fixing
- > Sprung, for use with standard duty followers
- > To suit doors 35-44 mm thick
- > 8 mm square spindle
- > Malleable iron
- > Order qty: 1 pc = 1 pair

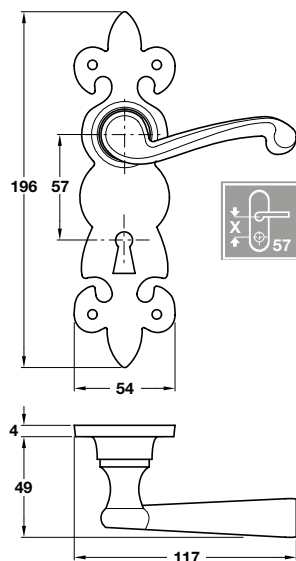

Note: ±5 mm tolerance on dimensions



Finish	Cat. No.
Black antique	901.98.472

Fleur de Lys lever handle on backplate for bathroom lock, malleable iron



- > Pair of lever handles on backplates
- > Face fixing
- > Sprung, for use with standard duty followers
- > To suit doors 35-44 mm thick
- > 8 mm square spindle included for lever operation
- > 5 mm spindle included for turn and release operation
- > Malleable iron
- > Order qty: 1 pc = 1 pair

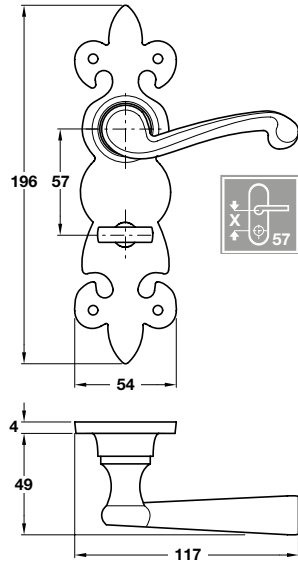

Note: ±5 mm tolerance on dimensions



Finish	Cat. No.
Black antique	901.98.473

6" Fleur de Lys pull handle, malleable iron



- > Single pull handles
- > Face fixing
- > Malleable iron
- > Order qty: 1 pc

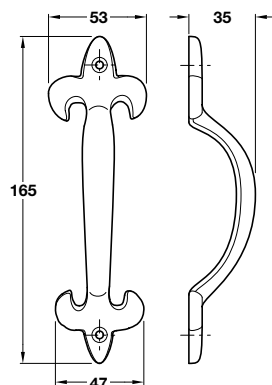

Note: ±5 mm tolerance on dimensions



Finish	Cat. No.
Black antique	901.00.713

Piano hinge, 600 x 25 x 0.5 mm

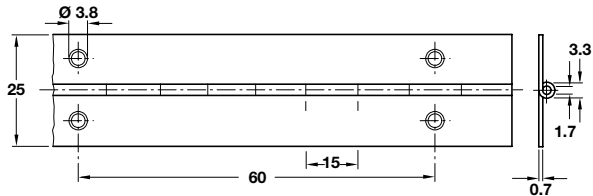

- > Fixings are included
- > Steel
- > Order qty: 1 pc

Finish	Cat. No.
Nickel-plated	351.22.602
Electro-brassed	351.22.802

Piano hinge, 900 x 25 x 0.5 mm

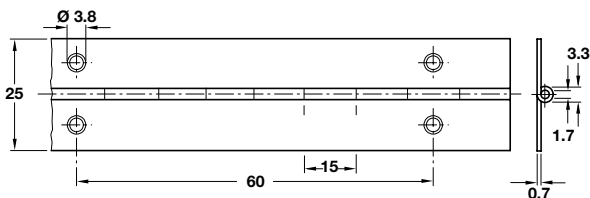

- > Fixings are included
- > Steel
- > Order qty: 1 pc

Finish	Cat. No.
Nickel-plated	351.22.603
Electro-brassed	351.22.803

Finial flush hinge, 50 x 36 x 1 mm

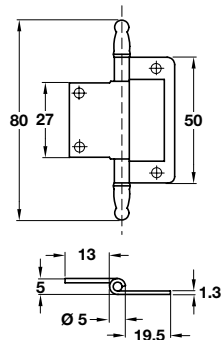

- > For medium duty applications
- > For inset doors
- > With fixed pin
- > Non mortice
- > Steel/zinc alloy
- > Order qty: 1 set (1 set = 2 pcs)

Finish	Cat. No.
Electro brassed	351.92.502
Florentine bronzed	351.92.102

Butterfly hinge

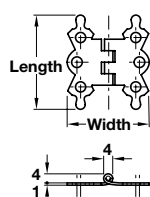

- > Brass-plated steel
- > Order qty: 1 set (1 set = 2 pcs)



Length x Width	42 x 35
Electro-brassed	354.06.530

Table hinge, 38 x 65 x 1 mm

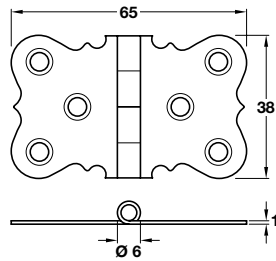

- > For table flaps or cabinet door front flaps
- > Steel
- > Order qty: 1 set (1 set = 2 pcs)



Finish	Cat. No.
Electro-brassed	341.34.510

Backflip hinge, 25 x 75 x 1.5 mm



- > In compliance with DIN 7954
- > Steel
- > Order qty: 1 set (1 set = 2 pcs)

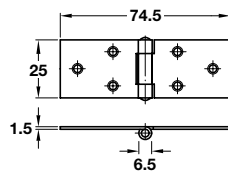

Finish	Cat. No.
Electro-brassed	354.31.574

Table hinge, 40 x 89 x 1.5 mm



- > For table flaps or cabinet door front flaps
- > Galvanized steel
- > Order qty: 1 set (1 set = 2 pcs)

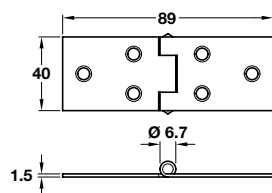

Finish	Cat. No.
Satin chrome	354.31.975

Table hinge, 32 x 77 mm



- > For table flaps or cabinet door front flaps
- > Self colour steel
- > Order qty: 1 set (1 set = 2 pcs)

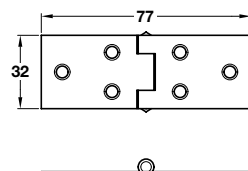

Finish	Cat. No.
Self colour	354.31.974

Butt hinge, 65 x 44 x 1.5 mm

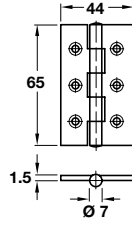

- > Unwashed, with stainless steel fixed spun pin
- > Grade 4 corrosion resistance
- > Stainless steel
- > Order qty: 1 set



Finish	Cat. No.	Pack qty
Polished chrome-plated	921.08.133	10

Butt hinges, 100 x 71 x 1.8 mm

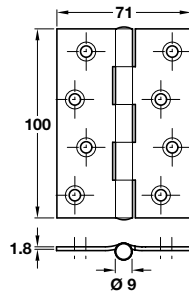

- > Fixed pin
- > For light/medium weight interior doors
- > For max. door weight 37 kg (when 3 hinges used)
- > Steel
- > Order qty: 1 set



Finish	Cat. No.	Pack qty
Bright zinc-plated	926.60.072	10

Parliament hinge 100x100 mm pack



- > Fixing screws not included
- > Brass
- > Order qty: 1 set (1 set = 2 pcs)

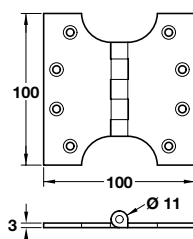

Finish	Cat. No.
Polished brass	921.08.188
Polished chrome	921.08.182
Satin chrome	921.08.184

CE7 mortice latch bolt with 3 hinge pack



- > Steel
- > Set includes:
 - 3x Hinges, 75 x 49 mm
 - 1x Tubular mortice latchbolt, 63 mm length
 - Strike plate and box
 - Packed in a clamshell
- > Order qty: 1 set

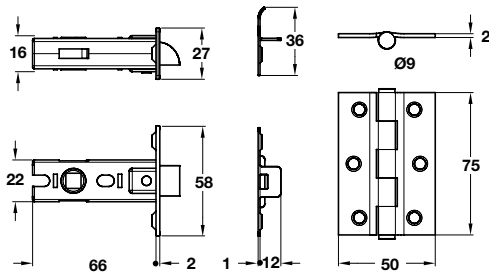

Finish	Cat. No.
Zinc plated	911.03.574
Brassed	911.03.571
Satin nickel	911.03.572
Black coated	911.03.573

Antique unequal hinge, 105 x 86 mm

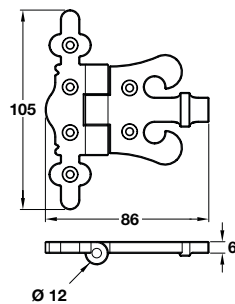

- > Epoxy coated zinc
- > Order qty: 1 set (1 set = 2 pcs)

Finish	Cat. No.
Black	926.60.094

Antique spear hinge, 158 mm

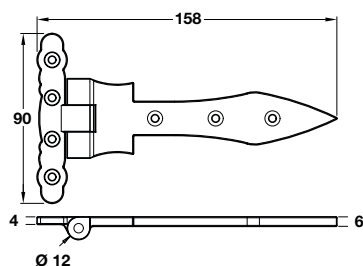

- > Epoxy coated zinc
- > Order qty: 1 set (1 set = 2 pcs)

Finish	Cat. No.
Black	926.60.095

Antique spear hinge, 237 mm



- > Epoxy coated zinc
- > Order qty: 1 set (1 set = 2 pcs)

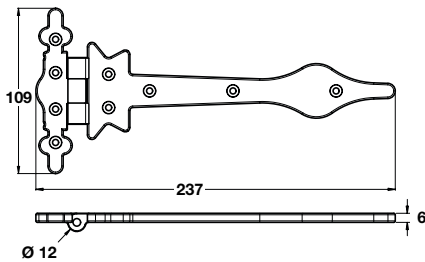

Finish	Cat. No.
Black	926.60.096

Antique butterfly hinge, 67 x 47 mm



- > Epoxy coated zinc
- > Order qty: 1 set (1 set = 2 pcs)

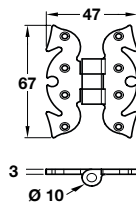

Finish	Cat. No.
Black	926.60.097

Snake hinge, 66 x 49 mm



- > Brass
- > Order qty: 1 set (1 set = 2 pcs)

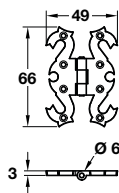

Finish	Cat. No.
Antique bronze	119.72.100
Polished lacquered	119.72.800

1951 Storm proof hinge 64 x 60 mm



- > Cranked hinge
- > Order qty: 1 set (1 set = 2 pcs)

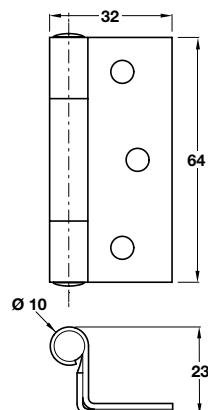

Finish	Cat. No.	Pack qty
Self brass	926.83.705	2
Bright zinc-plated	926.83.709	2



Barrel drill in hinge



- > Drill in hinge
- > Electro-brassed steel
- > Fixings are not included
- > Order qty: 1 set

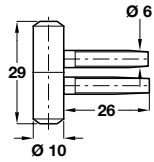

Finish	Cat. No.	Pack qty
Brassed steel	926.60.098	2